

PLANTING MATERIAL LEGEND

TREES	SIZE	NOTES	QTY
Existing Tree to Remain - Protect in Place			84
Existing Tree to be Removed			56
Chilopsis linearis Desert Willow 'Bubba' Caliper Size: 1.5"	24" Box H 5'-7" W 3'-4"	*ADWR	11
Acacia salicina Willow Leaf Acacia Caliper Size: 1.5"	24" Box H 7'-8" W 2.5'-3.5"	ADWR	4
Eucalyptus papuana Ghost Gum Eucalyptus Caliper Size: 1.5"	24" Box H 7'-9" W 3'-4"	*ADWR	116
Pistacia lentiscus Mastic Tree Caliper Size: 1.5"	24" Box H 7'-9" W 2.5'-3.5"	ADWR	22
Mariosousa willardiana Palo Blanco Caliper Size: 1.5"	24" Box H 5'-8" W 2.5'-3.5"	ADWR	54
Olea europaea 'Wilsonii' 'Wilsonii' Fruitless Olive Caliper Size: 1.5"	24" Box H 6'-8" W 3'-5"	*ADWR	28
GROUNDCOVERS			QTY
Portulacaria afra Elephant's Food	5 Gallon	*ADWR	728
Eremophila glabra 'Mingenev Gold' Outback Sunrise Emu	5 Gallon	*ADWR	56
SHRUBS / ACCENTS			QTY
Calliandra californica Red Fairy Duster	5 Gallon	*ADWR	59
Callistemon viminalis 'Little John' 'Little John' Bottlebrush Bush	5 Gallon	*ADWR	531
Bouteloua gracilis 'Blonde Ambition' Blue Grama	5 Gallon	*ADWR	129
Eremophila maculata 'Valentine' Valentine Bush	5 Gallon	*ADWR	386
Hesperaloe parviflora 'Perpa' Brakelights Red Yucca	5 Gallon	*ADWR	606
Tecoma stans 'Orange Jubilee' Orange Jubilee Bells	5 Gallon	*ADWR	6
LANDSCAPE MATERIALS			QTY
Decomposed Granite, 3/4" minus, Dutchman Gold 2" deep in planting areas per plan.			100,631 sq. ft.
Decomposed Granite, 1/4" minus, Dutchman Red 8" deep in planting areas per plan.			39,403 sq. ft.
Decomposed Granite, 1/2" screened, Table mesa brown 2" deep in planting areas within R.O.W.			2,800 sq. ft.
Root Barrier Adjacent to Utility Lines COT STD DTL T-460-1			2,076 lf

IRRIGATION GENERAL NOTES

- IRRIGATION PLAN IS DIAGRAMMATIC. ADJUST LOCATION OF VALVES TO PROVIDE FULL AND ADEQUATE COVERAGE OR ADD EMITTERS AS NECESSARY TO ENSURE 100% COVERAGE OF PLANT MATERIALS. PREVENT OVERSPRAY ON ADJACENT IMPROVEMENTS.
- VERIFY WATER PRESSURE IN FIELD AND NOTIFY OWNER IMMEDIATELY SHOULD A DISCREPANCY EXIST.
- SYSTEM DESIGN REQUIRES A STATIC PRESSURE OF 70 PSI. CONTRACTOR SHALL PERFORM A FIELD VERIFICATION OF THE PRESSURE READING PRIOR TO ORDERING MATERIALS OR STARTING IRRIGATION.
- COORDINATE IRRIGATION SLEEVES LOCATION AND SIZE WITH A MINIMUM DIAMETER TWICE THE SIZE OF THE IRRIGATION LINE. EXTEND SLEEVES 12" BEYOND EDGE OF PAVEMENT, WALL, WALKS OR CURB.
- PROGRAM CONTROLLERS TO MAINTAIN SUFFICIENT FLOW RATES THROUGHOUT THE SYSTEM. ADJUST AS REQUIRED FOR SEASON AND PLANT MATERIAL UNTIL FINAL ACCEPTANCE.
- LOCATE TAN COLOR (CARSON OR EQUAL) VALVE BOXES (IRRIGATION, GATE VALVE, FLUSH CAP, CONTROL WIRE AND OTHERS) IN PLANTER AREAS. DO NOT LOCATE VALVE BOXES IN A LAWN OR HARDSCAPE UNLESS APPROVED BY THE ENGINEER.
- MAINTAIN OR RESTORE ALL EXISTING LANDSCAPE IRRIGATION SYSTEMS IMPACTED BY ANY WORK PERFORMED UNDER THIS CONTRACT. RESTORE IRRIGATION TO PROVIDE 100% SERVICE AND COVERAGE.
- CONTRACTOR SHALL REVIEW AND FIELD VERIFY LAYOUT OF ALL IRRIGATION SYSTEM COMPONENTS AND HAVE THE LAYOUT APPROVED BY THE ENGINEER PRIOR TO STARTING INSTALLATION.
- ALL SLEEVES ARE TO BE BORED UNDER DRIVEWAYS AND SIDEWALKS. CONTRACTOR SHOULD INSTALL USING ACCEPTABLE TRENCHLESS METHODS. NO MEASUREMENT AND PAYMENT WILL BE MADE FOR REMOVAL AND REPLACEMENT OF CURB, GUTTER, SIDEWALK OR PAVEMENT TO INSTALL SLEEVES.

CITY OF TEMPE GENERAL NOTES

- ALL CONSTRUCTION UNDER THE PUBLIC WORKS PERMIT SHALL CONFORM TO THE MARICOPA ASSOCIATION OF GOVERNMENTS UNIFORM STANDARD SPECIFICATIONS AND DETAILS, CITY OF TEMPE SUPPLEMENT TO THE MAG SPECIFICATIONS AND DETAILS, AND TEMPE TRAFFIC BARRICADE MANUAL.
- A PERMIT ISSUED BY THE ENGINEERING DIVISION SHALL BE REQUIRED FOR ALL WORK IN THE CITY OF TEMPE RIGHT-OF-WAY. AN INVESTIGATION FEE, IN THE AMOUNT GREATER OF \$250.00 OR DOUBLE THE PERMIT FEE, NOT TO EXCEED \$2,500.00, WILL BE CHARGED FOR ANY WORK WITH THE CITY OF TEMPE RIGHT-OF-WAY IN WHICH A PERMIT HAS NOT BEEN ISSUED PRIOR TO COMMENCEMENT OF WORK.
- THE ENGINEERING DIVISION SHALL BE NOTIFIED 24 HRS PRIOR TO STARTING THE DIFFERENT PHASES OF CONSTRUCTION FOR SCHEDULING INSPECTIONS.
- LOCATION OF ALL WATER VALVES, MANHOLES, AND CLEANOUTS MUST BE REFERENCED AT ALL TIMES DURING CONSTRUCTION AND MADE AVAILABLE TO THE WATER AND WASTEWATER DIVISION.
- NO JOB WILL BE CONSIDERED COMPLETE UNTIL ALL CURBS, PAVEMENT, AND SIDEWALKS HAVE BEEN SWEEP CLEAN OF ALL DIRT AND DEBRIS AND ALL SURVEY MONUMENTS ARE INSTALLED ACCORDING TO THE PLANS.
- THE CONTRACTOR SHALL CONTACT BLUE STAKE (602-263-1100) 48 HRS PRIOR TO CONSTRUCTION.
- ALL EXISTING STREET MONUMENTS MUST BE PRESERVED. PRIOR TO CONSTRUCTION, MONUMENTS WILL BE REFERENCED HORIZONTALLY AND VERTICALLY. AFTER CONSTRUCTION, MONUMENTS SHALL BE RESET AND FIELD NOTED, INCLUDING NEW ELEVATION. SHALL BE FILED WITH THE CITY.
- THIS SET OF PLANS HAS BEEN REVIEWED FOR COMPLIANCE WITH CITY REQUIREMENTS PRIOR TO ISSUANCE OF CONSTRUCTION PERMITS. HOWEVER, SUCH REVIEW SHALL NOT PREVENT THE CITY FROM REQUIRING CORRECTION OF ERRORS IN PLANS FOUND TO BE IN VIOLATION OF ANY LAW OR ORDINANCE.
- THE CITY DOES NOT WARRANT ANY QUANTITIES SHOWN ON THESE PLANS.
- AN APPROVED SET OF PLANS SHALL BE AVAILABLE ON THE JOB SITE AT ALL TIMES.
- THE CITY SHALL BE NOTIFIED 24 HRS PRIOR TO ANY CONSTRUCTION WORK. CONSTRUCTION WORK CONCEALED WITHOUT INSPECTION BY THE CITY SHALL BE SUBJECT TO EXPOSURE AT THE CONTRACTORS EXPENSE.
- CONSTRUCTION ITEMS SHALL NOT BE ACCEPTED UNTIL 3 MIL MYLAR REPRODUCIBLE 'AS-BUILD' PLANS HAVE BEEN SUBMITTED TO AND APPROVED BY THE ENGINEERING DIVISION.
- THE CONTRACTOR SHALL BARRICADE CONSTRUCTION SITES AT ALL TIMES PER THE CITY OF TEMPE TRAFFIC BARRICADE MANUAL. WHEN REQUIRED BY THE CITY, A TRAFFIC CONTROL PLAN SHALL BE SUBMITTED FOR APPROVAL IN ADVANCE OF CONSTRUCTION.
- NO PAVING CONSTRUCTION SHALL BE STARTED UNTIL ALL UNDERGROUND UTILITIES WITHIN THE PATH PRISM ARE COMPLETED.
- THE MAXIMUM STAKE INTERVAL FOR GRADES OF 0.2% OR LESS SHALL BE 25' FOR CONCRETE WORK AND 50' FOR ASPHALT ROADWAY SECTION, EXCEPT ON HORIZONTAL OR VERTICAL CURVES WHERE A MAXIMUM STAKE INTERVAL OF 20' FOR CONCRETE WORK SHALL BE REQUIRED. ALL CONCRETE SHALL BE STAKED AT THE PC, PT, AND MIDPOINT. NO GRADE STAKE INTERVAL SHALL EXCEED 50'.
- DRAINAGE SWALES AND DRAINAGE CHANNELS WILL BE WATER TESTED IN THE PRESENCE OF THE CITY ENGINEER OR HIS AUTHORIZED REPRESENTATIVE TO INSURE PROPER DRAINAGE, PRIOR TO FINAL APPROVAL BY THE ENGINEERING DIVISION.
- EXACT POINT OF MATCHING, TERMINATION, AND OVERLAY, IF NECESSARY, MAY BE DETERMINED IN THE FIELD BY THE ENGINEERING DIVISION.

KEYNOTE LEGEND

KEY	DESCRIPTION
1	CONCRETE HEADER, 6" X 12", SEE CIVIL PLANS
2	NODE AREA WITH BIKE RACK, TRASH RECEPTACLE AND SEATING, DRINKING FOUNTAIN, SEE DETAIL 5/L3.1, 6/L3.1
3	10' WIDE MULTI-USE PATHWAY, COLOR: DAVIS SANDSTONE 5237 SEE CIVIL PLANS FOR DETAIL, LAYOUT AND CONTROL
4	10' WIDE EQUESTRIAN PATHWAY, 1/4" MINUS DG, DUTCHMAN RED 8 INCH DEEP IN, SEE CIVIL PLANS FOR LAYOUT AND CONTROL. SEE 8/L3.0 FOR DETAIL
5	2' WIDE FALL ZONE - PROTECT CLEARANCE
6	EXISTING UTILITIES, SEE CIVIL PLANS
7	EXISTING LIGHT POLE - PROTECT IN PLACE
8	NEW LIGHT POLE, SEE ELECTRICAL PLANS
9	EXISTING WALL - PROTECT IN PLACE
10	ROOT BARRIER PER TEMPE, SEE DETAIL T-460-1
11	BIKE REPAIR STATION. SEE 8/L3.1 FOR DETAIL

GENERAL CONSTRUCTION NOTES

- ALL EXISTING UTILITIES SHALL BE PROTECTED IN PLACE UNLESS OTHERWISE INDICATED.
- CONTRACTOR SHALL PROVIDE ALL MATERIALS, EQUIPMENT, AND LABOR TO CLEAR AND GRUB THE SITE, PER MAG SECTION 201 AND REMOVE ALL OBSTRUCTIONS ON THE SITE INCLUDING, BUT LIMITED TO: CONCRETE DEBRIS, TREE STUMPS, AND MISC. STRUCTURES. NO SEPARATE PAYMENT SHALL BE MADE.
- CONTRACTOR SHALL PROVIDE A PRIVATE LOCATOR FOR ELECTRICAL AND IRRIGATION EQUIPMENT AND SHALL LOCATE ALL CITY OF TEMPE ELECTRICAL, IRRIGATION AND UTILITIES PRIOR TO CONSTRUCTION ACTIVITIES. UTILITY LOCATION WITHIN CONSTRUCTION LIMITS.
- CONTRACTOR IS RESPONSIBLE FOR MAINTAINING THE HEALTH OF ALL TREES THAT ARE TO REMAIN DURING CONSTRUCTION. CONTRACTOR SHALL PHOTO INVENTORY ALL TREES TO REMAIN ON SITE AND PROVIDE DIGITAL PHOTOS TO THE CITY OF TEMPE FOR REFERENCE AT THE BEGINNING OF THE CONTRACT.

PHOTOS SHALL BE NUMBERED AND KEYED TO AN AERIAL PHOTO FOR REFERENCE TO THE LOCATION OF THE TREE(S). PHOTOS SHALL INCLUDE A LABEL OF SPECIES, DIAMETER, HEIGHT, AND OVERALL CONDITION. PHOTOS SHALL BE KEPT IN A BINDER IN THE ON-SITE CONSTRUCTION TRAILER. THESE PHOTOS WILL ACT AS A BENCHMARK FOR THE TREE HEALTH AT THE END OF THE CONSTRUCTION PROJECT.

ADDITIONALLY CONTRACTOR SHALL ESTABLISH A TREE PROTECTION ZONE (TPZ) AROUND THE ENTIRE PERIMETER OF THE DRIP-LINE (CANOPY PERIMETER) OR AT LEAST A MINIMUM OF 1' RADIUS FOR EACH 1" TRUNK DIAMETER MEASURE AT 4.5' ABOVE GRADE TO HELP PROTECT THE CRITICAL ROOT ZONE (CRZ) OF ALL TREES DESIGNATED TO REMAIN ON-SITE DURING CONSTRUCTION ACTIVITIES.

SOMETIMES SITE BOUNDARIES, EXISTING SITE CONDITIONS, HARDSCAPE CAN PREVENT COMPLETE PROTECTION FOR THE CRZ. THESE SITUATIONS WILL BE DISCUSSED BY CONTRACTOR AND CITY REPRESENTATIVE AND HANDLED ON A CASE BY CASE BASIS.

THE TPZ NEEDS TO BE DESIGNATED ON THE PLANS TO HELP AVOID CONFLICT WITH STRUCTURES, UTILITIES, ACCESS ROADS, AND MATERIAL STAGING. THE TPZ SHALL CONSIST OF A BARRIER CONSTRUCTED OF EITHER 6' CHAIN LINK FENCE OR 4' LAMINATED ORANGE CONSTRUCTION FENCING MATERIAL.

SUPPORT STAKES (METAL OR WOOD) FOR THE FENCE TO BE 6' O.C. SPACING AND SECURELY PLACED IN THE GROUND. THE AREA SHALL BE POSTED WITH SIGNAGE DESIGNATING THE TPZ ATTACHED TO THE FENCING MATERIAL FOR THE DURATION OF THE PROJECT.

IT IS RECOMMENDED THAT A 4"-6" LAYER OF MULCH SHALL BE PLACED AROUND THE TREE (6" FROM THE VASE OF THE TREE) AND THROUGHOUT THE CONSTRUCTION AREA WHERE VEHICLE AND EQUIPMENT TRAVEL AND OR/MATERIAL STORAGE IS ANTICIPATED.

THE TPZ AND FENCING SHALL BE ESTABLISHED PRIOR TO ANY CONSTRUCTION ACTIVITIES. FENCING IS TO REMAIN DURING DURATION OF THE CONSTRUCTION ACTIVITIES. ACTIVITY WITHIN THE TPZ IS NOT PERMITTED, INCLUDING BUT NOT LIMITED TO: EXCAVATION; GRADING; DRAINAGE; PARKING AND/OR EQUIPMENT STORAGE; MATERIAL STORAGE; DISPOSAL OF OIL, GASOLINE, CONCRETE WASHOUT, OR CHEMICALS; AND DEBRIS STORAGE.

REMOVAL OR RELOCATION FOR TEMPORARY ACCESS INSIDE THE TPZ MUST BE REPLACED IMMEDIATELY UPON COMPLETION OF THE ACTIVITIES BY THE END OF THE DAY.

ANY TEMPORARY ACCESS INTO THE TPZ MUST BE APPROVED IN ADVANCE BY THE PROJECT ARBORIST, CITY REPRESENTATIVE, AND/OR PROJECT MANAGER.

PRIOR TO FINAL PROJECT ACCEPTANCE, THE CONTRACTOR AND CITY SHALL REEVALUATE ALL TREES AND DETERMINE ANY MAINTENANCE NEEDS, DAMAGE, OR REPLACEMENT. TREES THAT REQUIRE REPLACEMENT SHALL BE WITH THE SAME LIKE AND KIND OR AS DETERMINED BY CONTRACTOR AND CITY REPRESENTATIVE.

- TREE ROOTS OF ALL PROTECTED TREES AND ANY TREE TO REMAIN ON-SITE DURING THE CONSTRUCTION PROJECT SHOULD NOT BE DAMAGED OR CUT. WHEN ROOT CUTTING IS UNAVOIDABLE, CONTRACTOR AND CITY REPRESENTATIVE SHALL REVIEW THE EXTENT NEEDED AND DETERMINE A COURSE OF ACTION.

A CLEAN SHARP CUT SHALL BE MADE TO AVOID SHREDDING OR SMASHING OF ROOTS. ANY EXPOSED ROOTS SHALL BE COVERED IMMEDIATELY WITH SOIL OR BURLAP AND KEPT MOIST TO HELP PREVENT DEHYDRATION.

ADDITIONALLY, ANY PRUNING OF TREES AS NEEDED FOR CONSTRUCTION ACCESS OR DUE TO DAMAGE FROM CONSTRUCTION ACTIVITIES SHALL BE REVIEWED AND DISCUSSED BY CONTRACTOR AND CITY REPRESENTATIVE.

IRRIGATION LEGEND

SYSTEM DESIGNED USING A RESIDUAL PRESSURE OF 70 PSI

SYMBOL	DESCRIPTION	NOTES
	WATER METER	PER TEMPE STANDARDS, NEW IRRIGATION METER - 1.0" SIZE, REF. TEMPE DETAIL
	RPBFA	BACKFLOW PREVENTER ASSEMBLY, FEBCO 825-Y, SIZE PER PLAN, PROVIDE METAL ENCLOSURE.
	CONTROLLER	CONTROLLER A & B = CONTROLLER PER CITY OF TEMPE STANDARDS
	CONTROLLER	CONTROLLER C & D & E = SOLAR CONTROLLER
	CONTROLLER	6-STATION, POST MOUNT
	MASTER (CONTROL) VALVE	1" SIZE MASTER VALVE PER DETAIL
	FLOW SENSOR	BRASS, NTP THREADED CONNECTION, 1" SIZE.
	GATE VALVE	NIBCO MODEL# T-113, SIZE PER LINE
	BALL VALVE	BRONZE MATERIAL SPEARS MODEL# TRUE UNION 2000, SIZE PER LINE SCH. 80 PVC MATERIAL
	DRIP VALVE	HUNTER ICV SERIES WITH 150 MESH WYE-STRAINER SIZE PER PLAN
	FLUSH CAP	SPEARS FLUSH CAP 1/2" FLUSH VALVE
	PRESSURE REG.	SENNIGER 30 PSI - LOCATE IN SEPARATE BOXES MEDIUM FLOW 2-20GPM - 30 PSI (100 MESH)
	EMITTER - SP	BOWSMITH 1.0 GPH (1 PER PLANT)
	EMITTER - MP	BOWSMITH 1.0 GPH 6 PORT (2 PER TREE) GROUPS OF SHRUBS WITHIN 6'.
	SERVICE POINT	CONNECT TO EXISTING POTABLE WATER SERVICE

PIPE LEGEND

	MAINLINE - SIZE PER PLAN PVC SCH. 40
	TREE LATERAL PVC SCH. 40 - SOLVENT WELD
	SHRUB LATERAL PVC SCH. 40 - SOLVENT WELD
	PIPE SLEEVE PVC SCH. 40 - 2 X PIPE SIZE MINIMUM WIRE SLEEVE PVC SCH. 40 - MINIMUM 1 1/2" SIZE

VICINITY MAP

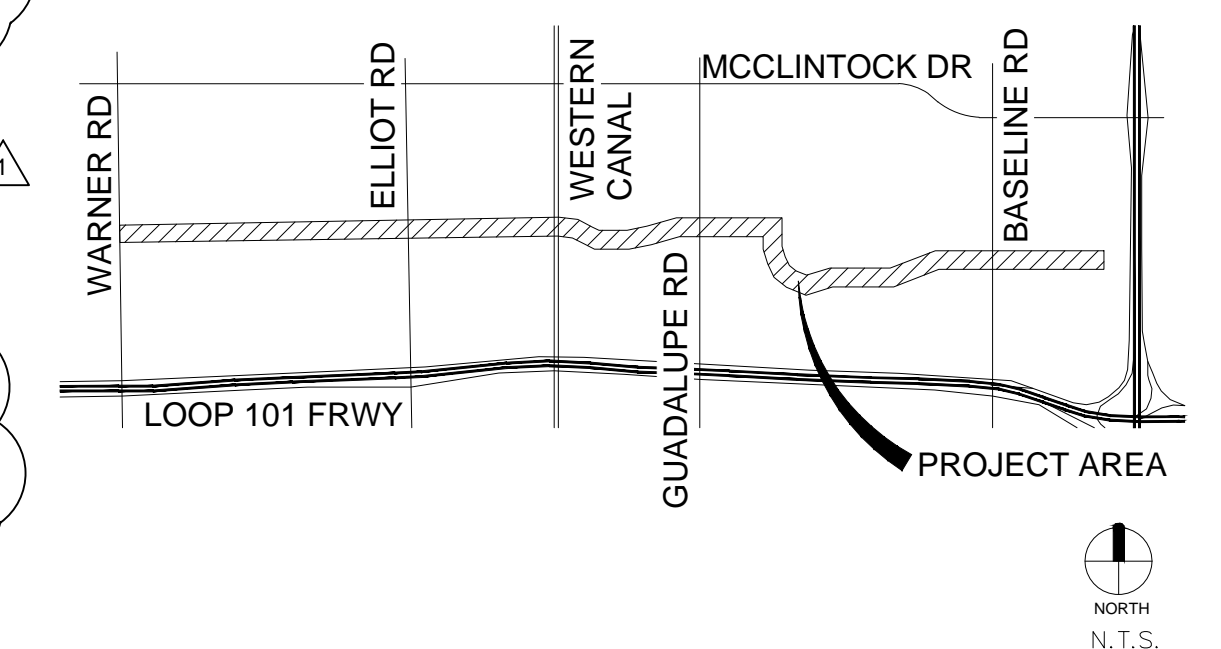

				HARRINGTON PLANNING + DESIGN 3116 S. MILL AVENUE, SUITE 305 TEMPE, ARIZONA 85282 TEL: 480-250-0116	
MARK	DATE	DESCRIPTION	BY		
DEPARTMENT OF ENGINEERING & TRANSPORTATION					
CITY OF TEMPE ENGINEERING DIVISION					
P.O. BOX 5002, TEMPE, AZ 85280					
SURVEYED:	NAME	DESCRIPTION	DATE: 06/20/22		PROJECT NO. 6008961
DESIGNED:	JH	COUNTRY CLUB WAY MULTI-USE PATH WARNER RD TO US 60 Tempe, Arizona	PROJECT NO.		
DRAWN:	SL				
CHECKED:	SJ				
SCALE:	PER PLAN	LANDSCAPE & IRRIGATION NOTES L0.1	SHT	52	OF 156

BEGINNING OF PROJECT

MATCH LINE STA 4+20 SEE TOP RIGHT

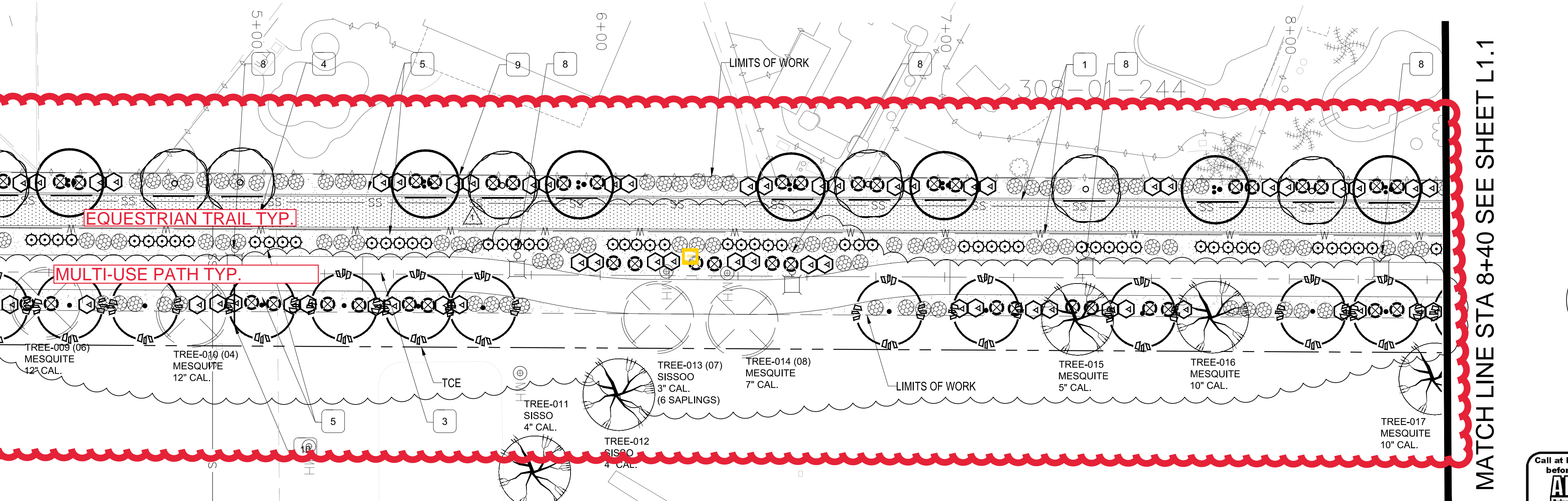
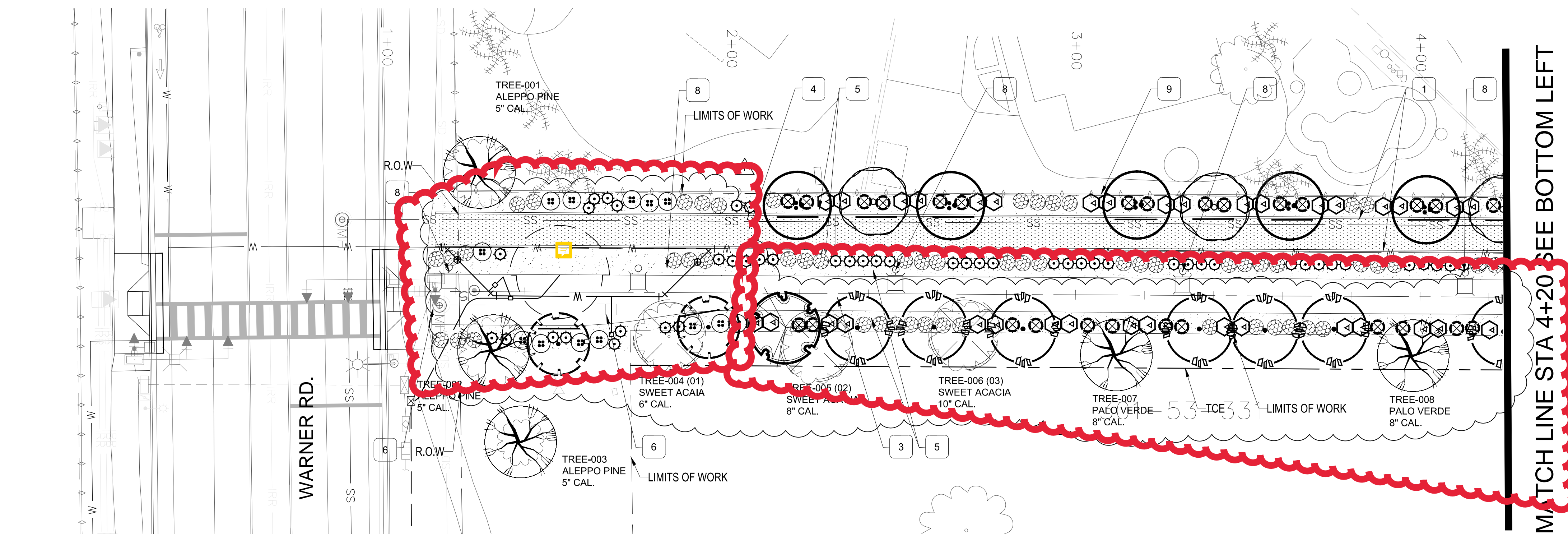

KEY MAP

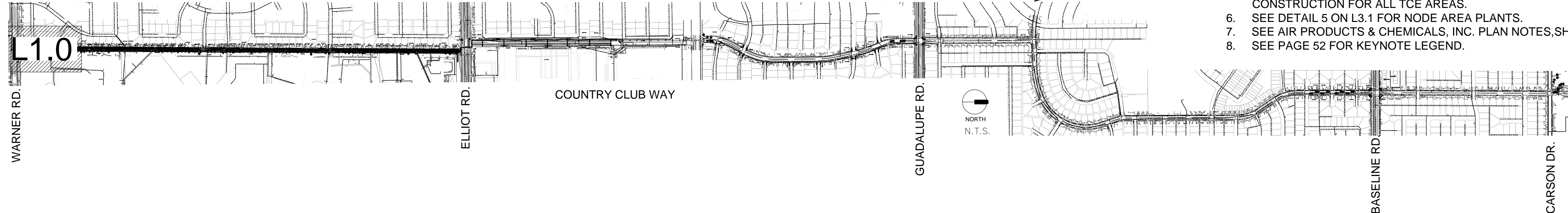

PLANTING MATERIAL LEGEND

TREES	SIZE	NOTES	QTY
Existing Tree to Remain - Protect in Place			84
Existing Tree to be Removed			56
Chilopsis linearis Desert Willow 'Bubba' Caliper Size: 1.5"	24" Box H 5'-7" W 3'-4"	*ADWR	11
Acacia salicina Willow Leaf Acacia Caliper Size: 1.5"	24" Box H 7'-8" W 2.5'-3.5"	ADWR	4
Eucalyptus papuana Ghost Gum Eucalyptus Caliper Size: 1.5"	24" Box H 7'-9" W 3'-4"	*ADWR	150
Pistacia lentiscus Mastic Tree Caliper Size: 1.5"	24" Box H 7'-9" W 2.5'-3.5"	ADWR	22
Mariosousa willardiana Palo Blanco Caliper Size: 1.5"	24" Box H 5'-8" W 2.5'-3.5"	ADWR	20
Olea europaea 'Wilsonii' 'Wilsonii' Fruitless Olive Caliper Size: 1.5"	24" Box H 6'-8" W 3'-5"	*ADWR	28
GROUNDCOVERS			QTY
Portulacaria afra Elephant's Food	5 Gallon	*ADWR	728
Eremophila glabra 'Mingenew Gold' Outback Sunrise Emu	5 Gallon	*ADWR	56
SHRUBS / ACCENTS			QTY
Calliandra californica Red Fairy Duster	5 Gallon	*ADWR	59
Callistemon viminalis 'Little John' 'Little John' Bottlebrush Bush	5 Gallon	*ADWR	531
Bouteloua gracilis 'Blonde Ambition' Blue Grama	5 Gallon	*ADWR	129
Eremophila maculata 'Valentine' Valentine Bush	5 Gallon	*ADWR	386
Hesperaloe parviflora 'Perpa' Brakelights Red Yucca	5 Gallon	*ADWR	606
Tecoma stans 'Orange Jubilee' Orange Jubilee Bells	5 Gallon	*ADWR	6
LANDSCAPE MATERIALS			QTY
Decomposed Granite. 3/4" minus, Dutchman Gold 2" deep in planting areas per plan.			100,631 sq. ft.
Decomposed Granite. 1/4" minus, Dutchman Red 8" deep in planting areas per plan.			39,403 sq. ft.
Decomposed Granite. 1/2" screened, Table mesa brown 2" deep in planting areas within R.O.W.			2,800 sq. ft.
Root Barrier Adjacent to Utility Lines COT STD DTL T-460-1			2,076 lf.

PEDESTRIAN LIGHT POLE WITH INTEGRATED BACK SHIELD

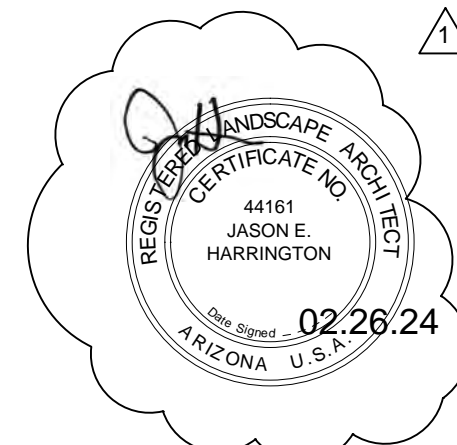

Call at least two full working days before you begin excavation.
ARIZONA 811
Arizona Blue Stake, Inc.
Dial 8-1-1 or 1-800-STAKE-IT (782-5348)
In Maricopa County: (602) 263-1100

LANDSCAPE NOTES

- SEE SHEET L0.1 FOR ADDITIONAL PROJECT NOTES.
- ALL PLANTING AREAS TO HAVE DECOMPOSED GRANITE.
- ALL AREAS RECEIVING NEW LANDSCAPE SHALL BE CLEARED AND GRUBBED.
- REMOVE EXISTING DG AND REPLACE WITH NEW DG.
- RESTORE EXISTING L/S TO CONDITION PRIOR TO CONSTRUCTION FOR ALL TCE AREAS.
- SEE DETAIL 5 ON L3.1 FOR NODE AREA PLANTS.
- SEE AIR PRODUCTS & CHEMICALS, INC. PLAN NOTES, SHEET 2.
- SEE PAGE 52 FOR KEYNOTE LEGEND.

Professional seal for Jason E. Harrington, Landscape Architect, No. 44161, State of Arizona, U.S.A. The seal is circular with the architect's name and number in the center, and 'REGISTERED LANDSCAPE ARCHITECT' and 'ARIZONA U.S.A.' around the perimeter. The date 06/27/22 is stamped on the seal.

HP
+ **D**

HARRINGTON
PLANNING + DESIGN
3116 S. MILL AVENUE,
SUITE 305
TEMPE, ARIZONA 85282
TEL: 480-250-0116

MARK	DATE	DESCRIPTION	BY

DEPARTMENT OF ENGINEERING & TRANSPORTATION
CITY OF TEMPE
ENGINEERING DIVISION
P.O. BOX 5002, TEMPE, AZ 85280

SURVEYED:	NAME	DESCRIPTION	DATE: 06/2022
DESIGNED:	JH	COUNTRY CLUB WAY MULTI-USE PATH	PROJECT NO.
DRAWN:	SL	WARNER RD TO US 60	6008961
CHECKED:	SJ	Tempe, Arizona	
SCALE:	PER PLAN	LANDSCAPE PLAN L1.0	SHT 53 of 156

MATCH LINE STA 8+40 SEE SHEET L1.0

MATCH LINE STA 12+60 SEE TOP RIGHT

MATCH LINE STA 12+60 SEE BOTTOM LEFT

MATCH LINE STA 16+80 SEE SHEET L1.2

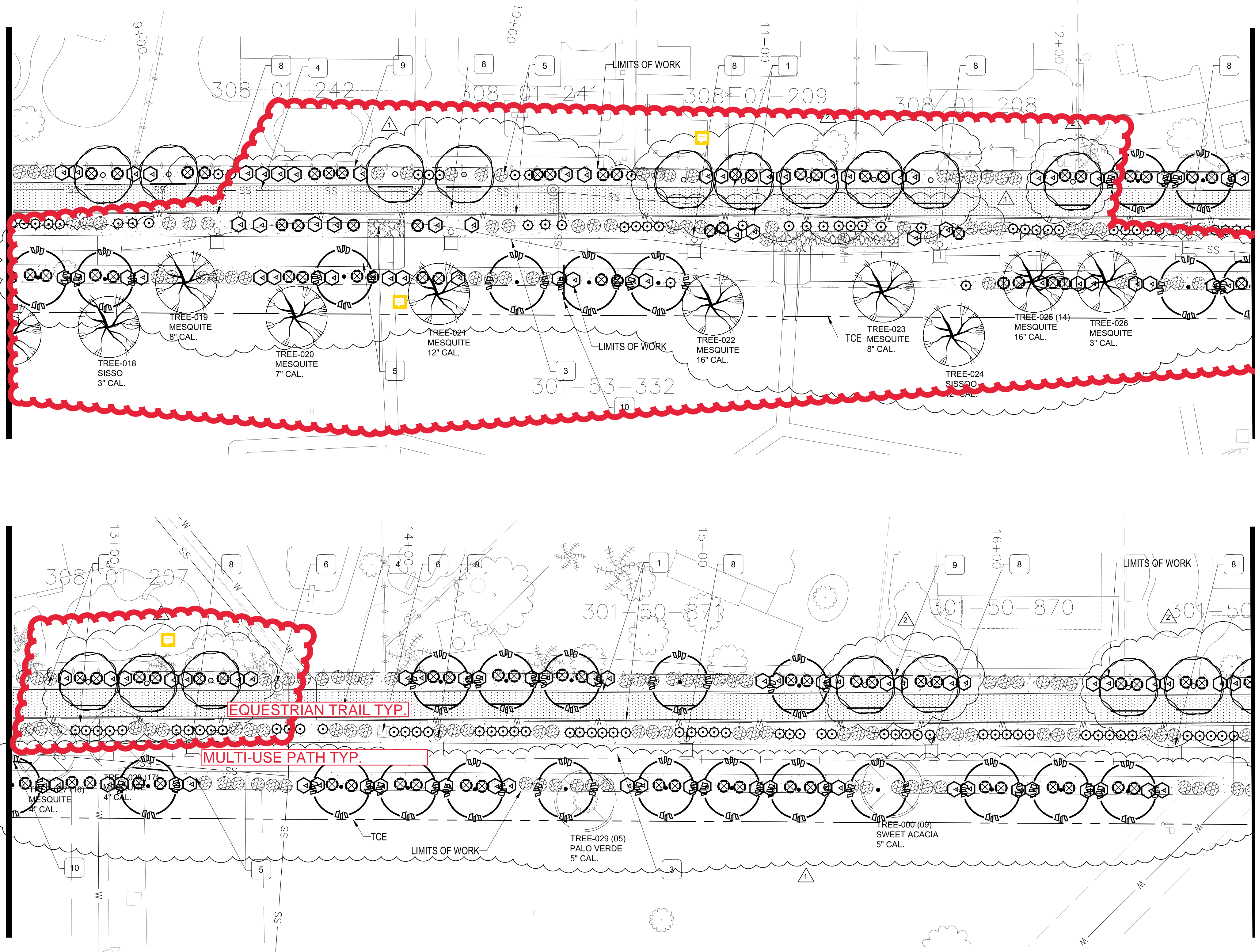

PLANTING MATERIAL LEGEND

TREES	SIZE	NOTES	QTY
Existing Tree to Remain - Protect in Place			84
Existing Tree to be Removed			56
Chilopsis linearis Desert Willow 'Bubba' Caliper Size: 1.5"	24" Box H 5'-7" W 3'-4"	*ADWR	11
Acacia salicina Willow Leaf Acacia Caliper Size: 1.5"	24" Box H 7'-8" W 2.5'-3.5"	ADWR	4
Eucalyptus papuana Ghost Gum Eucalyptus Caliper Size: 1.5"	24" Box H 7'-9" W 3'-4"	*ADWR	116
Pistacia lentiscus Mastic Tree Caliper Size: 1.5"	24" Box H 7'-9" W 2.5'-3.5"	ADWR	22
Mariosousa willardiana Palo Blanco Caliper Size: 1.5"	24" Box H 5'-8" W 2.5'-3.5"	ADWR	54
Olea europaea 'Wilsonii' 'Wilsonii' Fruitless Olive Caliper Size: 1.5"	24" Box H 6'-8" W 3'-5"	*ADWR	28
GROUNDCOVERS			QTY
Portulacaria afra Elephant's Food	5 Gallon	*ADWR	728
Eremophila glabra 'Mingenew Gold' Outback Sunrise Emu	5 Gallon	*ADWR	56
SHRUBS / ACCENTS			QTY
Calliandra californica Red Fairy Duster	5 Gallon	*ADWR	59
Callistemon viminalis 'Little John' 'Little John' Bottlebrush Bush	5 Gallon	*ADWR	531
Bouteloua gracilis 'Blonde Ambition' Blue Grama	5 Gallon	*ADWR	129
Eremophila maculata 'Valentine' Valentine Bush	5 Gallon	*ADWR	386
Hesperaloe parviflora 'Perpa' Brakelights Red Yucca	5 Gallon	*ADWR	606
Tecoma stans 'Orange Jubilee' Orange Jubilee Bells	5 Gallon	*ADWR	6
LANDSCAPE MATERIALS			QTY
Decomposed Granite. 3/4" minus, Dutchman Gold 2" deep in planting areas per plan.			100,631 sq. ft.
Decomposed Granite. 1/4" minus, Dutchman Red 8" deep in planting areas per plan.			39,403 sq. ft.
Decomposed Granite. 1/2" screened, Table mesa brown 2" deep in planting areas within R.O.W.			2,800 sq. ft.
Root Barrier Adjacent to Utility Lines COT STD DTL T-460-1			2,076 lf.

PEDESTRIAN LIGHT POLE WITH INTEGRATED BACK SHIELD

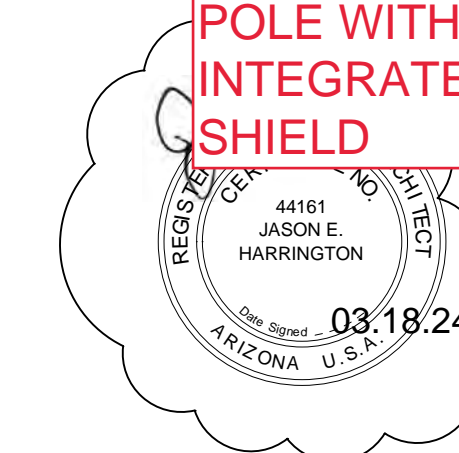
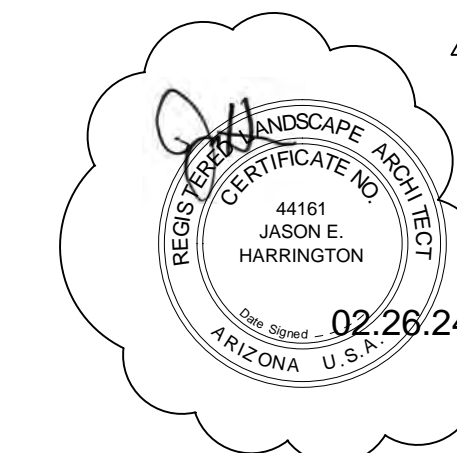

Call at least two full working days before you begin excavation.
ARIZONA 811
Arizona Blue Stake, Inc.
Dial 8-1-1 or 1-800-STAKE-IT (782-5348)
In Maricopa County: (602) 263-1100

LANDSCAPE NOTES

- SEE SHEET L0.1 FOR ADDITIONAL PROJECT NOTES.
- ALL PLANTING AREAS TO HAVE DECOMPOSED GRANITE.
- ALL AREAS RECEIVING NEW LANDSCAPE SHALL BE CLEARED AND GRUBBED.
- REMOVE EXISTING DG AND REPLACE WITH NEW DG.
- RESTORE EXISTING L/S TO CONDITION PRIOR TO CONSTRUCTION FOR ALL TCE AREAS.
- SEE DETAIL 5 ON L3.1 FOR NODE AREA PLANTS.
- SEE AIR PRODUCTS & CHEMICALS, INC. PLAN NOTES, SHEET 2.
- SEE PAGE 52 FOR KEYNOTE LEGEND.

KEY MAP

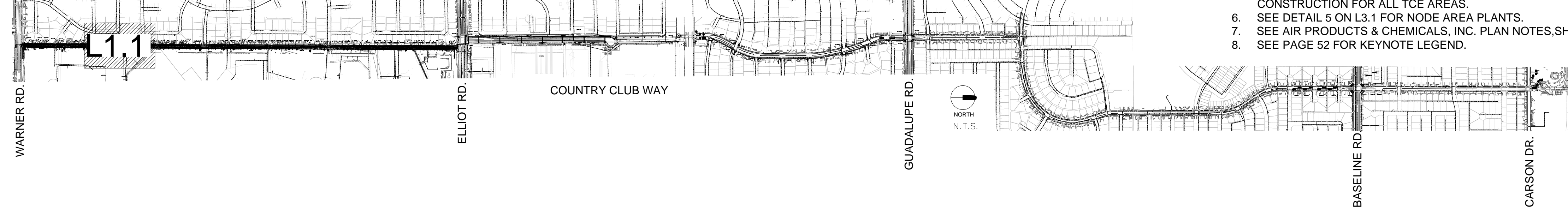

		<p>HP + D</p> <p>HARRINGTON PLANNING + DESIGN 3116 S. MILL AVENUE, SUITE 305 TEMPE, ARIZONA 85282 TEL: 480-250-0116</p>	
MARK	DATE	DESCRIPTION	BY
DEPARTMENT OF ENGINEERING & TRANSPORTATION CITY OF TEMPE ENGINEERING DIVISION P.O. BOX 5002, TEMPE, AZ 85280			
SURVEYED:	NAME	DESCRIPTION	DATE: 06/2022
DESIGNED:	JH	COUNTRY CLUB WAY MULTI-USE PATH	PROJECT NO.
DRAWN:	SL	WARNER RD TO US 60	6008961
CHECKED:	SJ	Tempe, Arizona	
SCALE:	PER PLAN	LANDSCAPE PLAN L1.1	SHT 54 of 156

MATCH LINE STA 16+80 SEE SHEET L1.1

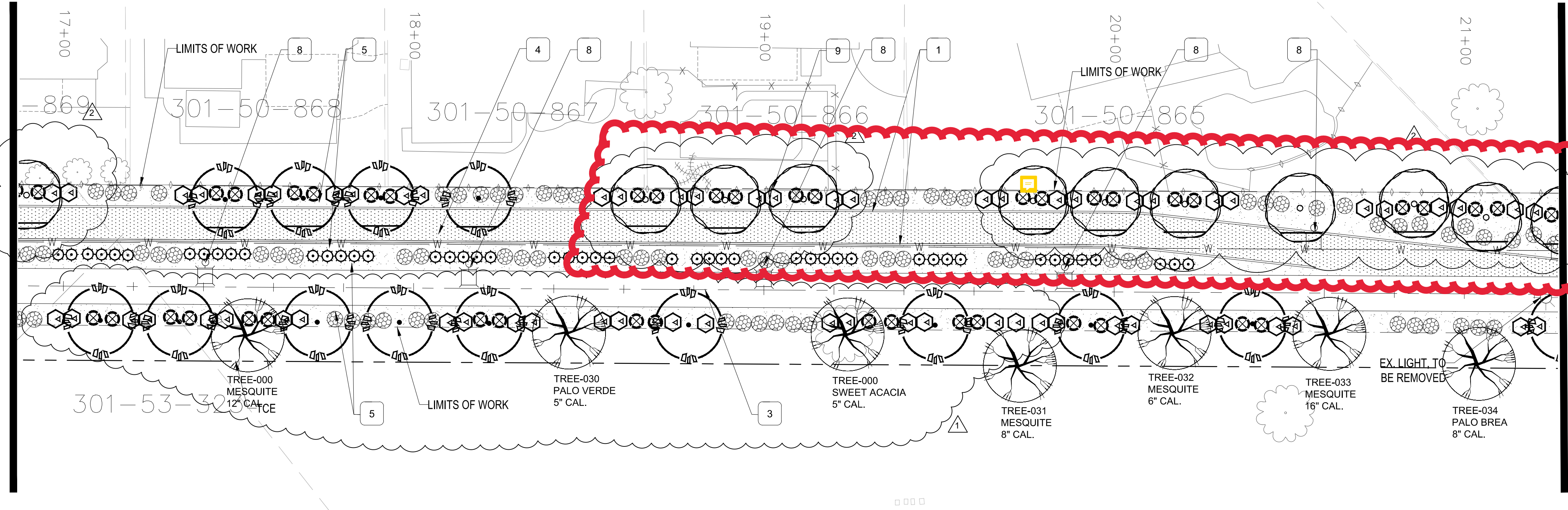

MATCH LINE STA 21+20 SEE BOTTOM LEFT

MATCH LINE STA 21+20 SEE TOP RIGHT

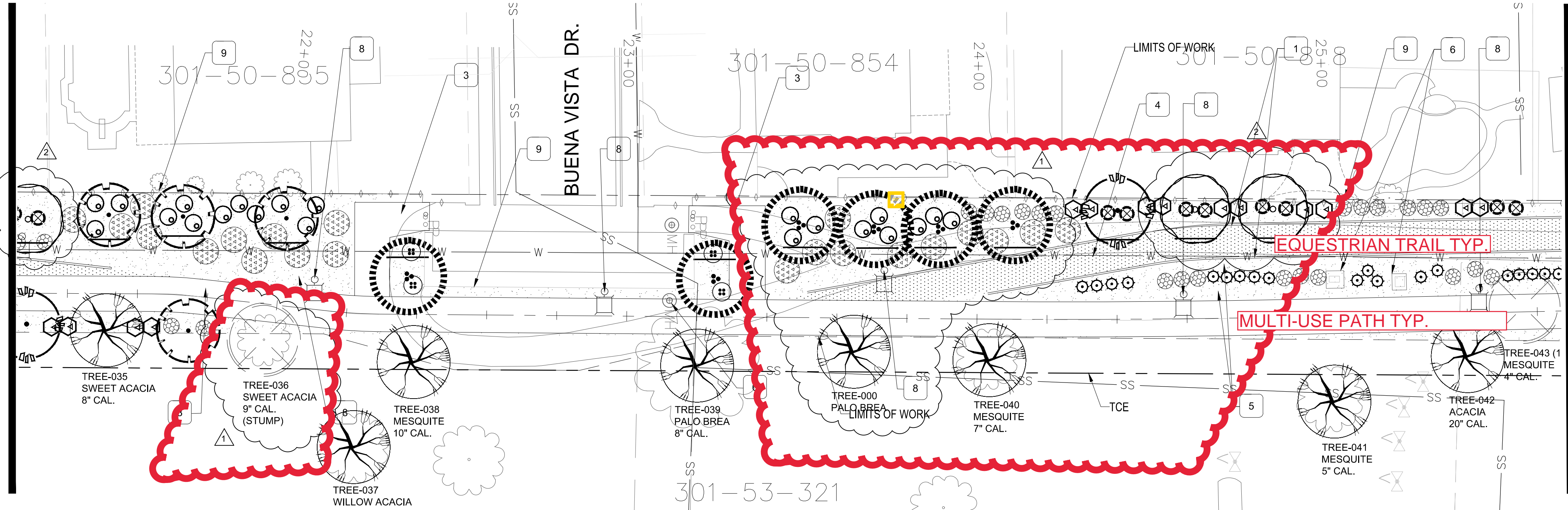

MATCH LINE STA 25+60 SEE SHEET L1.3

PLANTING MATERIAL LEGEND

TREES	SIZE	NOTES	QTY
Existing Tree to Remain - Protect in Place			84
Existing Tree to be Removed			56
Chilopsis linearis Desert Willow 'Bubba' Caliper Size: 1.5"	24" Box H 5'-7" W 3'-4"	*ADWR	11
Acacia salicina Willow Leaf Acacia Caliper Size: 1.5"	24" Box H 7'-8" W 2.5'-3.5"	ADWR	4
Eucalyptus papuana Ghost Gum Eucalyptus Caliper Size: 1.5"	24" Box H 7'-9" W 3'-4"	*ADWR	116
Pistacia lentiscus Mastic Tree Caliper Size: 1.5"	24" Box H 7'-9" W 2.5'-3.5"	ADWR	22
Mariosousa willardiana Palo Blanco Caliper Size: 1.5"	24" Box H 5'-8" W 2.5'-3.5"	ADWR	54
Olea europaea 'Wilsonii' 'Wilsonii' Fruitless Olive Caliper Size: 1.5"	24" Box H 6'-8" W 3'-5"	*ADWR	28
GROUNDCOVERS			QTY
Portulacaria afra Elephant's Food	5 Gallon	*ADWR	728
Eremophila glabra 'Mingenew Gold' Outback Sunrise Emu	5 Gallon	*ADWR	56
SHRUBS / ACCENTS			QTY
Calliandra californica Red Fairy Duster	5 Gallon	*ADWR	59
Callistemon viminalis 'Little John' 'Little John' Bottlebrush Bush	5 Gallon	*ADWR	531
Bouteloua gracilis 'Blonde Ambition' Blue Grama	5 Gallon	*ADWR	129
Eremophila maculata 'Valentine' Valentine Bush	5 Gallon	*ADWR	386
Hesperaloe parviflora 'Perpa' Brakelights Red Yucca	5 Gallon	*ADWR	606
Tecoma stans 'Orange Jubilee' Orange Jubilee Bells	5 Gallon	*ADWR	6
LANDSCAPE MATERIALS			QTY
Decomposed Granite. 3/4" minus, Dutchman Gold 2" deep in planting areas per plan.			100,631 sq. ft.
Decomposed Granite. 1/4" minus, Dutchman Red 8" deep in planting areas per plan.			39,403 sq. ft.
Decomposed Granite. 1/2" screened, Table mesa brown 2" deep in planting areas within R.O.W.			2,800 sq. ft.
Root Barrier Adjacent to Utility Lines COT STD DTL T-460-1			2,076 lf

PEDESTRIAN LIGHT POLE WITH INTEGRATED BACK SHIELD

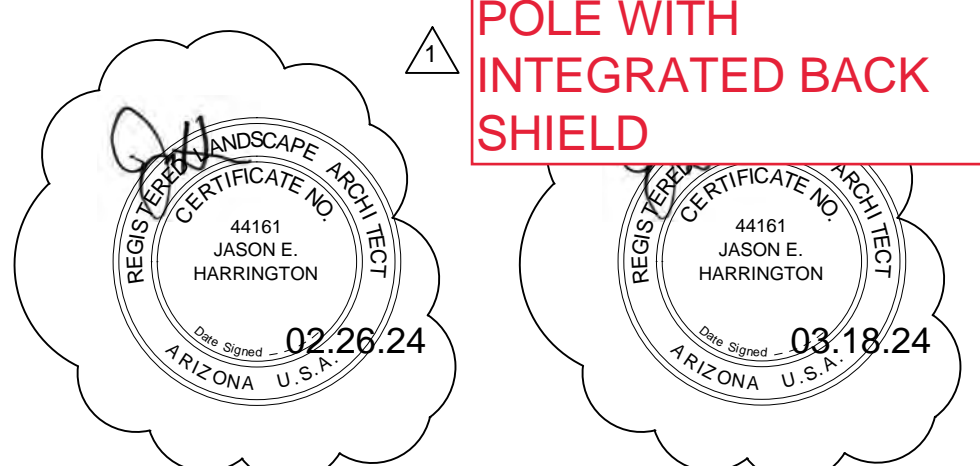

Call at least two full working days before you begin excavation.
ARIZONA 811
Arizona Blue Stake, Inc.
Dial 8-1-1 or 1-800-STAKE-IT (782-5348) in Maricopa County; (602) 263-1100

LANDSCAPE NOTES

- SEE SHEET L0.1 FOR ADDITIONAL PROJECT NOTES.
- ALL PLANTING AREAS TO HAVE DECOMPOSED GRANITE.
- ALL AREAS RECEIVING NEW LANDSCAPE SHALL BE CLEARED AND GRUBBED.
- REMOVE EXISTING DG AND REPLACE WITH NEW DG.
- RESTORE EXISTING L/S TO CONDITION PRIOR TO CONSTRUCTION FOR ALL TCE AREAS.
- SEE DETAIL 5 ON L3.1 FOR NODE AREA PLANTS.
- SEE AIR PRODUCTS & CHEMICALS, INC. PLAN NOTES, SHEET 2.
- SEE PAGE 52 FOR KEYNOTE LEGEND.

KEY MAP

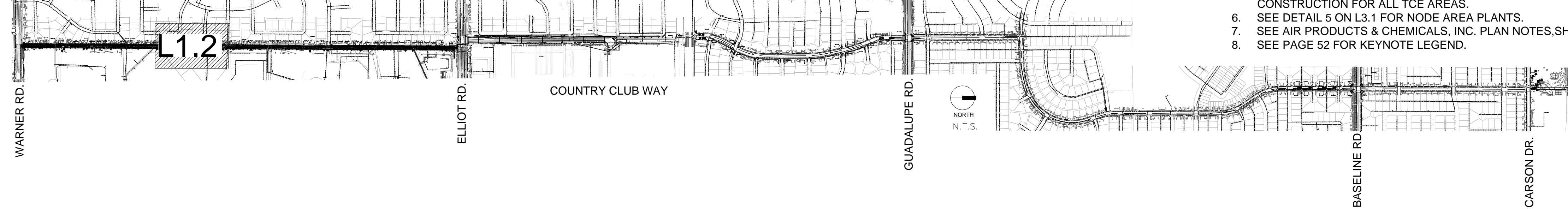

		<p>HP + D</p> <p>HARRINGTON PLANNING + DESIGN 3116 S. MILL AVENUE, SUITE 305 TEMPE, ARIZONA 85282 TEL: 480-250-0116</p>	
MARK	DATE	DESCRIPTION	BY
DEPARTMENT OF ENGINEERING & TRANSPORTATION CITY OF TEMPE ENGINEERING DIVISION P.O. BOX 5002, TEMPE, AZ 85280			
SURVEYED:	NAME	DESCRIPTION	DATE: 06/2022
DESIGNED:	JH	COUNTRY CLUB WAY MULTI-USE PATH	PROJECT NO.
DRAWN:	SL	WARNER RD TO US 60	6008961
CHECKED:	SJ	Tempe, Arizona	
SCALE:	PER PLAN	LANDSCAPE PLAN L1.2	SHT 55 of 156

MATCH LINE STA 25+60 SEE SHEET L1.2

MATCH LINE STA 30+00 SEE TOP RIGHT

MATCH LINE STA 30+00 SEE BOTTOM LEFT

MATCH LINE STA 34+40 SEE SHEET L1.4

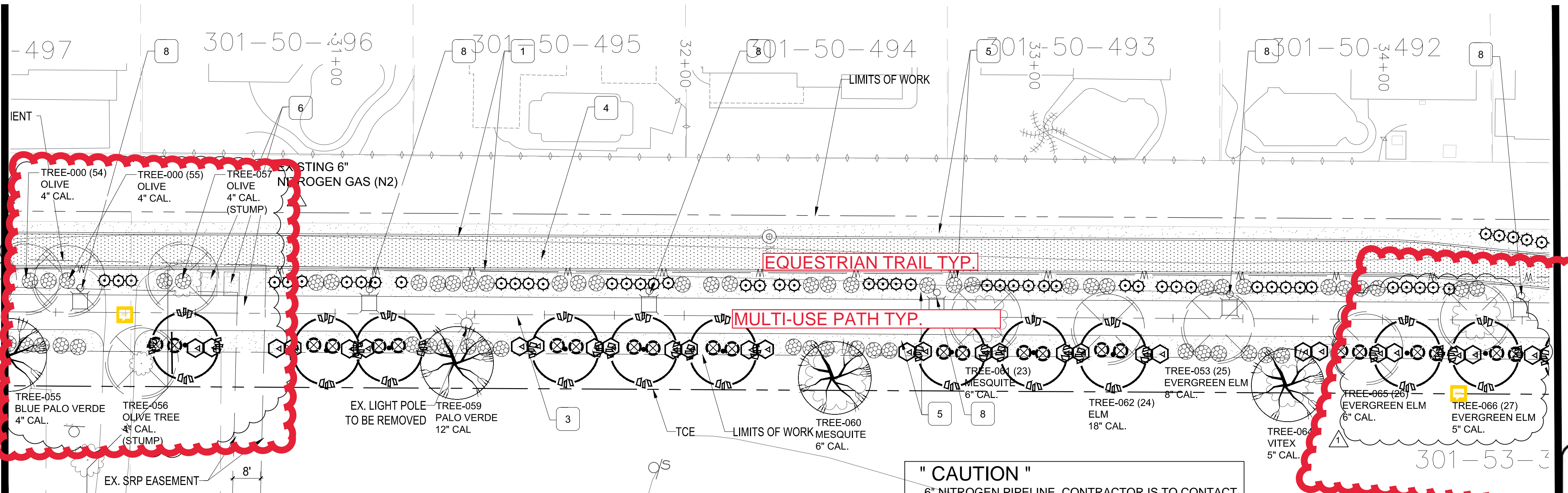
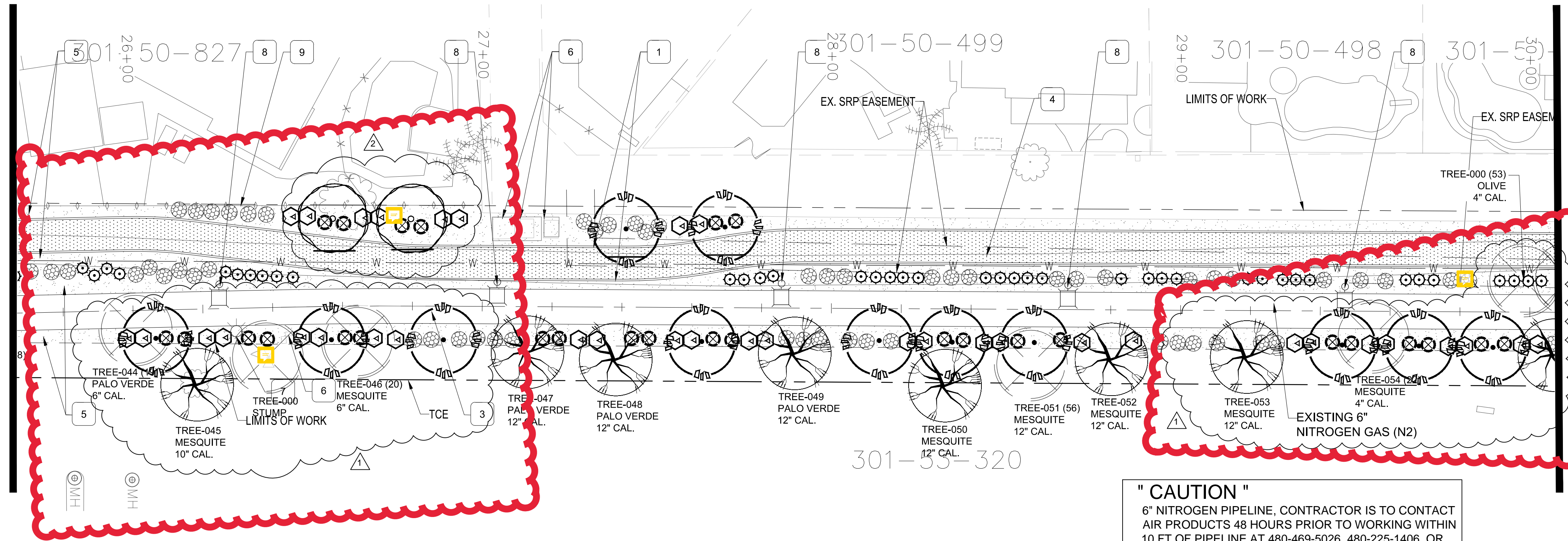

PLANTING MATERIAL LEGEND

TREES	SIZE	NOTES	QTY
Existing Tree to Remain - Protect in Place			84
Existing Tree to be Removed			56
Chilopsis linearis Desert Willow 'Bubba' Caliper Size: 1.5"	24" Box H 5'-7" W 3'-4"	*ADWR	11
Acacia salicina Willow Leaf Acacia Caliper Size: 1.5"	24" Box H 7'-8" W 2.5'-3.5"	ADWR	4
Eucalyptus papuana Ghost Gum Eucalyptus Caliper Size: 1.5"	24" Box H 7'-9" W 3'-4"	*ADWR	116
Pistacia lentiscus Mastic Tree Caliper Size: 1.5"	24" Box H 7'-9" W 2.5'-3.5"	ADWR	22
Mariosousa willardiana Palo Blanco Caliper Size: 1.5"	24" Box H 5'-8" W 2.5'-3.5"	ADWR	54
Olea europaea 'Wilsonii' 'Wilsonii' Fruitless Olive Caliper Size: 1.5"	24" Box H 6'-8" W 3'-5"	*ADWR	28
GROUNDCOVERS			QTY
Portulacaria afra Elephant's Food	5 Gallon	*ADWR	728
Eremophila glabra 'Mingenew Gold' Outback Sunrise Emu	5 Gallon	*ADWR	56
SHRUBS / ACCENTS			QTY
Calliandra californica Red Fairy Duster	5 Gallon	*ADWR	59
Callistemon viminalis 'Little John' 'Little John' Bottlebrush Bush	5 Gallon	*ADWR	531
Bouteloua gracilis 'Blonde Ambition' Blue Grama	5 Gallon	*ADWR	129
Eremophila maculata 'Valentine' Valentine Bush	5 Gallon	*ADWR	386
Hesperaloe parviflora 'Perpa' Brakelights Red Yucca	5 Gallon	*ADWR	606
Tecoma stans 'Orange Jubilee' Orange Jubilee Bells	5 Gallon	*ADWR	6
LANDSCAPE MATERIALS			
Decomposed Granite. 3/4" minus, Dutchman Gold 2" deep in planting areas per plan.			100,631 sq. ft.
Decomposed Granite. 1/4" minus, Dutchman Red 8" deep in planting areas per plan.			39,403 sq. ft.
Decomposed Granite. 1/2" screened, Table mesa brown 2" deep in planting areas within R.O.W.			2,800 sq. ft.
Root Barrier Adjacent to Utility Lines COT STD DTL T-460-1			2,076 lf.

PEDESTRIAN LIGHT POLE WITH INTEGRATED BACK SHIELD

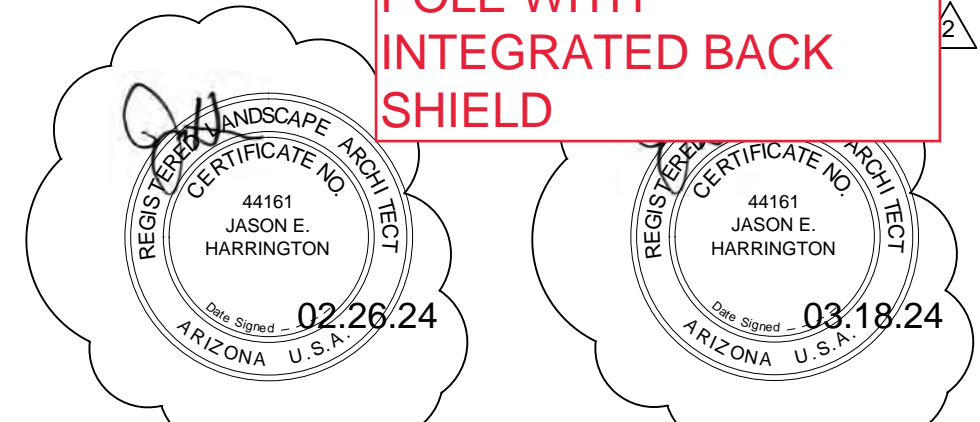

KEY MAP

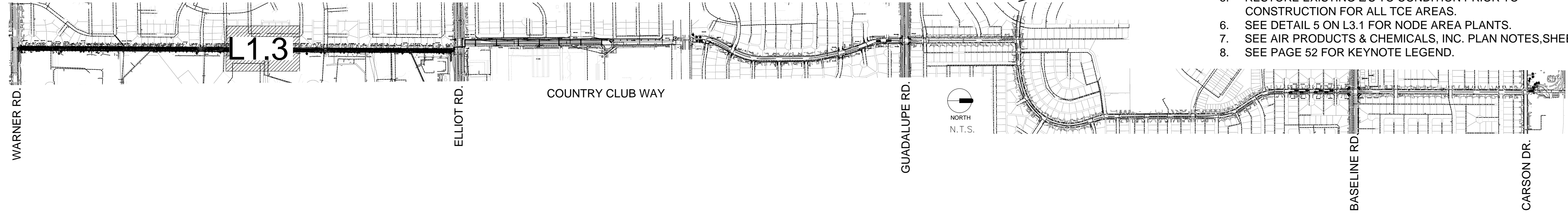

" CAUTION "
6" NITROGEN PIPELINE, CONTRACTOR IS TO CONTACT AIR PRODUCTS 48 HOURS PRIOR TO WORKING WITHIN 10 FT OF PIPELINE AT 480-469-5026, 480-225-1406, OR 480-899-1177.

" CAUTION "
6" NITROGEN PIPELINE, CONTRACTOR IS TO CONTACT AIR PRODUCTS 48 HOURS PRIOR TO WORKING WITHIN 10 FT OF PIPELINE AT 480-469-5026, 480-225-1406, OR 480-899-1177.

LANDSCAPE NOTES

- SEE SHEET L0.1 FOR ADDITIONAL PROJECT NOTES.
- ALL PLANTING AREAS TO HAVE DECOMPOSED GRANITE.
- ALL AREAS RECEIVING NEW LANDSCAPE SHALL BE CLEARED AND GRUBBED.
- REMOVE EXISTING DG AND REPLACE WITH NEW DG.
- RESTORE EXISTING L/S TO CONDITION PRIOR TO CONSTRUCTION FOR ALL TCE AREAS.
- SEE DETAIL 5 ON L3.1 FOR NODE AREA PLANTS.
- SEE AIR PRODUCTS & CHEMICALS, INC. PLAN NOTES, SHEET 2.
- SEE PAGE 52 FOR KEYNOTE LEGEND.



HP + D

HARRINGTON
PLANNING + DESIGN
3116 S. MILL AVENUE,
SUITE 305
TEMPE, ARIZONA 85282
TEL: 480-250-0116

MARK	DATE	DESCRIPTION	BY

DEPARTMENT OF ENGINEERING & TRANSPORTATION
CITY OF TEMPE
ENGINEERING DIVISION
P.O. BOX 5002, TEMPE, AZ 85280

SURVEYED:	NAME	DESCRIPTION	DATE: 06/2022
DESIGNED:	JH	COUNTRY CLUB WAY MULTI-USE PATH	PROJECT NO.
DRAWN:	SL	WARNER RD TO US 60	6008961
CHECKED:	SJ	Tempe, Arizona	SHT
SCALE:	PER PLAN	LANDSCAPE PLAN L1.3	56 of 156

MATCH LINE STA 34+40 SEE SHEET L1.3

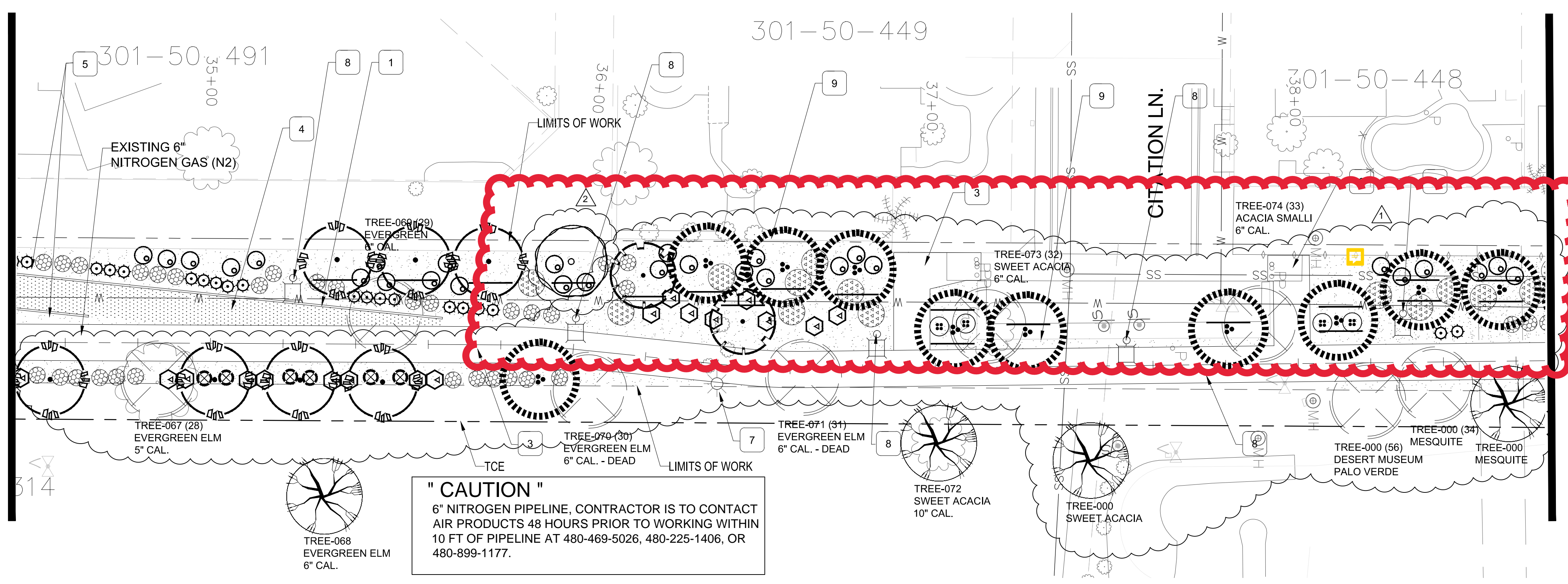

" CAUTION "
6" NITROGEN PIPELINE, CONTRACTOR IS TO CONTACT AIR PRODUCTS 48 HOURS PRIOR TO WORKING WITHIN 10 FT OF PIPELINE AT 480-469-5026, 480-225-1406, OR 480-899-1177.

MATCH LINE STA 38+60 SEE TOP RIGHT

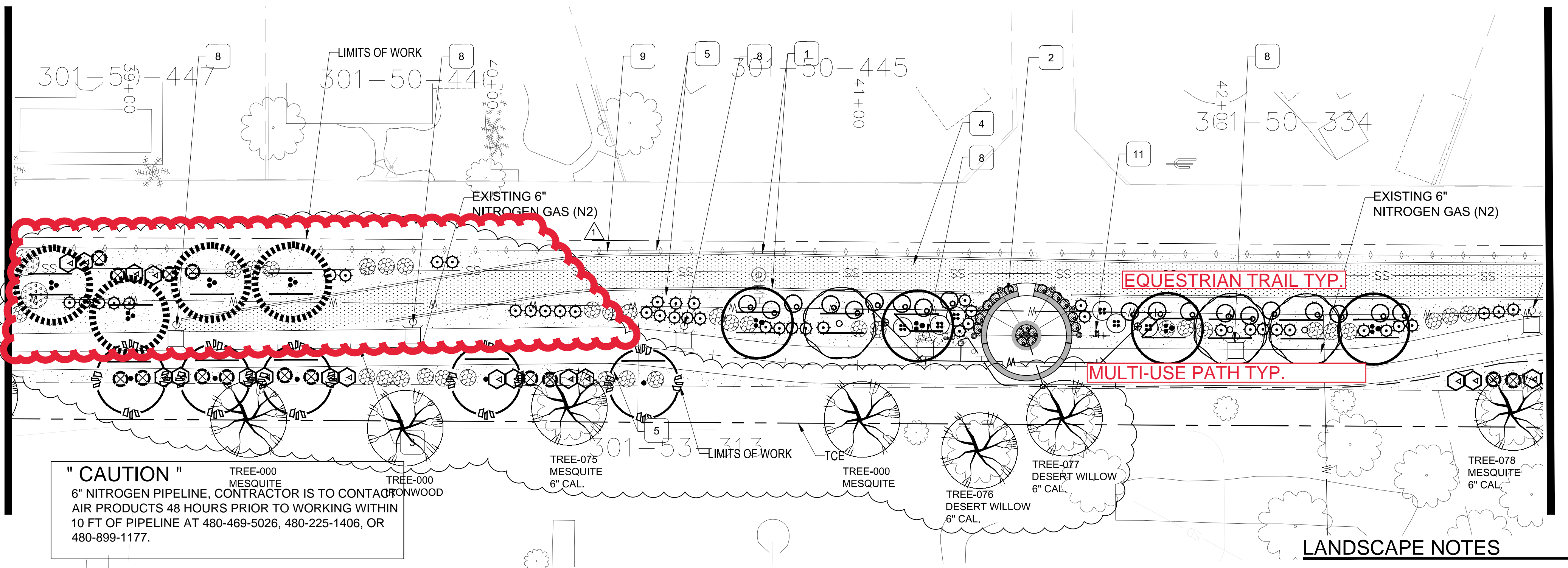

" CAUTION "
6" NITROGEN PIPELINE, CONTRACTOR IS TO CONTACT AIR PRODUCTS 48 HOURS PRIOR TO WORKING WITHIN 10 FT OF PIPELINE AT 480-469-5026, 480-225-1406, OR 480-899-1177.

KEY MAP

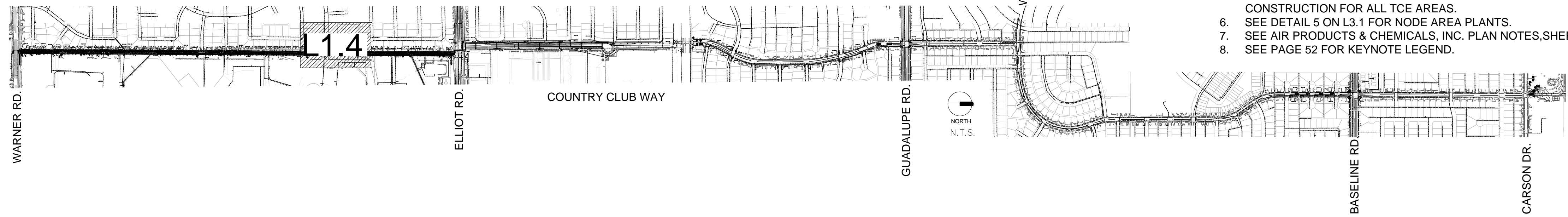

PLANTING MATERIAL LEGEND

TREES	SIZE	NOTES	QTY
Existing Tree to Remain - Protect in Place			84
Existing Tree to be Removed			56
Chilopsis linearis Desert Willow 'Bubba' Caliper Size: 1.5"	24" Box H 5'-7" W 3'-4"	*ADWR	11
Acacia salicina Willow Leaf Acacia Caliper Size: 1.5"	24" Box H 7'-8" W 2.5'-3.5"	ADWR	4
Eucalyptus papuana Ghost Gum Eucalyptus Caliper Size: 1.5"	24" Box H 7'-9" W 3'-4"	*ADWR	116
Pistacia lentiscus Mastic Tree Caliper Size: 1.5"	24" Box H 7'-9" W 2.5'-3.5"	ADWR	22
Mariosousa willardiana Palo Blanco Caliper Size: 1.5"	24" Box H 5'-8" W 2.5'-3.5"	ADWR	54
Olea europaea 'Wilsonii' 'Wilsonii' Fruitless Olive Caliper Size: 1.5"	24" Box H 6'-8" W 3'-5"	*ADWR	28
GROUNDCOVERS			QTY
Portulacaria afra Elephant's Food	5 Gallon	*ADWR	728
Eremophila glabra 'Mingenew Gold' Outback Sunrise Emu	5 Gallon	*ADWR	56
SHRUBS / ACCENTS			QTY
Calliandra californica Red Fairy Duster	5 Gallon	*ADWR	59
Callistemon viminalis 'Little John' 'Little John' Bottlebrush Bush	5 Gallon	*ADWR	531
Bouteloua gracilis 'Blonde Ambition' Blue Grama	5 Gallon	*ADWR	129
Eremophila maculata 'Valentine' Valentine Bush	5 Gallon	*ADWR	386
Hesperaloe parviflora 'Perpa' Brakeights Red Yucca	5 Gallon	*ADWR	606
Tecoma stans 'Orange Jubilee' Orange Jubilee Belts	5 Gallon	*ADWR	6
LANDSCAPE MATERIALS			QTY
Decomposed Granite. 3/4" minus, Dutchman Gold 2" deep in planting areas per plan.			100,631 sq. ft.
Decomposed Granite. 1/4" minus, Dutchman Red 8" deep in planting areas per plan.			39,403 sq. ft.
Decomposed Granite. 1/2" screened, Table mesa brown 2" deep in planting areas within R.O.W.			2,800 sq. ft.
Root Barrier Adjacent to Utility Lines COT STD DTL T-460-1			2,076 lf.

PEDESTRIAN LIGHT POLE WITH INTEGRATED BACK SHIELD

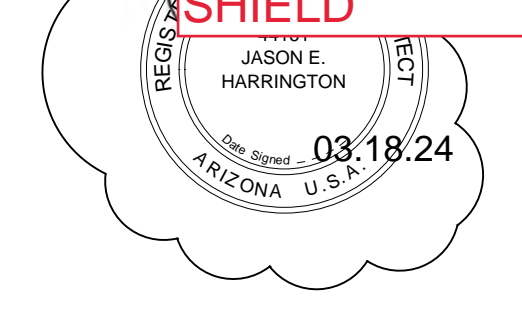

LANDSCAPE NOTES

- SEE SHEET L0.1 FOR ADDITIONAL PROJECT NOTES.
- ALL PLANTING AREAS TO HAVE DECOMPOSED GRANITE.
- ALL AREAS RECEIVING NEW LANDSCAPE SHALL BE CLEARED AND GRUBBED.
- REMOVE EXISTING DG AND REPLACE WITH NEW DG.
- RESTORE EXISTING L/S TO CONDITION PRIOR TO CONSTRUCTION FOR ALL TCE AREAS.
- SEE DETAIL 5 ON L3.1 FOR NODE AREA PLANTS.
- SEE AIR PRODUCTS & CHEMICALS, INC. PLAN NOTES, SHEET 2.
- SEE PAGE 52 FOR KEYNOTE LEGEND.

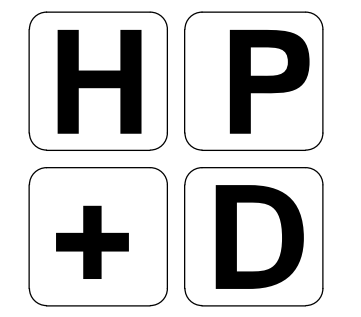
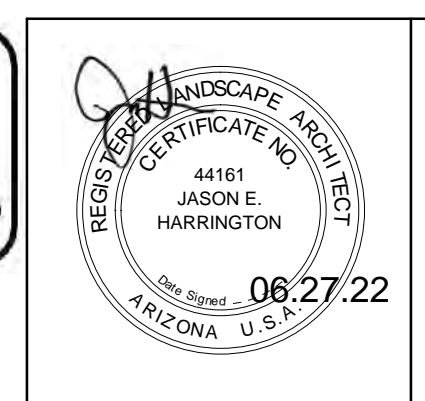

HARRINGTON PLANNING + DESIGN
3116 S. MILL AVENUE, SUITE 305
TEMPE, ARIZONA 85282
TEL: 480-250-0116

MARK	DATE	DESCRIPTION	BY

DEPARTMENT OF ENGINEERING & TRANSPORTATION
CITY OF TEMPE
ENGINEERING DIVISION
P.O. BOX 5002, TEMPE, AZ 85280

SURVEYED: NAME	DESCRIPTION	DATE: 06/2022
DESIGNED: JH	COUNTRY CLUB WAY MULTI-USE PATH	PROJECT NO.
DRAWN: SL	WARNER RD TO US 60	6008961
CHECKED: SJ	Tempe, Arizona	
SCALE: PER PLAN	LANDSCAPE PLAN L1.4	SHT 57 OF 156

MATCH LINE STA 42+80 SEE SHEET L1.4

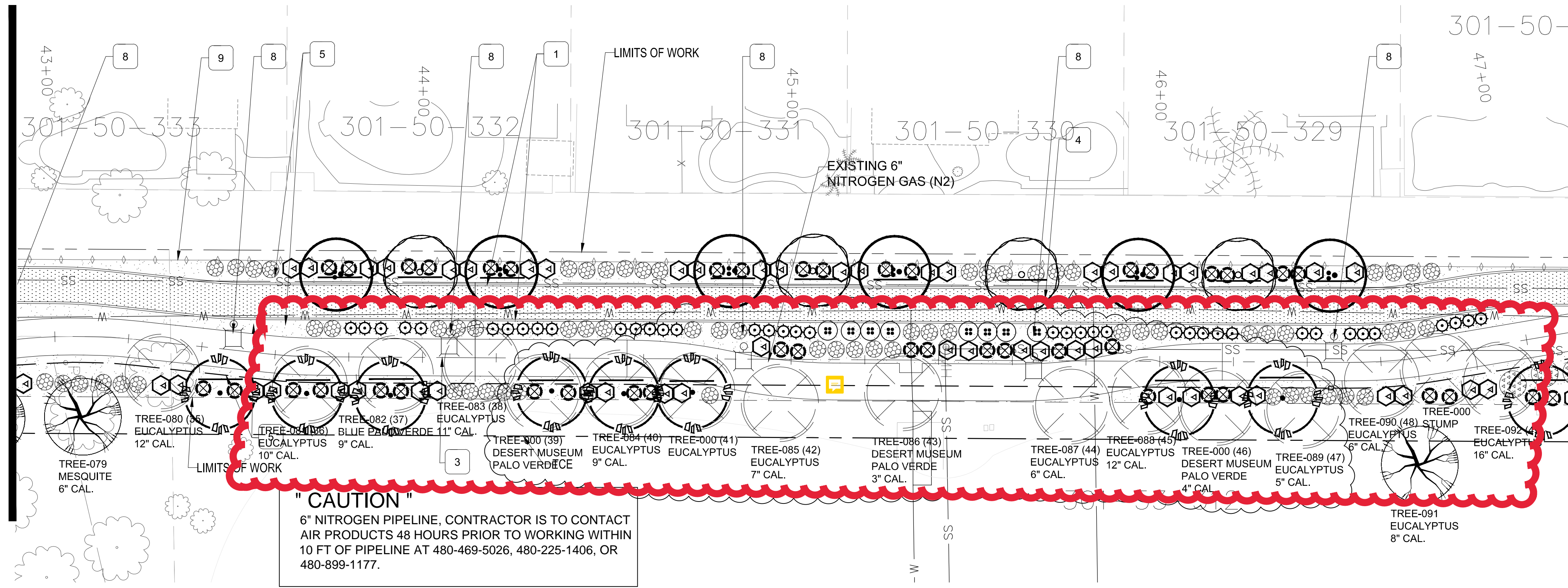

" CAUTION "
 6" NITROGEN PIPELINE, CONTRACTOR IS TO CONTACT AIR PRODUCTS 48 HOURS PRIOR TO WORKING WITHIN 10 FT OF PIPELINE AT 480-469-5026, 480-225-1406, OR 480-899-1177.

MATCH LINE STA 47+00 SEE TOP RIGHT

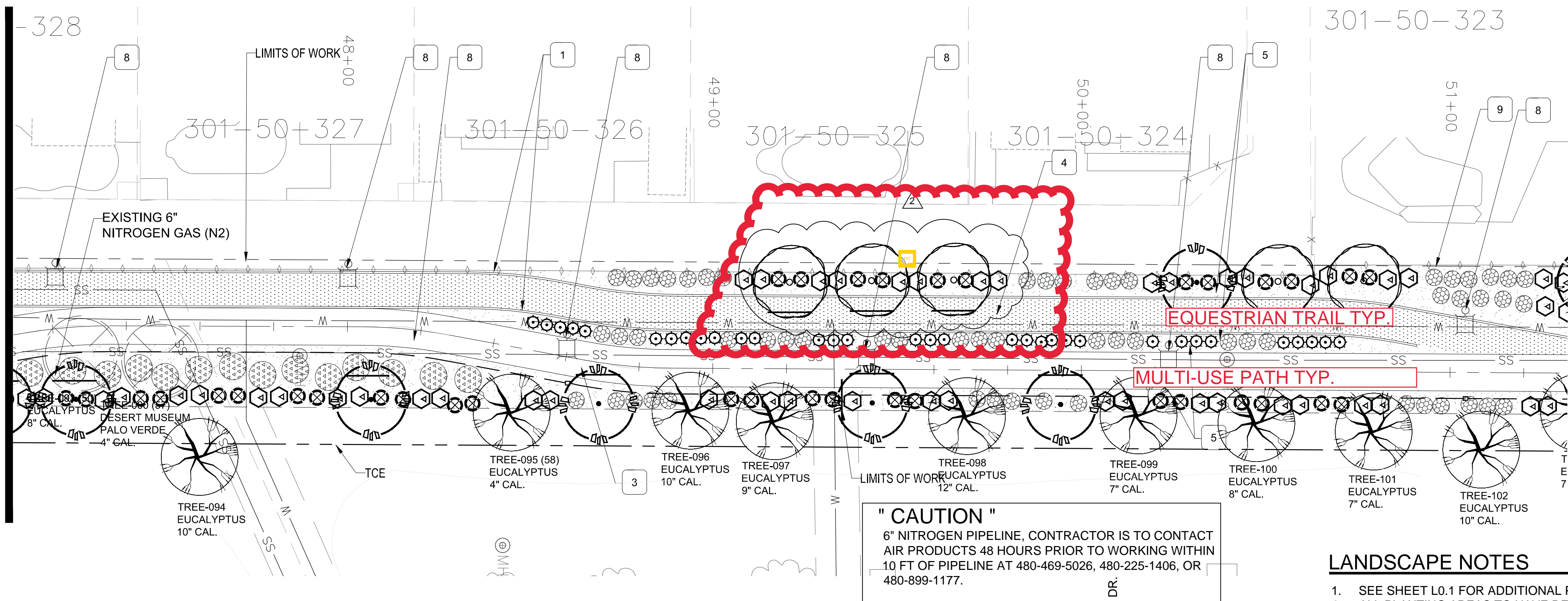

" CAUTION "
 6" NITROGEN PIPELINE, CONTRACTOR IS TO CONTACT AIR PRODUCTS 48 HOURS PRIOR TO WORKING WITHIN 10 FT OF PIPELINE AT 480-469-5026, 480-225-1406, OR 480-899-1177.

KEY MAP

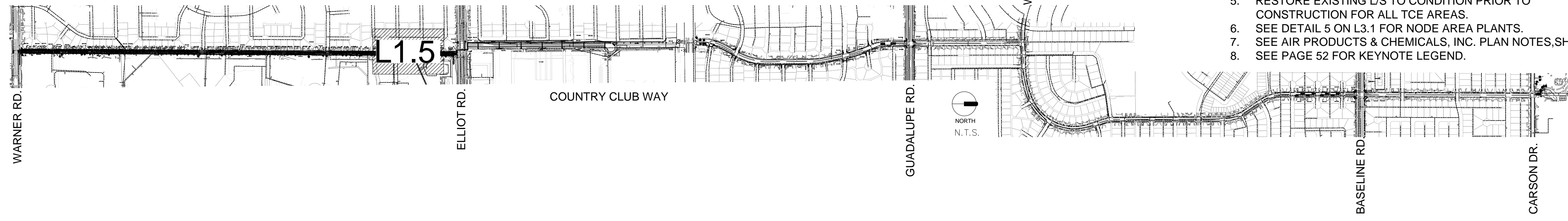

MATCH LINE STA 47+00 SEE BOTTOM LEFT

MATCH LINE STA 51+20 SEE SHEET L1.6

PLANTING MATERIAL LEGEND

TREES	SIZE	NOTES	QTY
Existing Tree to Remain - Protect in Place			84
Existing Tree to be Removed			56
Chilopsis linearis Desert Willow 'Bubba' Caliper Size: 1.5"	24" Box H 5'-7" W 3'-4"	*ADWR	11
Acacia salicina Willow Leaf Acacia Caliper Size: 1.5"	24" Box H 7'-8" W 2.5'-3.5"	ADWR	4
Eucalyptus papuana Ghost Gum Eucalyptus Caliper Size: 1.5"	24" Box H 7'-9" W 3'-4"	*ADWR	116
Pistacia lentiscus Mastic Tree Caliper Size: 1.5"	24" Box H 7'-9" W 2.5'-3.5"	ADWR	22
Mariosousa willardiana Palo Blanco Caliper Size: 1.5"	24" Box H 5'-8" W 2.5'-3.5"	ADWR	54
Olea europaea 'Wilsonii' 'Wilsonii' Fruitless Olive Caliper Size: 1.5"	24" Box H 6'-8" W 3'-5"	*ADWR	28
GROUNDCOVERS			QTY
Portulacaria afra Elephant's Food	5 Gallon	*ADWR	728
Eremophila glabra 'Mingenew Gold' Outback Sunrise Eru	5 Gallon	*ADWR	56
SHRUBS / ACCENTS			QTY
Calliandra californica Red Fairy Duster	5 Gallon	*ADWR	59
Callistemon viminalis 'Little John' 'Little John' Bottlebrush Bush	5 Gallon	*ADWR	531
Bouteloua gracilis 'Blonde Ambition' Blue Grama	5 Gallon	*ADWR	129
Eremophila maculata 'Valentine' Valentine Bush	5 Gallon	*ADWR	386
Hesperaloe parviflora 'Perpa' Brakelights Red Yucca	5 Gallon	*ADWR	606
Tecoma stans 'Orange Jubilee' Orange Jubilee Bells	5 Gallon	*ADWR	6
LANDSCAPE MATERIALS			
Decomposed Granite, 3/4" minus, Dutchman Gold 2" deep in planting areas per plan.			100,631 sq. ft.
Decomposed Granite, 1/4" minus, Dutchman Red 8" deep in planting areas per plan.			39,403 sq. ft.
Decomposed Granite, 1/2" screened, Table mesa brown 2" deep in planting areas within R.O.W.			2,800 sq. ft.
Root Barrier Adjacent to Utility Lines COT STD DTL T-460-1			2,076 lf.

PEDESTRIAN LIGHT POLE WITH INTEGRATED BACK SHIELD

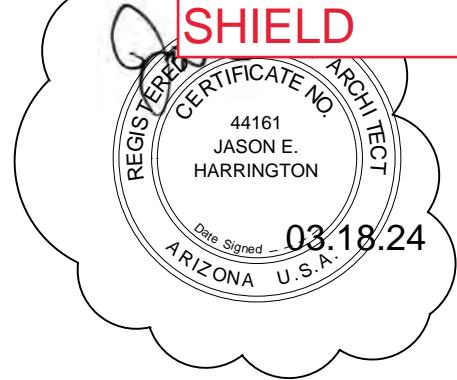

LANDSCAPE NOTES

- SEE SHEET L0.1 FOR ADDITIONAL PROJECT NOTES.
- ALL PLANTING AREAS TO HAVE DECOMPOSED GRANITE.
- ALL AREAS RECEIVING NEW LANDSCAPE SHALL BE CLEARED AND GRUBBED.
- REMOVE EXISTING DG AND REPLACE WITH NEW DG.
- RESTORE EXISTING L/S TO CONDITION PRIOR TO CONSTRUCTION FOR ALL TCE AREAS.
- SEE DETAIL 5 ON L3.1 FOR NODE AREA PLANTS.
- SEE AIR PRODUCTS & CHEMICALS, INC. PLAN NOTES, SHEET 2.
- SEE PAGE 52 FOR KEYNOTE LEGEND.

HP
+
DP

HARRINGTON
PLANNING + DESIGN
3116 S. MILL AVENUE,
SUITE 305
TEMPE, ARIZONA 85282
TEL: 480-250-0116

MARK	DATE	DESCRIPTION	BY

DEPARTMENT OF ENGINEERING & TRANSPORTATION
CITY OF TEMPE
 ENGINEERING DIVISION
 P.O. BOX 5002, TEMPE, AZ 85280

SURVEYED: NAME	DESCRIPTION	DATE: 06/2022
DESIGNED: JH	COUNTRY CLUB WAY MULTI-USE PATH	PROJECT NO.
DRAWN: SL	WARNER RD TO US 60	6008961
CHECKED: SJ	Tempe, Arizona	
SCALE: PER PLAN	LANDSCAPE PLAN L1.5	SHT 58 of 156

MATCH LINE STA 51+20 SEE SHEET L1.5

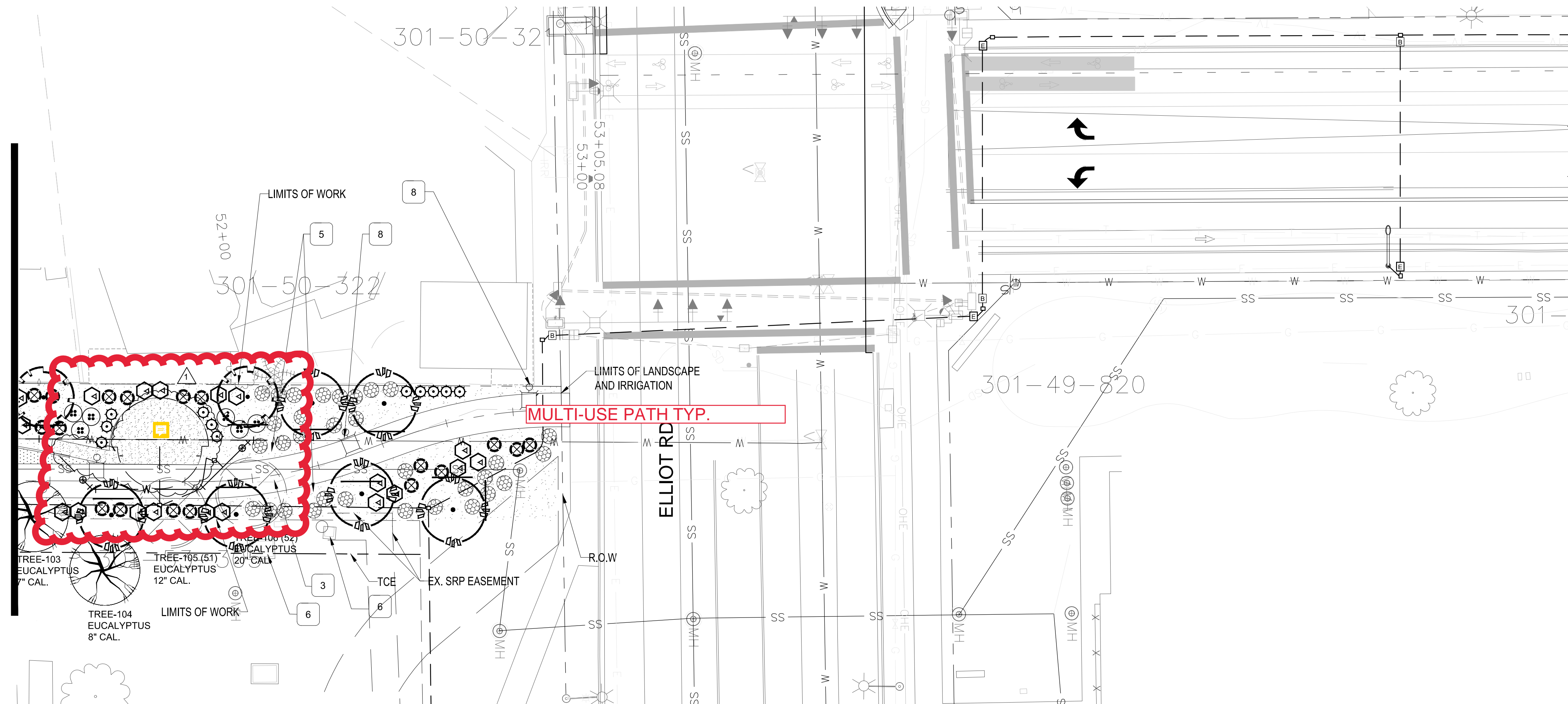

STA 67+80 END SEGMENT

PLANTING MATERIAL LEGEND

TREES	SIZE	NOTES	QTY
Existing Tree to Remain - Protect in Place			84
Existing Tree to be Removed			56
Chilopsis linearis Desert Willow 'Bubba' Caliper Size: 1.5"	24" Box H 5'-7" W 3'-4"	*ADWR	11
Acacia salicina Willow Leaf Acacia Caliper Size: 1.5"	24" Box H 7'-8" W 2.5'-3.5"	ADWR	4
Eucalyptus papuana Ghost Gum Eucalyptus Caliper Size: 1.5"	24" Box H 7'-9" W 3'-4"	*ADWR	150
Pistacia lentiscus Mastic Tree Caliper Size: 1.5"	24" Box H 7'-9" W 2.5'-3.5"	ADWR	22
Mariosousa willardiana Palo Blanco Caliper Size: 1.5"	24" Box H 5'-8" W 2.5'-3.5"	ADWR	20
Olea europaea 'Wilsonii' 'Wilsonii' Fruitless Olive Caliper Size: 1.5"	24" Box H 6'-8" W 3'-5"	*ADWR	28
GROUNDCOVERS			QTY
Portulacaria afra Elephant's Food	5 Gallon	*ADWR	728
Eremophila glabra 'Mingenew Gold' Outback Sunrise Emu	5 Gallon	*ADWR	56
SHRUBS / ACCENTS			QTY
Calliandra californica Red Fairy Duster	5 Gallon	*ADWR	59
Callistemon viminalis 'Little John' 'Little John' Bottlebrush Bush	5 Gallon	*ADWR	531
Bouteloua gracilis 'Blonde Ambition' Blue Grama	5 Gallon	*ADWR	129
Eremophila maculata 'Valentine' Valentine Bush	5 Gallon	*ADWR	386
Hesperaloe parviflora 'Perpa' Brakelights Red Yucca	5 Gallon	*ADWR	606
Tecoma stans 'Orange Jubilee' Orange Jubilee Bells	5 Gallon	*ADWR	6
LANDSCAPE MATERIALS			QTY
Decomposed Granite. 3/4" minus, Dutchman Gold 2" deep in planting areas per plan.			100,631 sq. ft.
Decomposed Granite. 1/4" minus, Dutchman Red 8" deep in planting areas per plan.			39,403 sq. ft.
Decomposed Granite. 1/2" screened, Table mesa brown 2" deep in planting areas within R.O.W.			2,800 sq. ft.
Root Barrier Adjacent to Utility Lines COT STD DTL T-460-1			2,076 lf

PEDESTRIAN LIGHT POLE WITH INTEGRATED BACK SHIELD

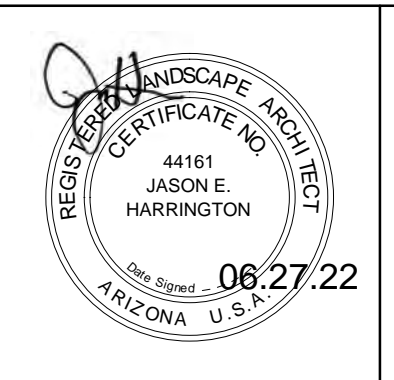

HP + D

HARRINGTON
PLANNING + DESIGN
3116 S. MILL AVENUE,
SUITE 305
TEMPE, ARIZONA 85282
TEL: 480-250-0116

LANDSCAPE NOTES

- SEE SHEET L0.1 FOR ADDITIONAL PROJECT NOTES.
- ALL PLANTING AREAS TO HAVE DECOMPOSED GRANITE.
- ALL AREAS RECEIVING NEW LANDSCAPE SHALL BE CLEARED AND GRUBBED.
- REMOVE EXISTING DG AND REPLACE WITH NEW DG.
- RESTORE EXISTING L/S TO CONDITION PRIOR TO CONSTRUCTION FOR ALL TCE AREAS.
- SEE DETAIL 5 ON L3.1 FOR NODE AREA PLANTS.
- SEE AIR PRODUCTS & CHEMICALS, INC. PLAN NOTES, SHEET 2.
- SEE PAGE 52 FOR KEYNOTE LEGEND.

KEY MAP

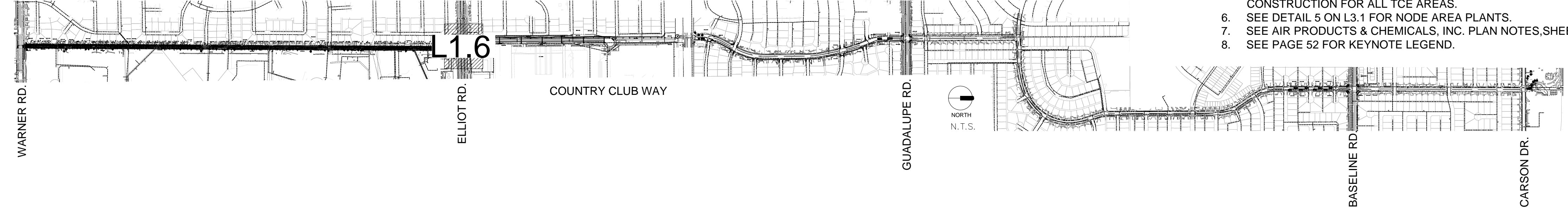

MARK	DATE	DESCRIPTION	BY

DEPARTMENT OF ENGINEERING & TRANSPORTATION
CITY OF TEMPE
ENGINEERING DIVISION
P.O. BOX 5002, TEMPE, AZ 85280

SURVEYED:	NAME	DESCRIPTION	DATE: 06/2022
DESIGNED:	JH	COUNTRY CLUB WAY MULTI-USE PATH	PROJECT NO.
DRAWN:	SL	WARNER RD TO US 60	6008961
CHECKED:	SJ	Tempe, Arizona	
SCALE:	PER PLAN	LANDSCAPE PLAN L1.6	SHT 59 of 156

LEGEND

-  NEW TREE
-  EXISTING TREE
-  TREE PREVIOUSLY CALLED OUT FOR REMOVAL NOW PROTECTED IN PLACE
-  EXISTING TREE TO BE REMOVED
-  PROPOSED NEW TREES THAT CAN BE RELOCATED WHERE FEASIBLE
-  10' WIDE Path Realignment
-  10' WIDE Path Per Plans
-  Path Light Fixture Per Plan
-  Path Light Fixture Location Adjusted

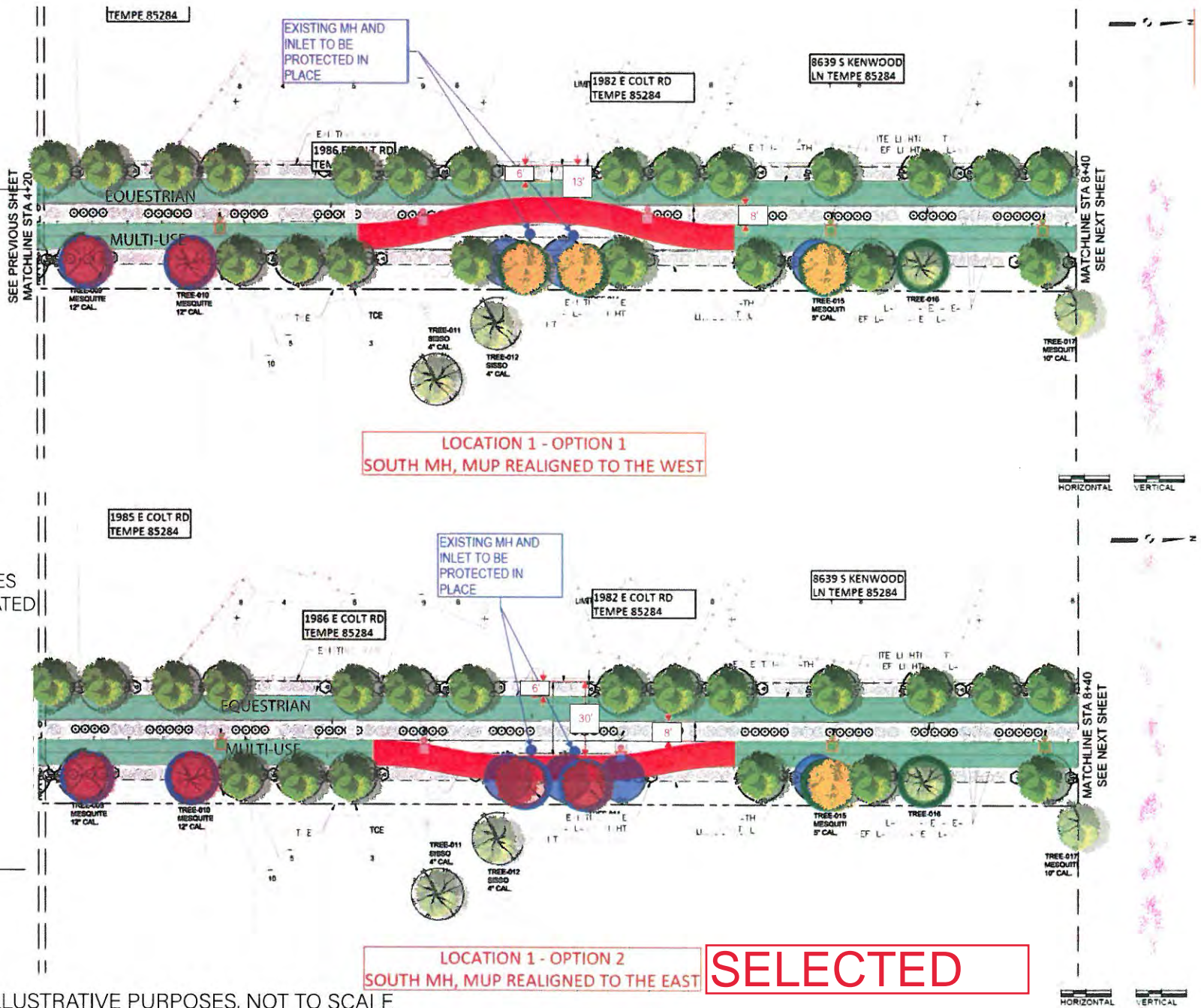

GRAPHIC SYMBOLY FOR ILLUSTRATIVE PURPOSES, NOT TO SCALE

LEGEND

-  NEW TREE
-  EXISTING TREE
-  TREE PREVIOUSLY CALLED OUT FOR REMOVAL NOW PROTECTED IN PLACE
-  EXISTING TREE TO BE REMOVED
-  PROPOSED NEW TREES THAT CAN BE RELOCATED WHERE FEASIBLE
-  10' WIDE Path Realignment
-  10' WIDE Path Per Plans
-  Path Light Fixture Per Plan
-  Path Light Fixture Location Adjusted

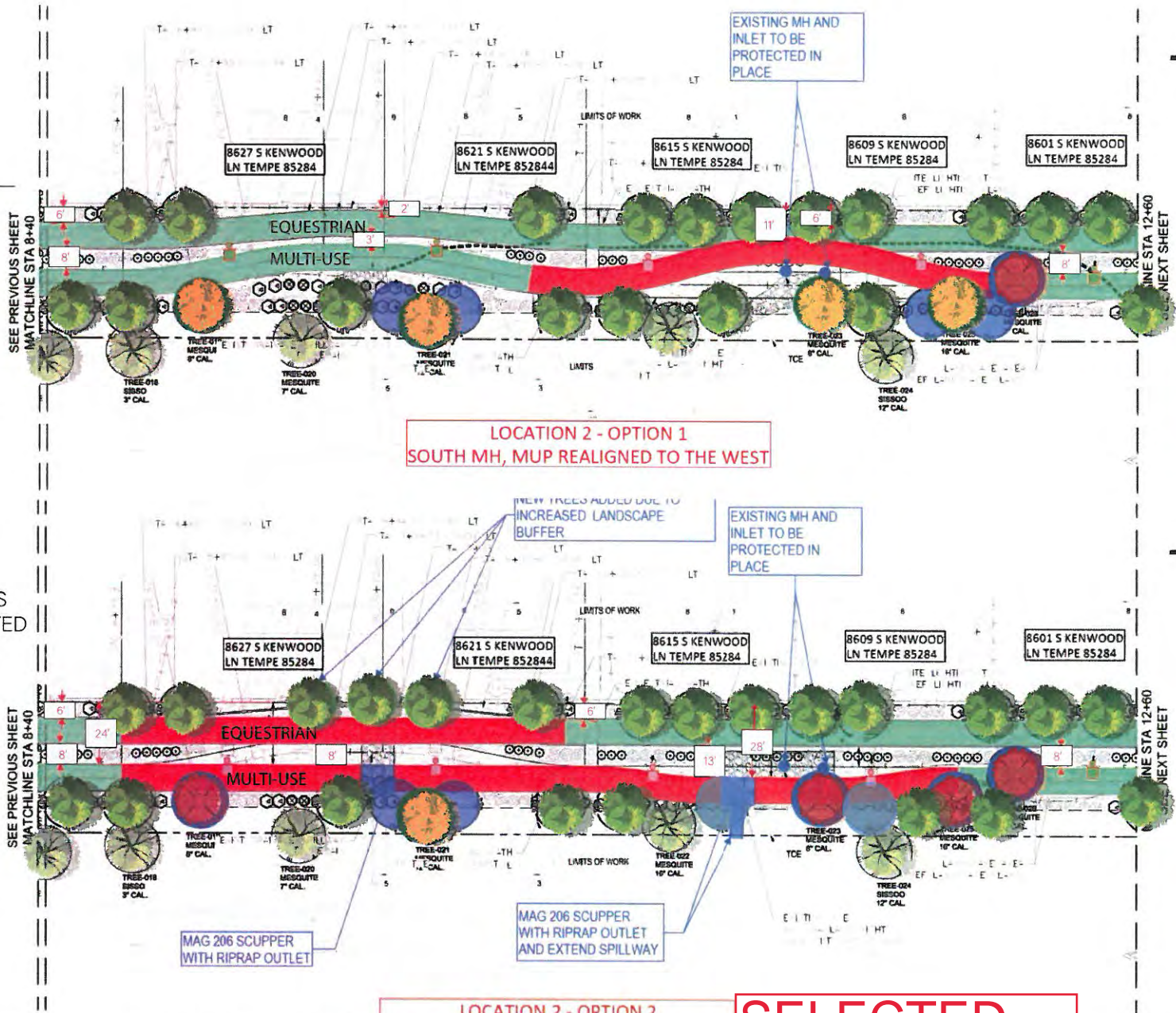

GRAPHIC SYMBOLGY FOR ILLUSTRATIVE PURPOSES, NOT TO SCALE

HORIZONTAL VERTICAL

LEGEND

-  NEW TREE
-  EXISTING TREE
-  TREE PREVIOUSLY CALLED OUT FOR REMOVAL NOW PROTECTED IN PLACE
-  EXISTING TREE TO BE REMOVED
-  PROPOSED NEW TREES THAT CAN BE RELOCATED WHERE FEASIBLE
-  10' WIDE Path Realignment
-  10' WIDE Path Per Plans
-  Path Light Fixture Per Plan
-  Path Light Fixture Location Adjusted

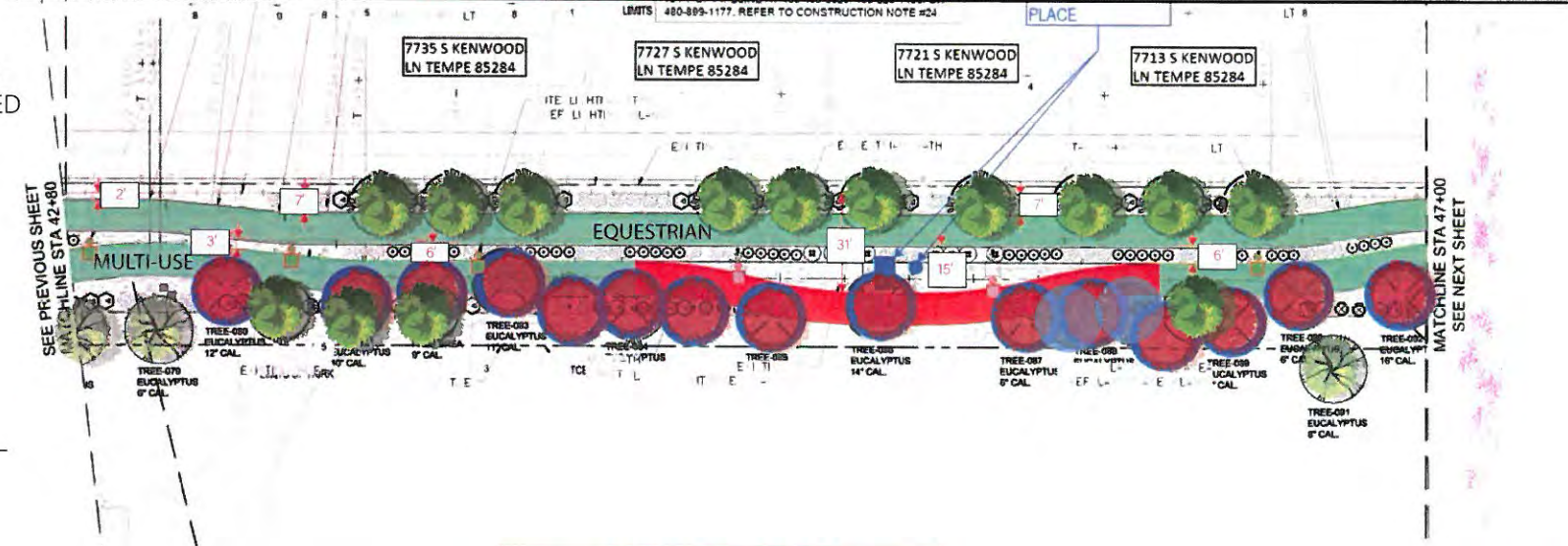
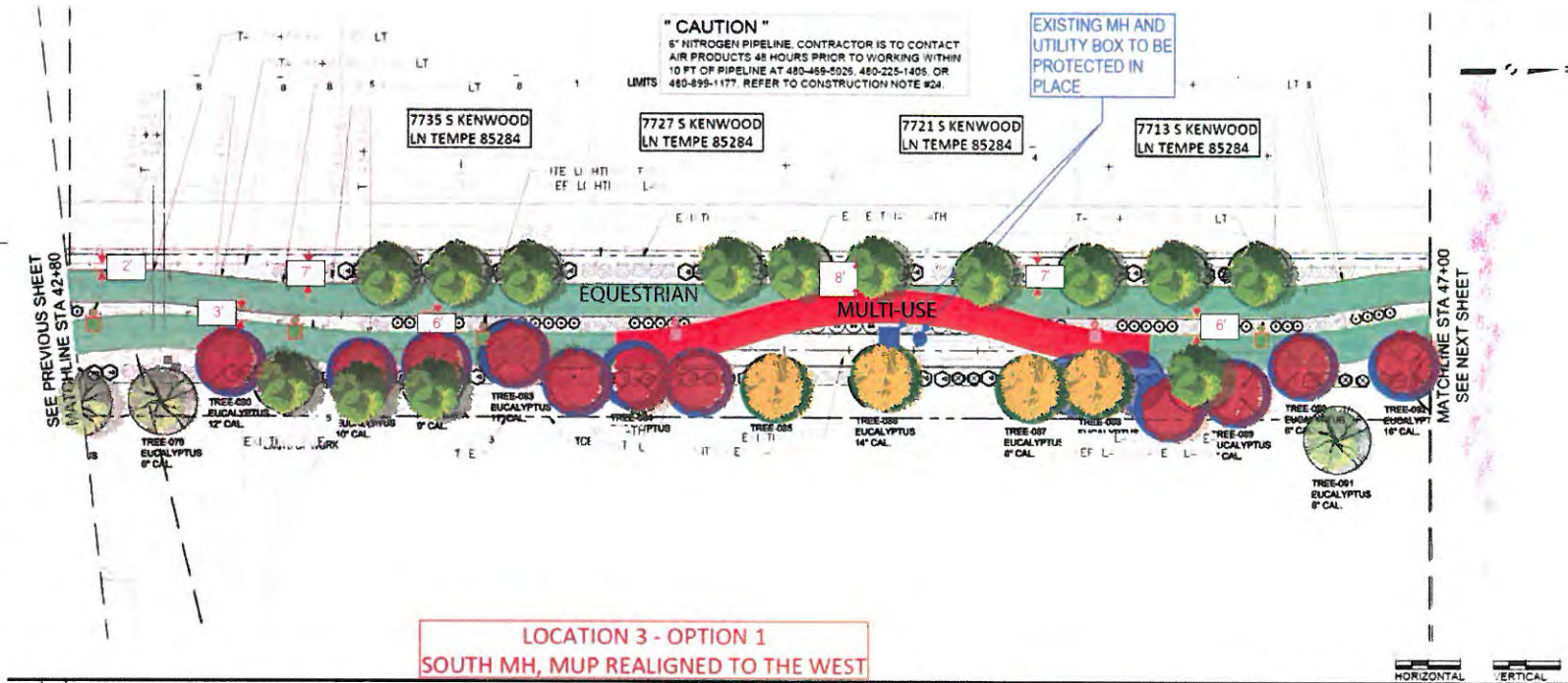

GRAPHIC SYMBOLY FOR ILLUSTRATIVE PURPOSES, NOT TO SCALE