



---

Community Development Department  
31 E 5<sup>th</sup> St.  
Tempe, Arizona 85281

480-350-8341  
480-350-8677 (fax)  
[www.tempe.gov](http://www.tempe.gov)

# **Residential**

# **Patio Cover to**

# **Livable**



Community Development Department  
31 E 5<sup>th</sup> St.  
Tempe, Arizona 85281

480-350-8341  
480-350-8677 (fax)  
[www.tempe.gov](http://www.tempe.gov)

### **PATIO COVER CONVERSION TO LIVING AREA**

**Building Permit Required:** The Tempe Administrative Code as adopted by the City of Tempe requires that a building permit be obtained before converting a patio cover to living area.

#### **Building Permit Requirements:**

##### **Permit Application**

Completed applications must include:

- |  |   |
|--|---|
| <input type="checkbox"/> Project name and address          | <input type="checkbox"/> Proposed “use” of area           |
| <input type="checkbox"/> Applicant’s name and phone number | <input type="checkbox"/> Estimated/actual cost of project |
| <input type="checkbox"/> Description of work               | <input type="checkbox"/> Applicant’s signature            |

##### **Construction Plans (See examples)**

Two (2) sets of plans provided by applicant must include:

Examples with fill-in information may be used as some of the required plan sheets.

Site Plan (dimensioned) 8-1/2” x 11” copy: Show the existing location, size and setbacks and reference to existing site specifics, i.e., property lines, existing residence, pool, etc.

Floor plan (dimensioned): Show overall building size, existing and proposed room locations, existing and proposed new window(s)/door(s) size/location(s). Note proposed electrical outlet(s)/light(s) and mechanical locations.

Sections/Details: Show the existing walls, columns, beams and the proposed new walls specifying materials and existing roof framing system/roof slope.

Removal of existing columns and/or beams will require additional Construction Drawings providing any/all structural details and connections, i.e., footing type/size/depth, wall to footing connection and wall size/type for plan review.

##### **General Requirements**

1. Any habitable room over 70 square feet in size which is used for living, sleeping, eating or cooking must be provided with a means of supplying heating in accordance with IRC, Section R303.8.
2. All habitable rooms as defined above shall have receptacles installed per the Tempe Electric Code. Generally this means that receptacles must be spaced along all walls lines no further than 12’ on center. Circuits feeding the receptacles in bedrooms shall be protected by an AFCI circuit breaker.
3. Natural lighting and ventilation must be provided in the new habitable spaces and must be maintained in any adjacent spaces as required by IRC, Section R303.1. Generally this may be accomplished through the installation of additional windows, skylights, wall removal, and artificial means.
4. Required egress from existing bedrooms may not be limited. Such egress must be directly to the outside and must be at least 5.7 square feet (grade floor openings maybe 5.0 square feet) with a minimum height of 24” and minimum width of 20”. Sill height shall be no higher than 44”.



Community Development Department  
31 E 5<sup>th</sup> St.  
Tempe, Arizona 85281

480-350-8341  
480-350-8677 (fax)  
[www.tempe.gov](http://www.tempe.gov)

5. Gas water heaters and gas furnaces may not be located in a bedroom or bedroom closet.
6. Smoke detectors shall be installed in each bedroom, outside of each bedroom, and on each level as required by IRC, Section R313.1; this includes all existing and new bedrooms.
7. An Arizona registered architect or engineer must prepare the plans for:
  - a. Basements
  - b. Beam spans over 20 feet in length
  - c. Headers over large openings
  - d. 2<sup>nd</sup> story additions
  - e. Rafters and/or joists that do not comply with the IRC span tables
  - f. Manufactured roof or floor trusses
  - g. Other structural components as determined by the plan reviewer

Plans requiring a structural plan review are not eligible for “Over the Counter” review and therefore must be submitted and queued into our standard review process.

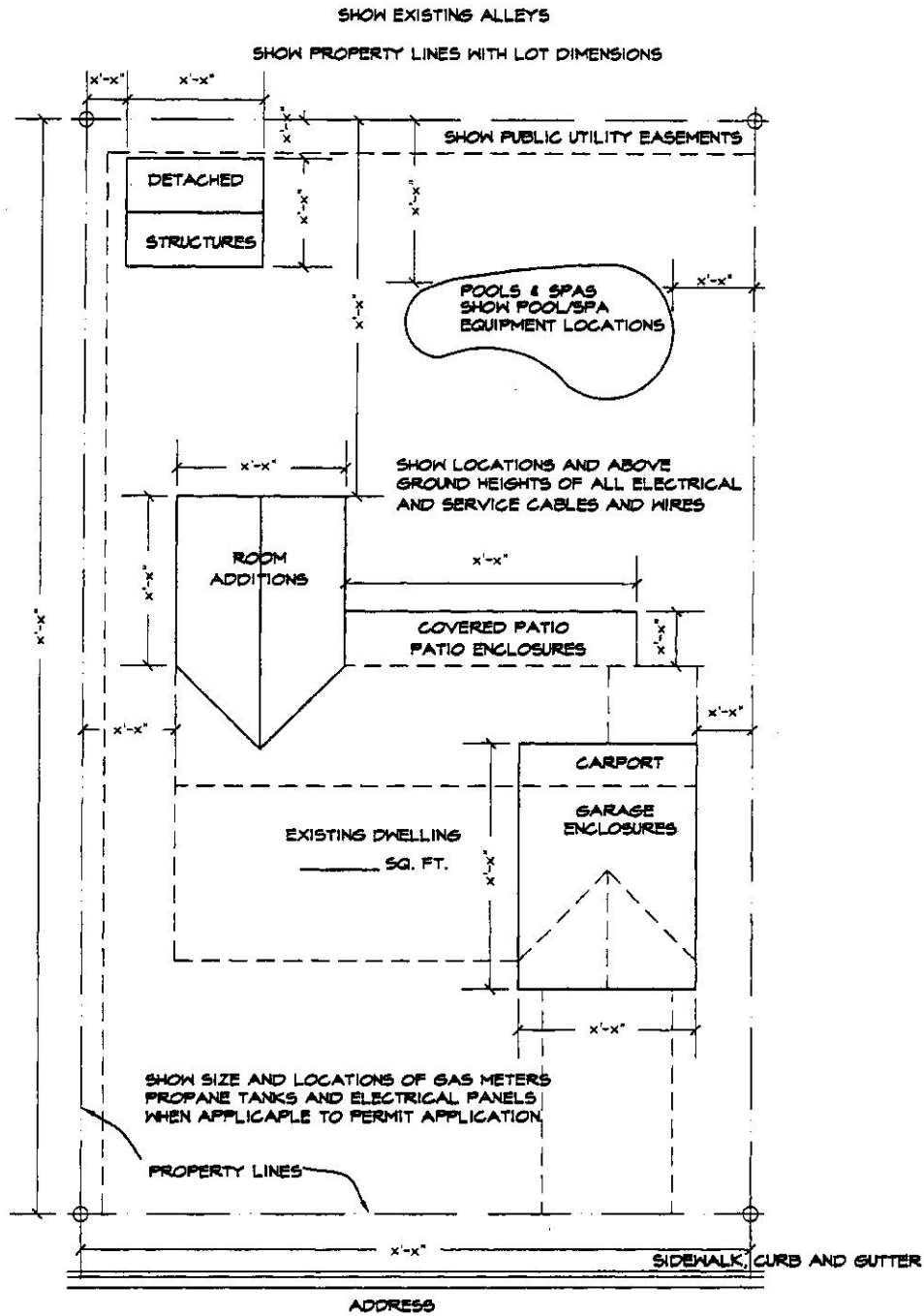

- GIVE DIMENSIONS REPRESENTED BY x'-x" WHEN APPLICABLE TO PERMIT APPLICATION
- SHOW SIZE AND LOCATIONS OF ALL EXISTING STRUCTURES, POOLS AND SPAS
- SHOW SIZE AND LOCATION OF OFF STREET PARKING WHEN GARAGE/ CARPORT IS ENCLOSED INTO LIVABLE AREA



SCALE \_\_\_\_\_' = \_\_\_\_\_'

For Reference Only

## Residential Structures (Example)

Title

Site Plan

Sheet No.

RES - 01

NORTH

SCALE \_\_\_\_\_' = \_\_\_\_\_'

**Residential Structures**

Title

Site Plan

Sheet No.

RES - 02

LIVING

IDENTIFY ALL ADJACENT  
AREAS AND ANY  
OPENINGS INTO  
PROPOSED ENCLOSURE

EXISTING SHOWN DASHED

12'-0" MAXIMUM

6'  
MAX

DOOR U-FACTOR \_\_\_\_\_  
WINDOW(S) U-FACTOR \_\_\_\_\_  
SHGC \_\_\_\_\_

1  
DSD-04

EXISTING OR NEW LIGHT

EXISTING OR NEW LIGHT

EXISTING POSTS AND  
BEAMS TO REMAIN  
(TYPICAL)

SEE DSD-07 FOR  
SPECIAL CONDITIONS

DOOR SIZE/TYRE

WINDOW SIZE/TYRE

36" X 36"  
CONCRETE  
LANDING

WP GFCI

x'-x"

x'-x"

x'-x"

- SHOW DIMENSIONS REPRESENTED BY X'-X"
- SEE SHEET RES - 01 FOR SITE PLAN REQUIREMENTS
- ON SITE PLAN SHOW LOCATION OF REQUIRED OFF-STREET PARKING

For Reference Only

# Patio Cover to Living Area

Title

Floor Plan

Sheet No.

DSD - 03

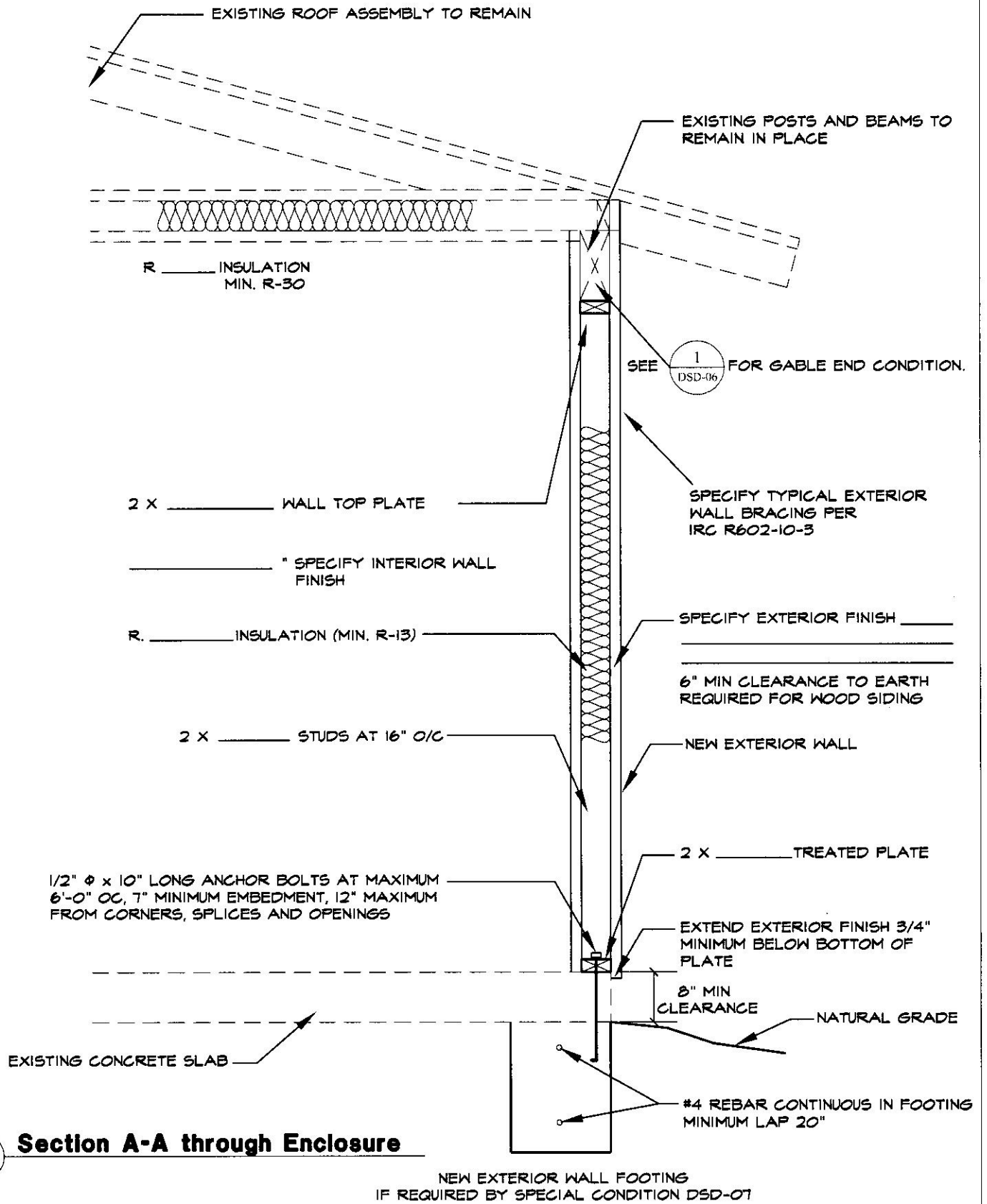

**1 Section A-A through Enclosure**

For Reference Only

**Patio Cover to Living Area**

Title

**Typical Wall Section**

Sheet No.

**DSD - 04**

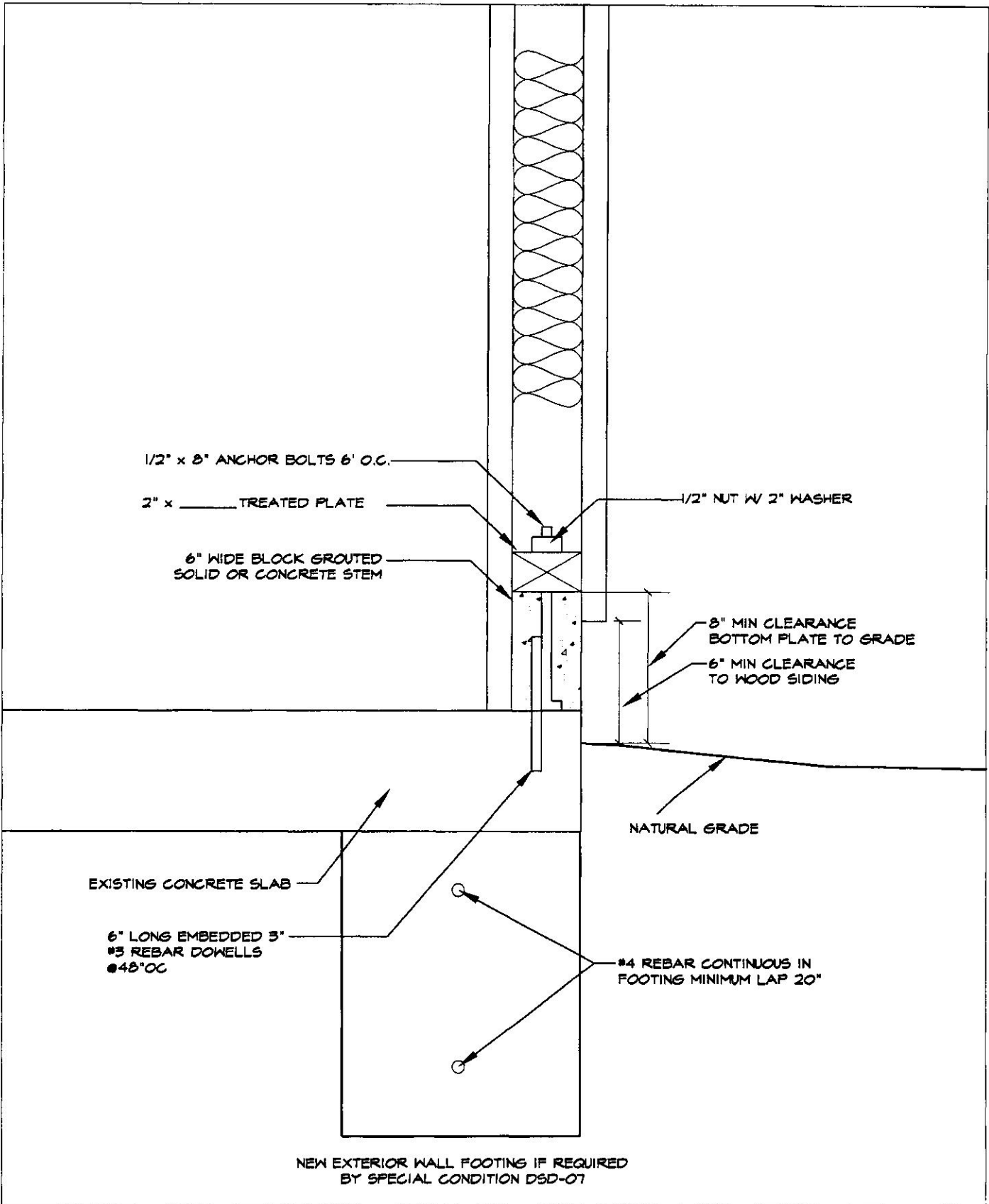

For Reference Only

# Patio Cover to Living Area

Title

Alternate Stem Detail

Sheet No.

DSD - 05



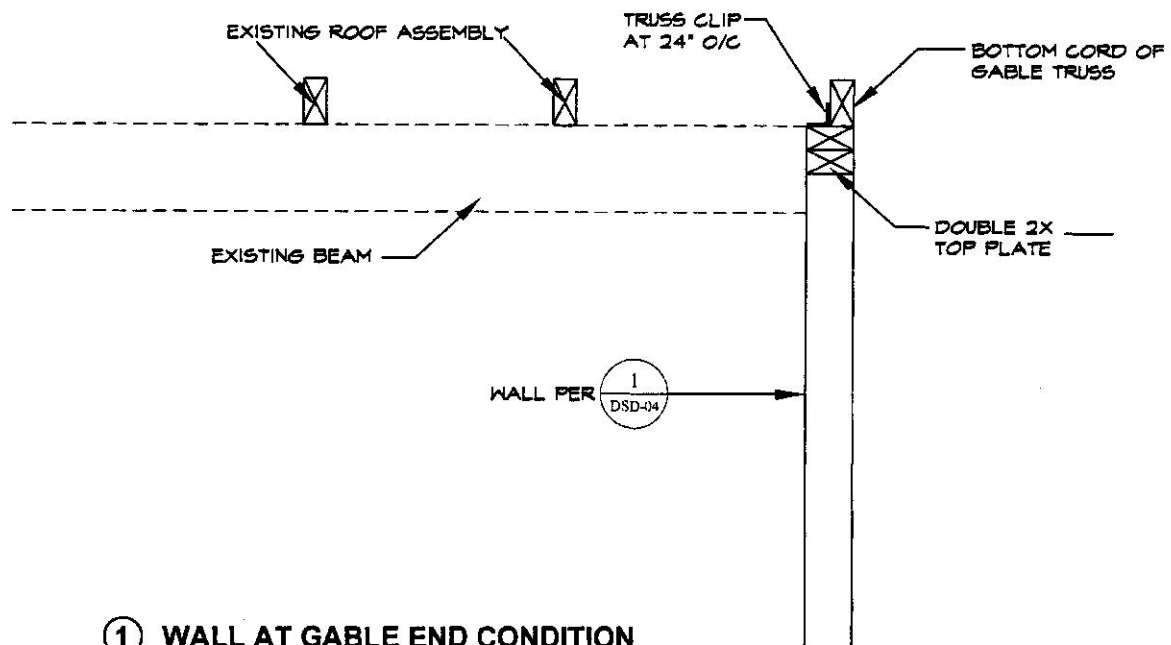

For Reference Only

# Patio Cover to Living Area

Title

Alternate Details

Sheet No.

DSD - 06

A FOOTING AND WALL BRACING IS REQUIRED  
ALONG THE HATCHED WALL LINE

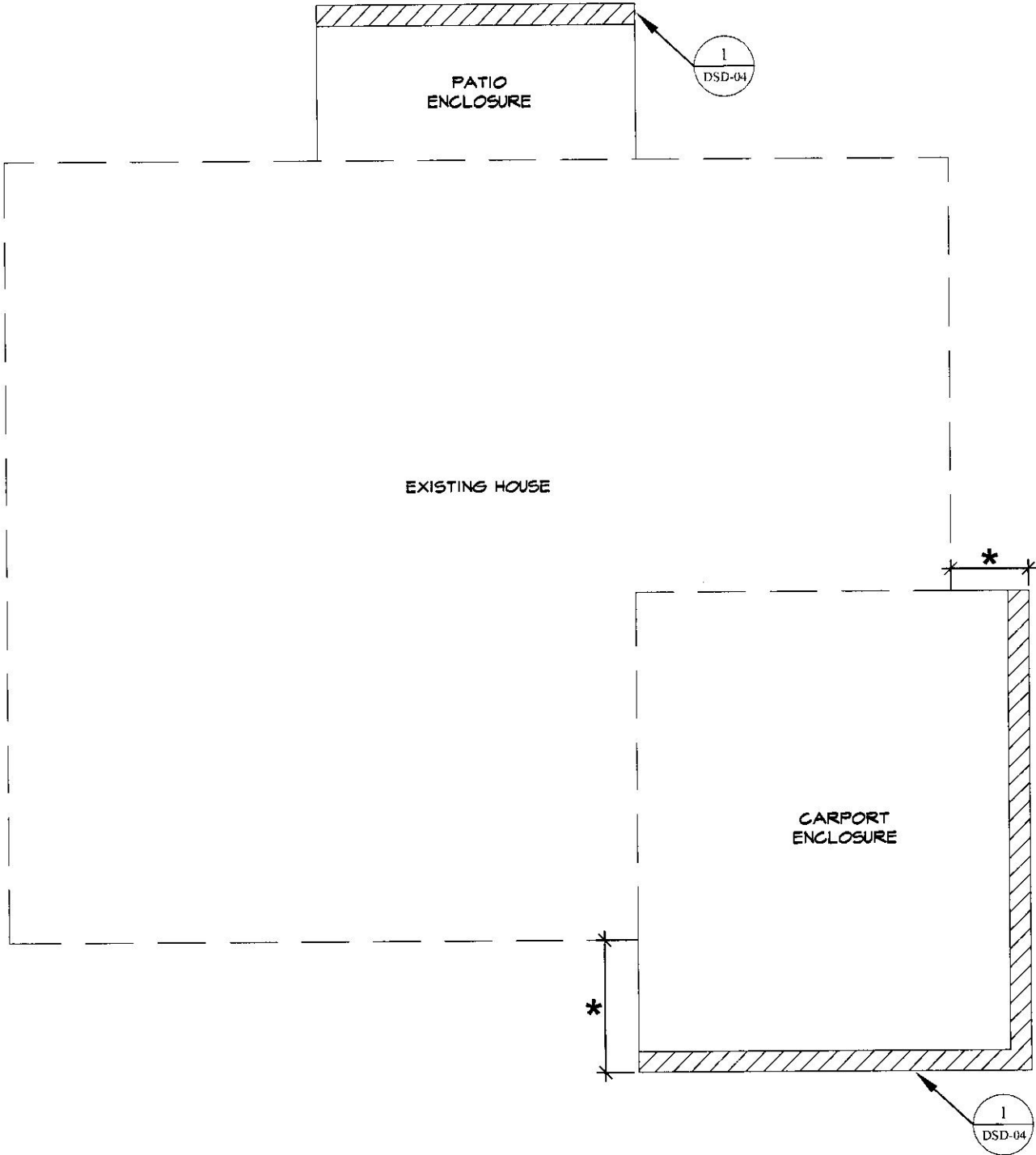

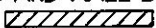
\* IF THIS DIMENSION IS GREATER THAN 4', A FOOTING AND WALL BRACING WILL  
BE REQUIRED AS INDICATED ALONG THE HATCHED  WALL LINES.

For Reference Only

# Patio Cover to Living Area

Title

Special Conditions

Sheet No.

DSD - 07