

5th Street

Streetscape & Traffic Calming Project

Project Update | Spring 2017



Project Limits & Context



- Approximately ½ mile (2,900 ft)
- Connects City Hall, Mill Ave, ASU, Sun Devil Stadium, police admin and courts, Transportation Center, lightrail, transit services, mixed-use development, multi-family housing, hotels, Hayden Butte/A Mountain, historic and redeveloping neighborhoods

Design Goals

- Increase **on-street parking** opportunities and associated revenues
- Enhance **multi-modalism** (improve bike, ped, transit & ADA)
- Utilize **innovative transportation design** (NACTO)
- Maintain vehicular & **special event** access & integrate **traffic calming**
- Expand & improve **landscape & shade** options, particularly tree coverage
- Address **heat island & user comfort**, utilize **Low Impact Development** techniques where appropriate (water harvesting, solar)
- Preserve **utility operations** and allow for future growth
- Balance **design with cost control & long term maintenance**
- Connect to **neighborhoods**, protect & create **gateways/transitions**
- Create innovative, sustainable, iconic street with **mobility for all**

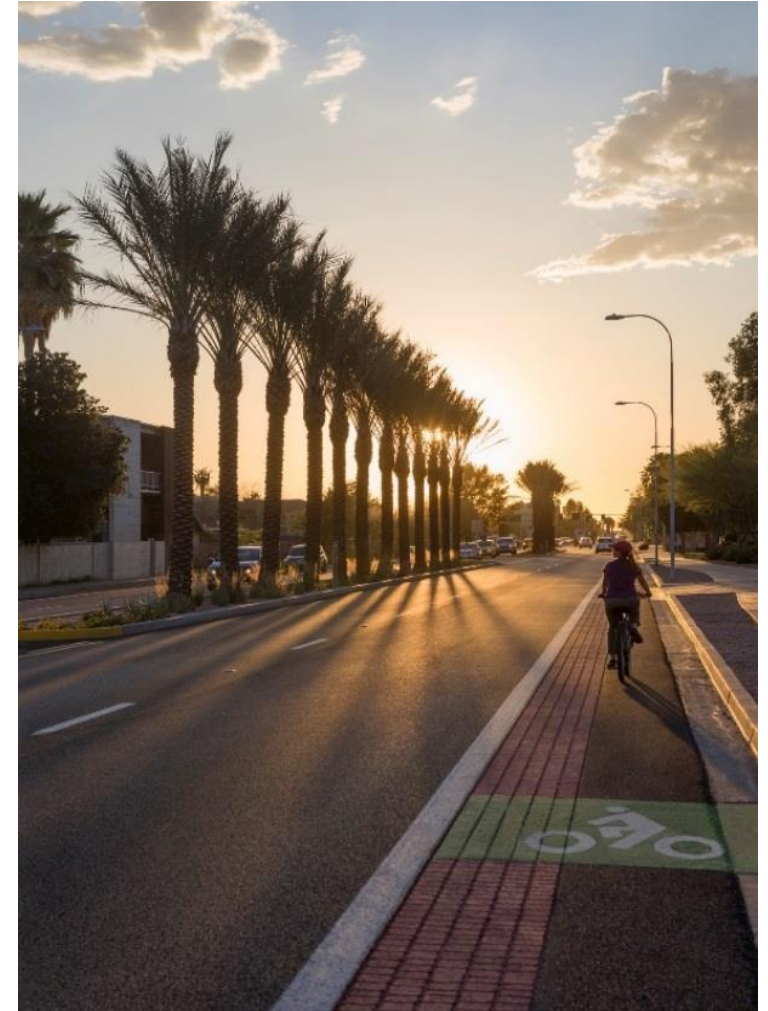

Preliminary Concepts

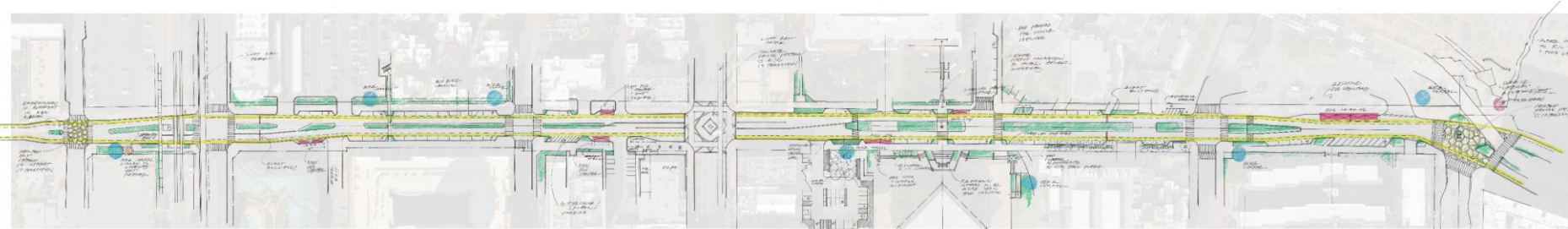

Tempe 5th Street Enhancement - Option A1 - Median/City Hall Plaza
January 17, 2017, DGD/Davis Sketch

Median/City Hall Plaza

Wide street, landscaped,
parallel parking

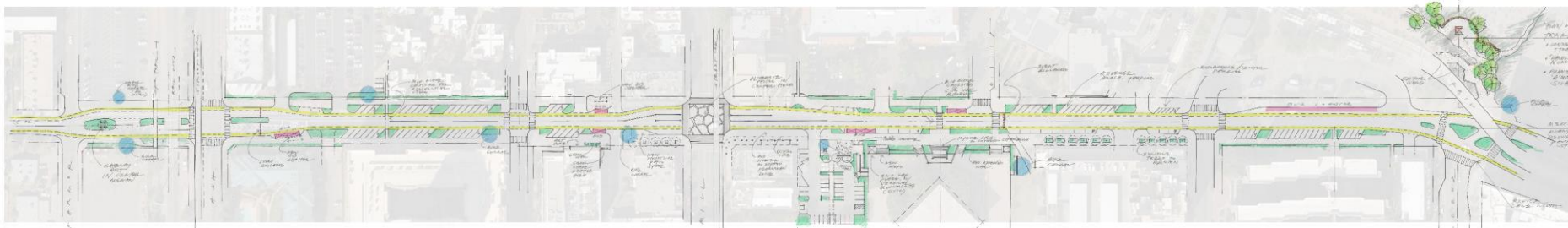

Tempe 5th Street Enhancement - Option B1 - Skinny Street/No Median
January 17, 2017, DGD/Davis Sketch

Skinny Street/No Median

Skinny street, bikes have a
more straight and visible path

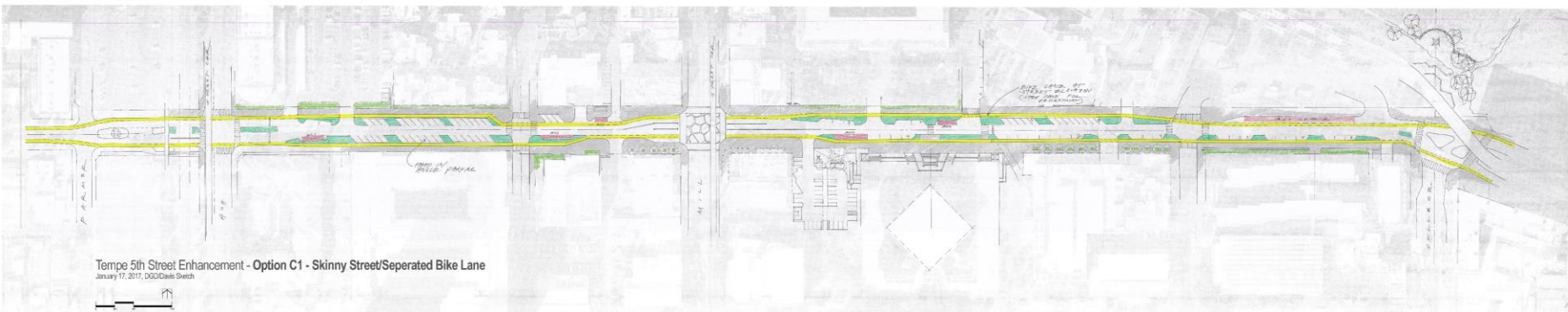

Tempe 5th Street Enhancement - Option C1 - Skinny Street/Seperated Bike Lane
January 17, 2017, DGD/Davis Sketch

Skinny Street/ Seperated Bike Lane

Skinny street, bikes meander
behind parking stalls and
through intersections

Stakeholder Input

- Public Meeting (Oct. 2016)
- Commissions
 - Transportation, Sustainability, Historic Preservation, Mayor's Commission on Disability Concerns, Municipal Arts, Parks
- Departments
 - Police, Fire, Refuse, Utilities, Community Development
- Community
 - ASU, SRP, Mission Palms, DTA, Farmer Arts District, Studio 5c, Businesses and Property Owners

Highlights & Takeaways

- Recognize gateway/monument opportunities at key intersections
- Increase street parking, but not at the expense of good people space
- Maintain capacity but slow traffic
- Expand pedestrian space on sidewalk for patio overflow
- Capture water runoff, utilize in landscape features
- Increase Shade
- Provide a flexible street for daily use as well as event/gathering opportunities
- Enhance bike and pedestrian visibility

Stakeholder Input

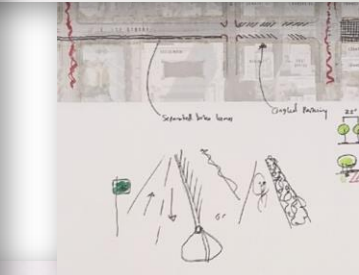
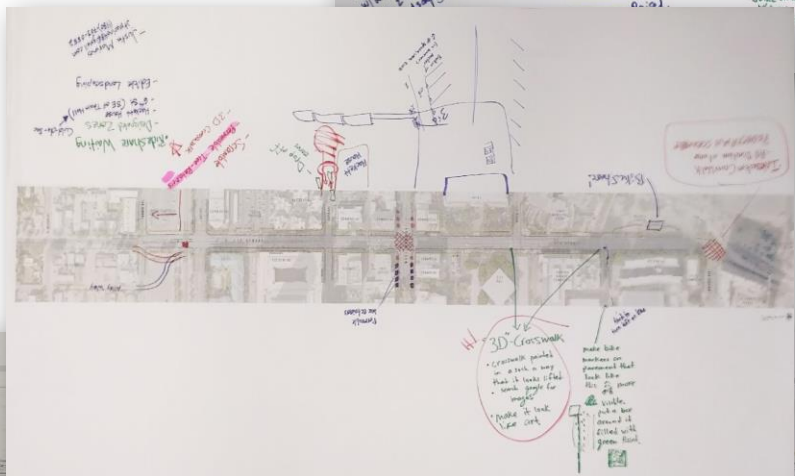
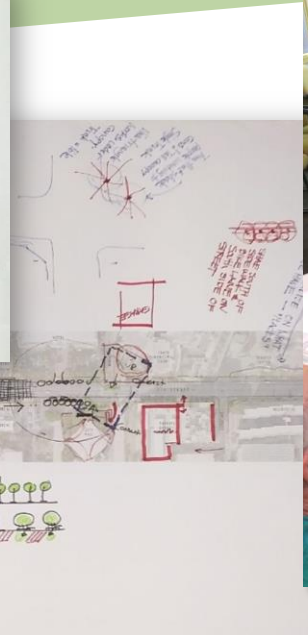
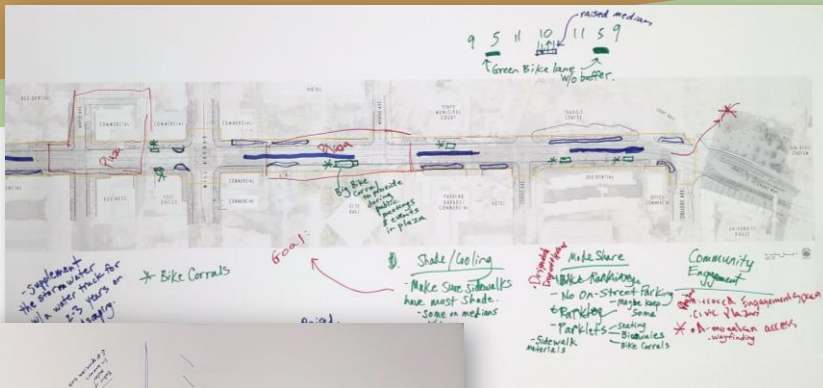

Community planning charrette at ASU School of Sustainability

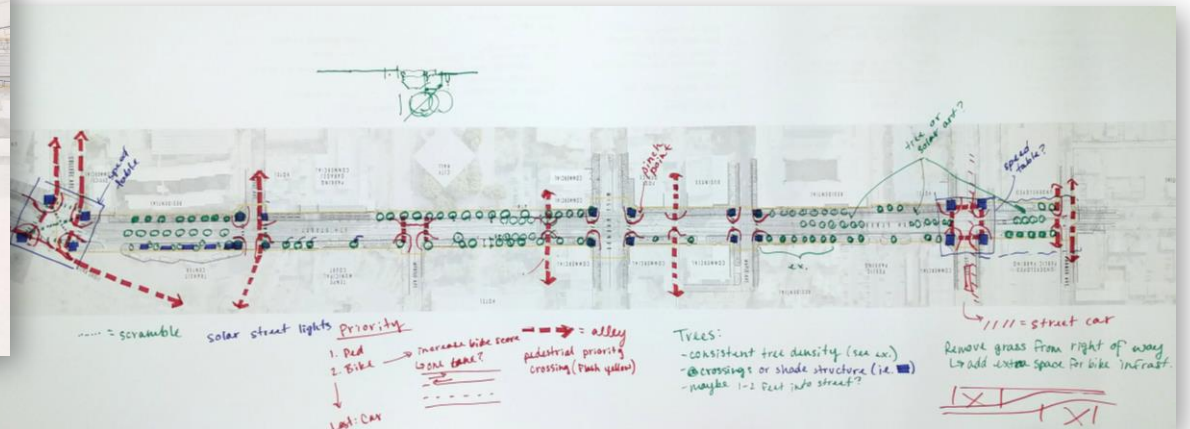
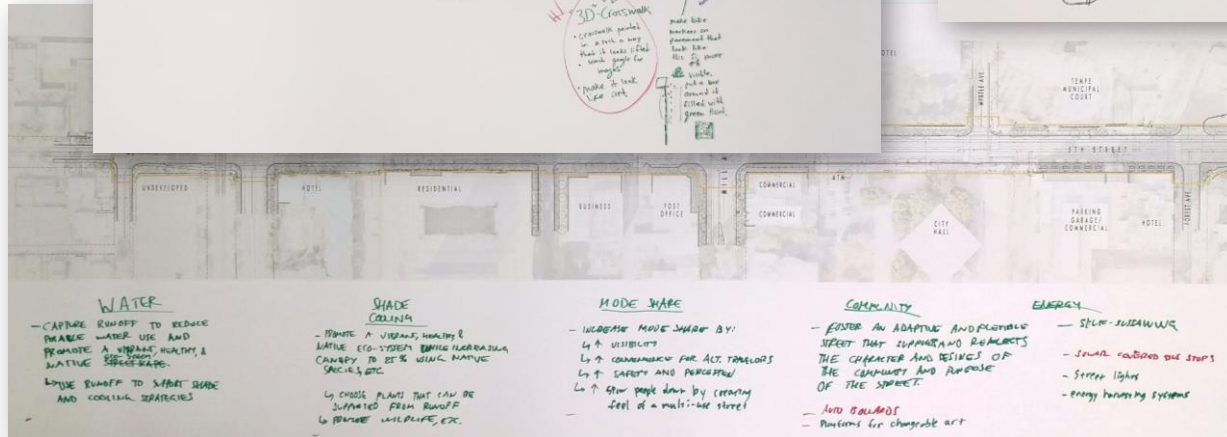

WATER
 - CAPTURE RUNOFF TO REDUCE PAVEMENT WATER USE AND PROMOTE A HEALTHY, HEALTHY & NATIVE SPECIES.
 ↳ USE RUNOFF TO WATER SHADE AND COOLING STRATEGIES

SHADE COOLING
 - PROMOTE A VIBRANT, HEALTHY & NATIVE ECO-SYSTEMS THROUGH LANDSCAPE CANOPIES TO 25% WITH NATIVE SPECIES, ETC.
 ↳ CHOOSE PLANTS THAT CAN BE IRRIGATED FROM RUNOFF ↳ PROMOTE MULCH, ETC.

MODE SHARE
 - INCREASE MODE SHARE BY:
 ↳ 4+ VELOCITIES
 ↳ 4+ COMMUNITIES FOR ACT. TRAVELERS
 ↳ 4+ SAFETY AND PERCEPTION
 ↳ 4+ GET PEOPLE DOWN BY CREATING FEEL OF A MULTI-USE STREET

COMMUNITY
 - FOSTER AN ADAPTIVE AND FLEXIBLE STREET THAT RESPONDS AND REACTS TO THE CHARACTER AND BEINGS OF THE COMMUNITY AND PURPOSE OF THE STREET.
 - AUTO BALANCING
 - PLATFORMS FOR CHEAPEST ART

ENERGY
 - SELF-IRRADIATING
 - SOLAR COLORED CURB STRIPS
 - STREET LIGHTS
 - ENERGY HARVESTING SYSTEMS

--- = scannable solar street lights
 Priority
 1. Red
 2. Bike
 3. Car
 Last: Car
 ↳ Increase bike count
 ↳ Look back?
 ↳ alley pedestrian priority crossing (pink yellow)
 ↳ 1111 = street car
 ↳ Remove grass from right of way
 ↳ Add extra space for bike infrastr.
 ↳ maybe 1-2 trees into street?
 ↳ Trees:
 - consistent tree density (see ex.)
 - @ crossings or shade structure (ie. ex.)
 - maybe 1-2 trees into street?
 ↳ 1111 = street car
 ↳ Remove grass from right of way
 ↳ Add extra space for bike infrastr.

Preferred Concept

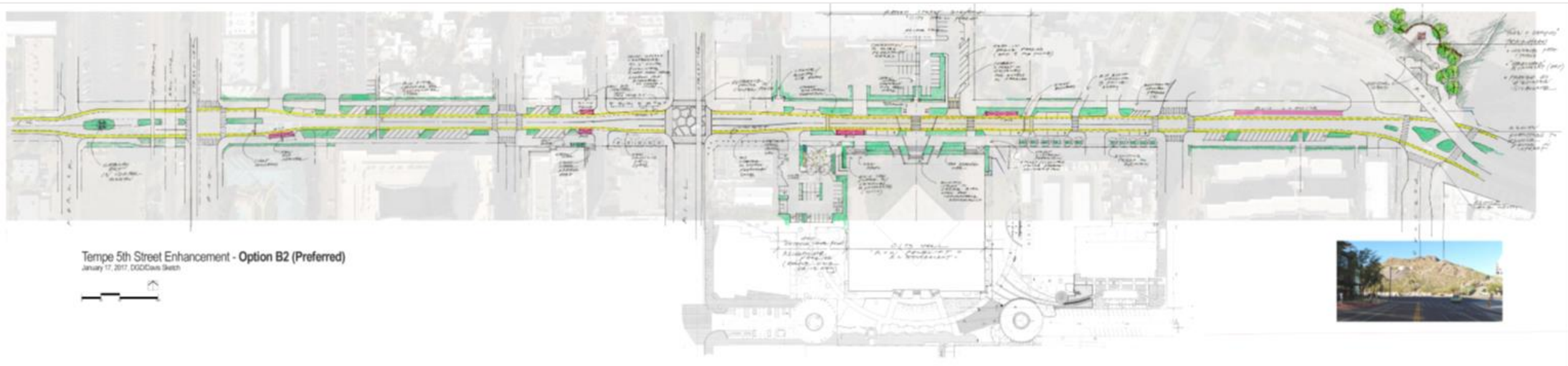

Balanced Street Approach

Focus on supporting an active street that provides for all modes of travel, encouraging engagement, recognizing landmarks and gateways, designed to be sustainable.

Parking increase from 38 to ± 77 metered stalls / Thinner street with more pedestrian-friendly crossings / Continuous, punctuated bike lanes / Introduce "City Hall Plaza" / Consistent lighting strategy / Increased shade and landscaping throughout / Decorative, permeable paving / Gateway treatments to buffer transitions

Walkthrough : Farmer & Ash

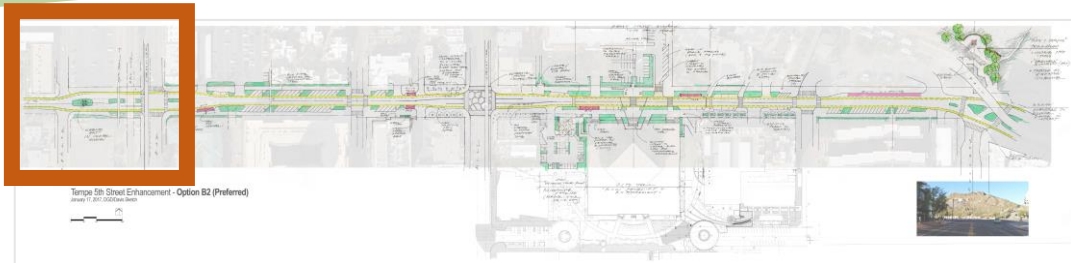

- Neighborhood Transition
- Median Gateway Feature
- Enhanced Street Legibility
- Preserves utility and railroad operations

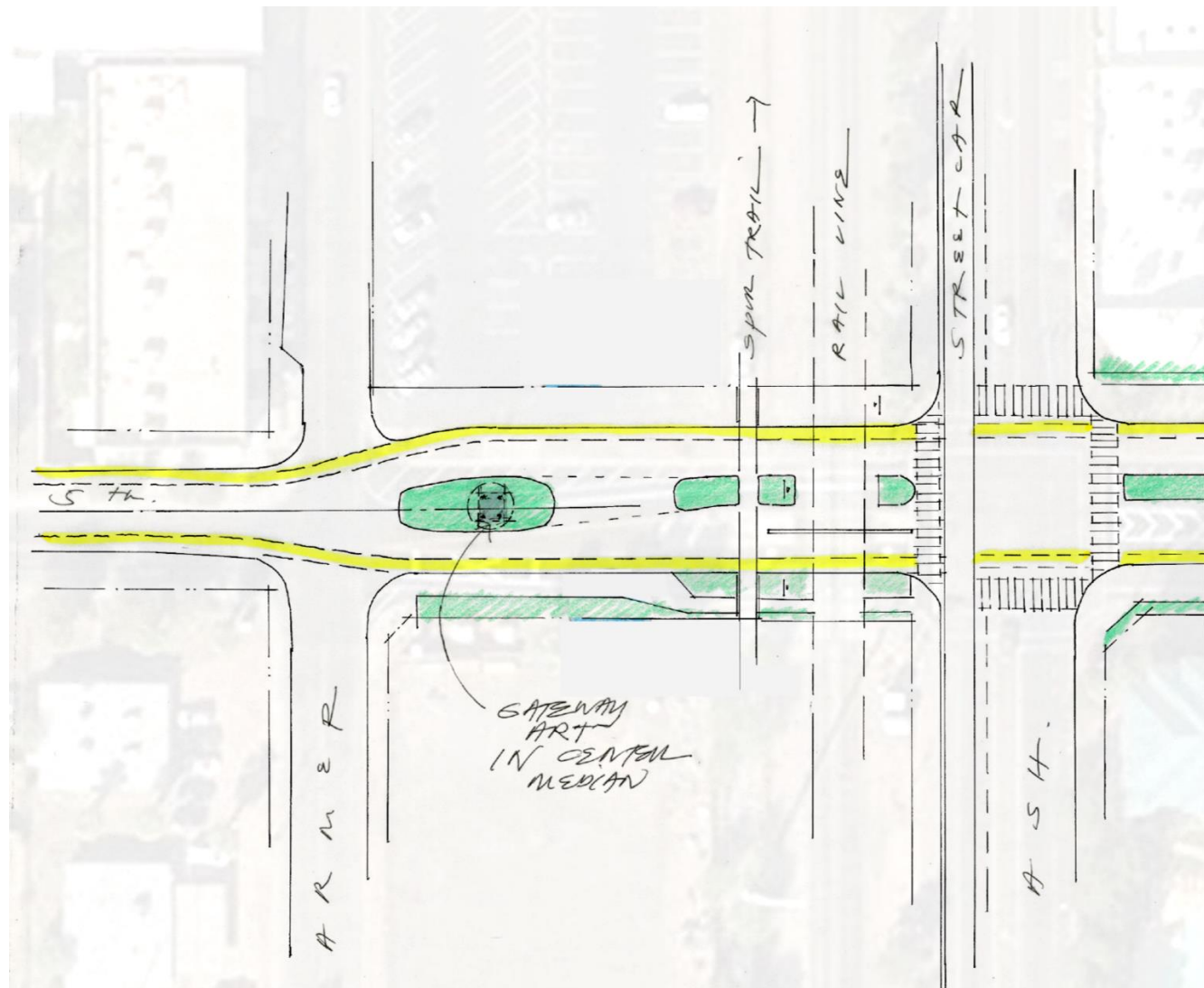

Walkthrough : Ash to Maple

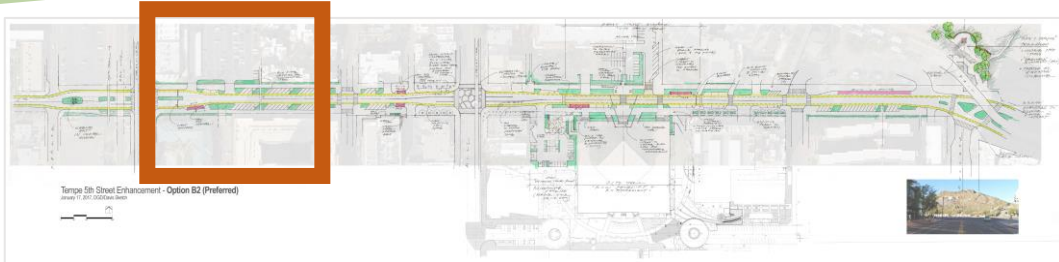

- Introduction of reverse-angle parking
- In-street event bollards for events, traffic control
- Landscape and shade enhancements

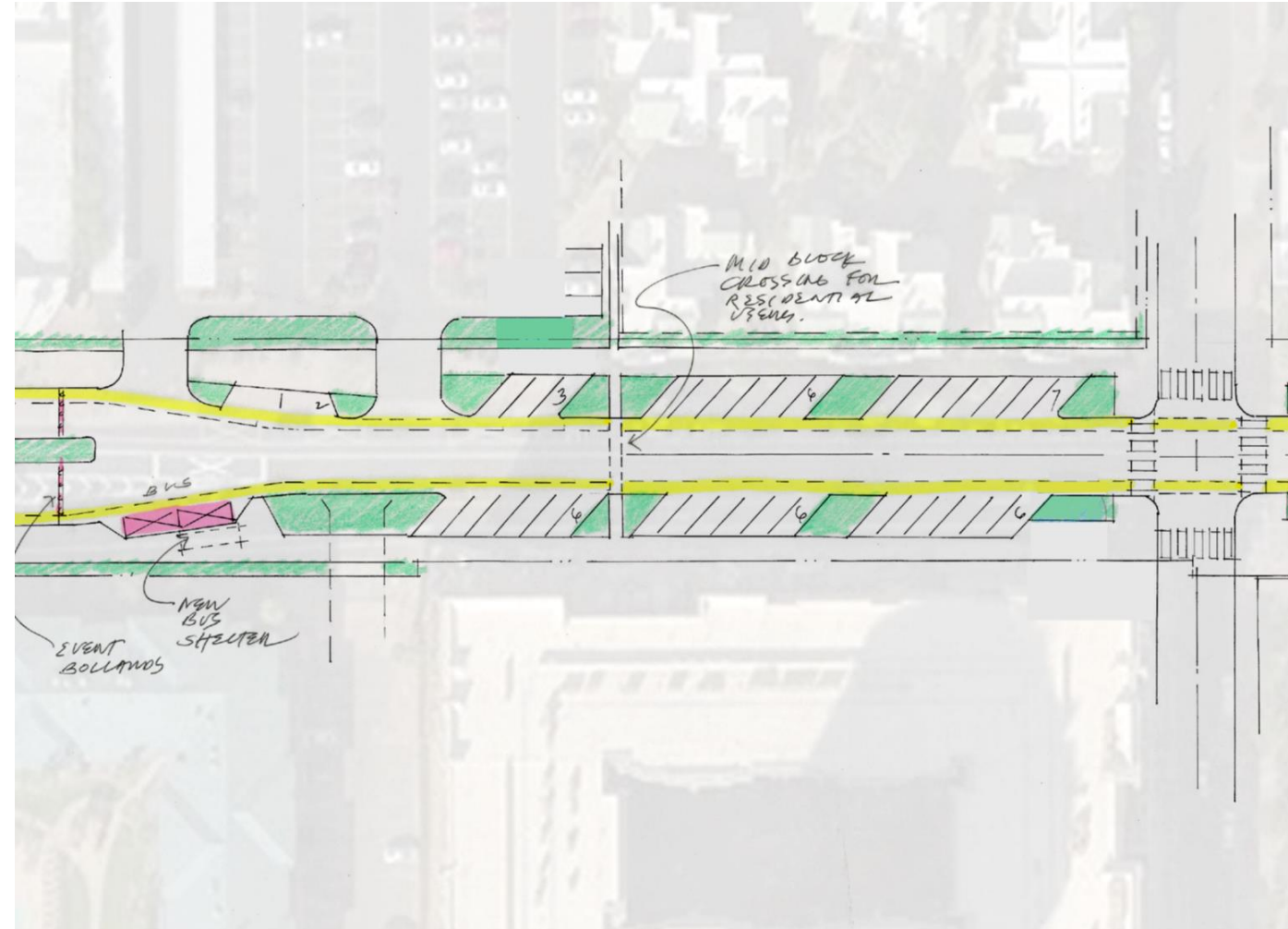

Walkthrough : Mill Ave

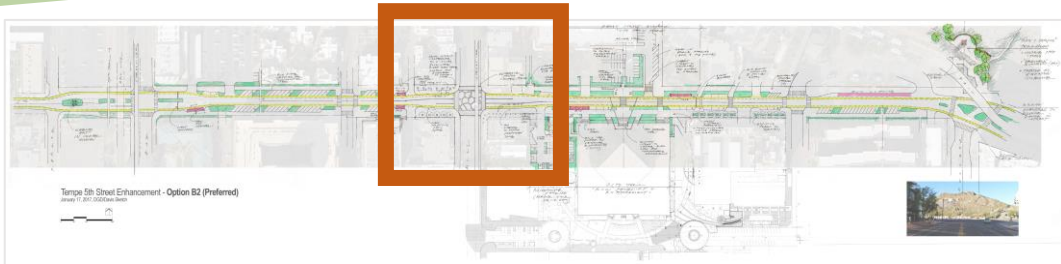

- Extended sidewalks for engaged public space
- Intersection accommodates left turns
- Decorative, functional paving

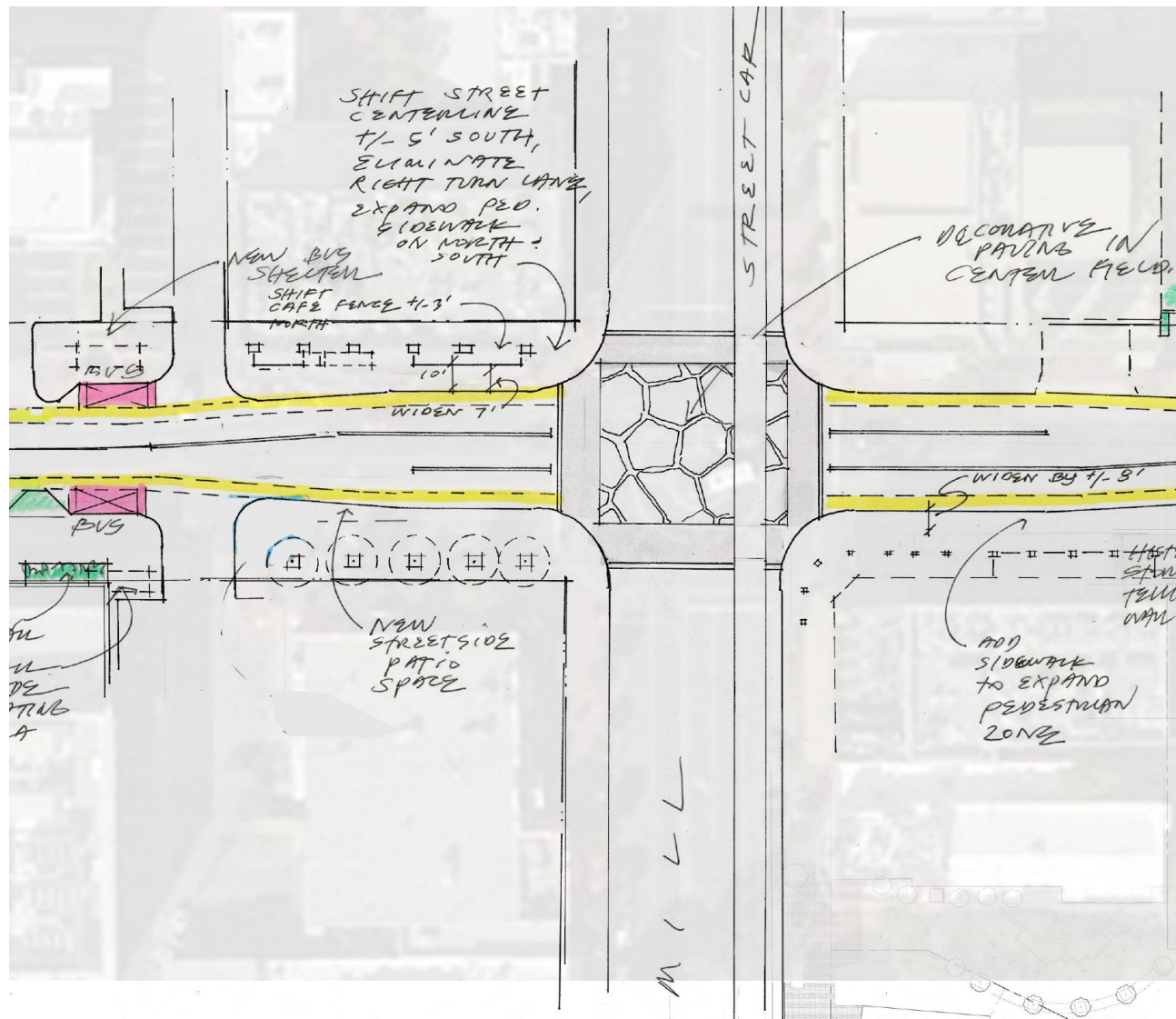
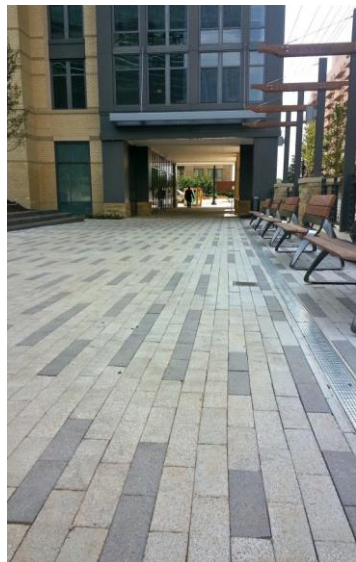

Walkthrough : Mill Ave (Detail)

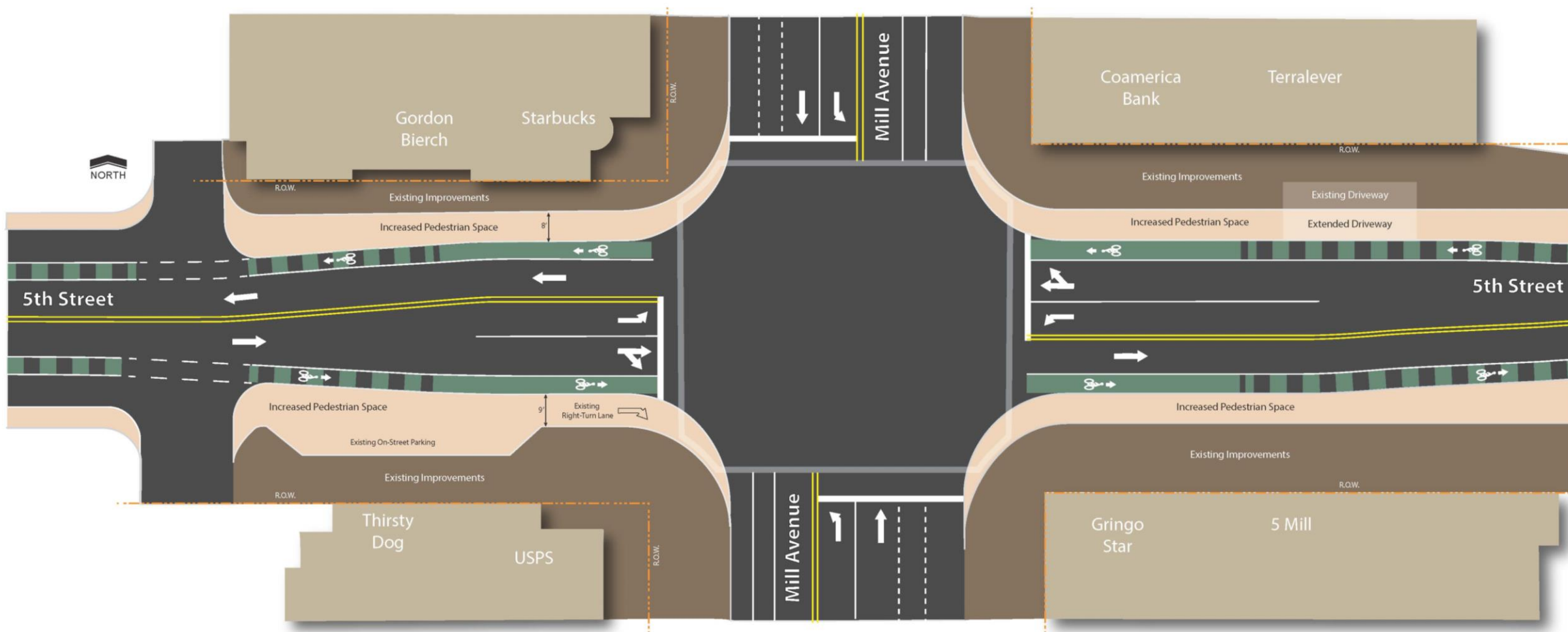

Walkthrough : City Hall Plaza

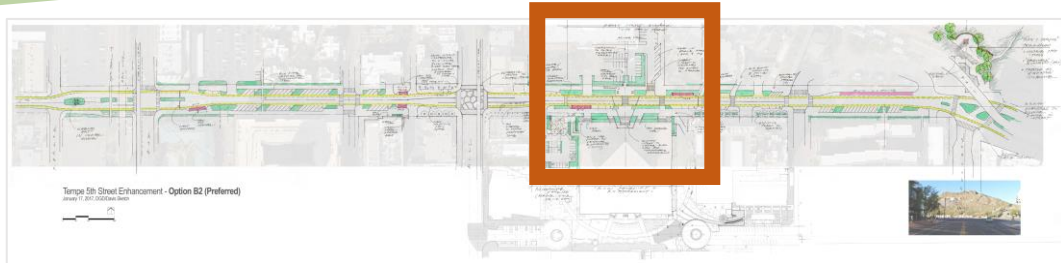

- Elevated street
- Celebrates the civic landmark
- Extends spirit of City Hall into the public realm

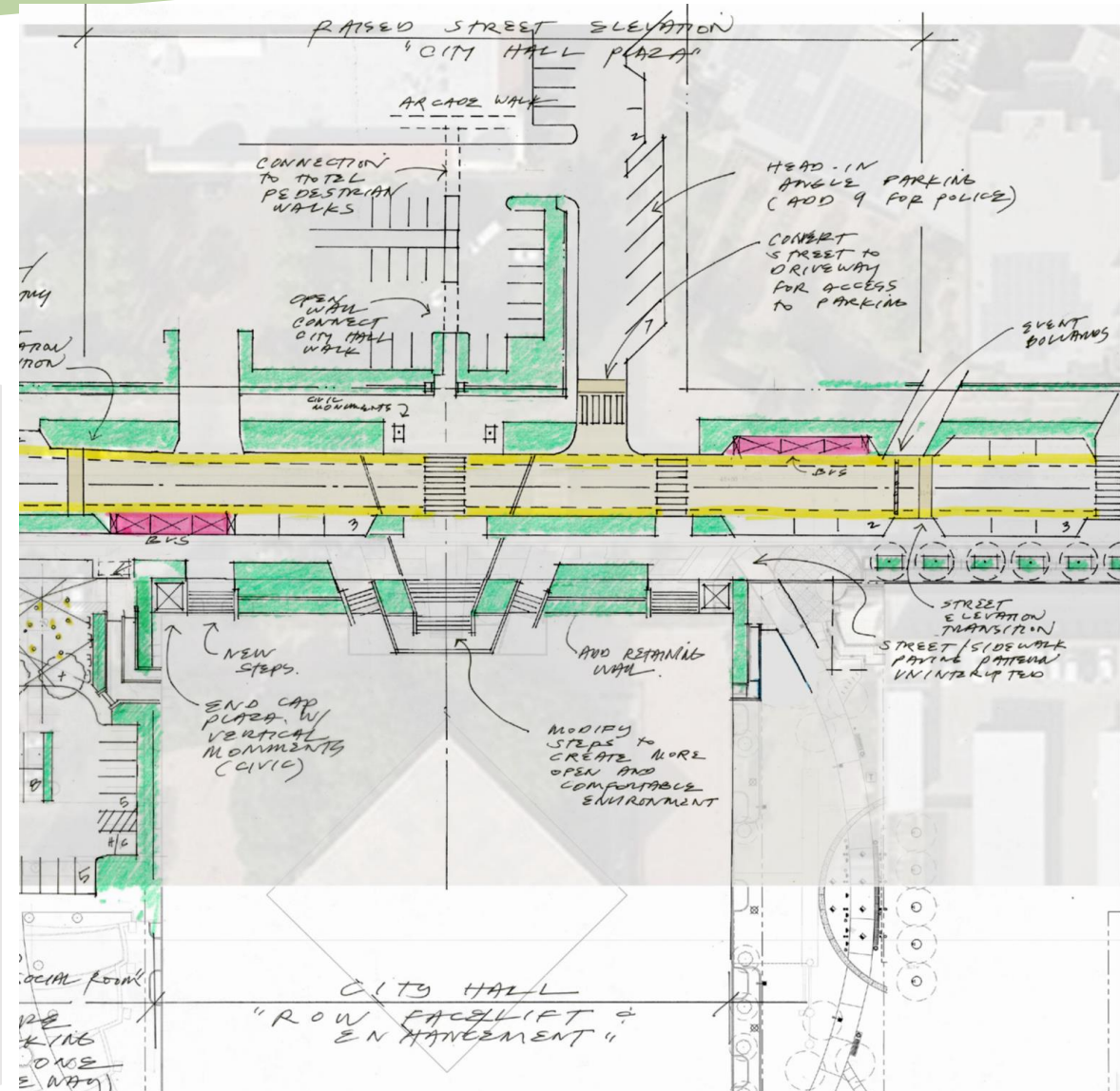

Walkthrough : City Hall Plaza (Detail)

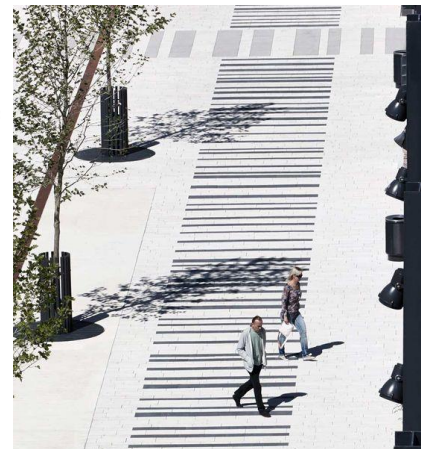
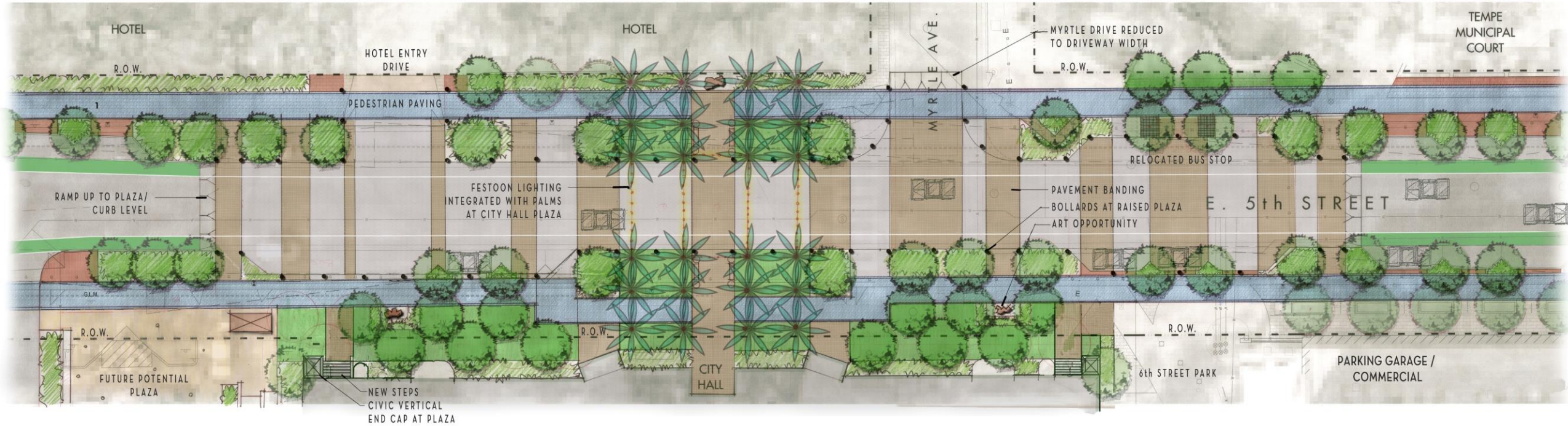

Walkthrough : College Ave

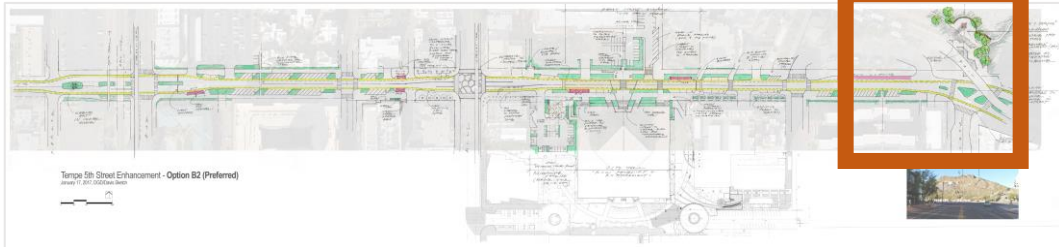

- Town & Campus concept
- Median treatment to frame Hayden Butte
- Trailhead enhancement
- Curb extends to shorten crossing distances

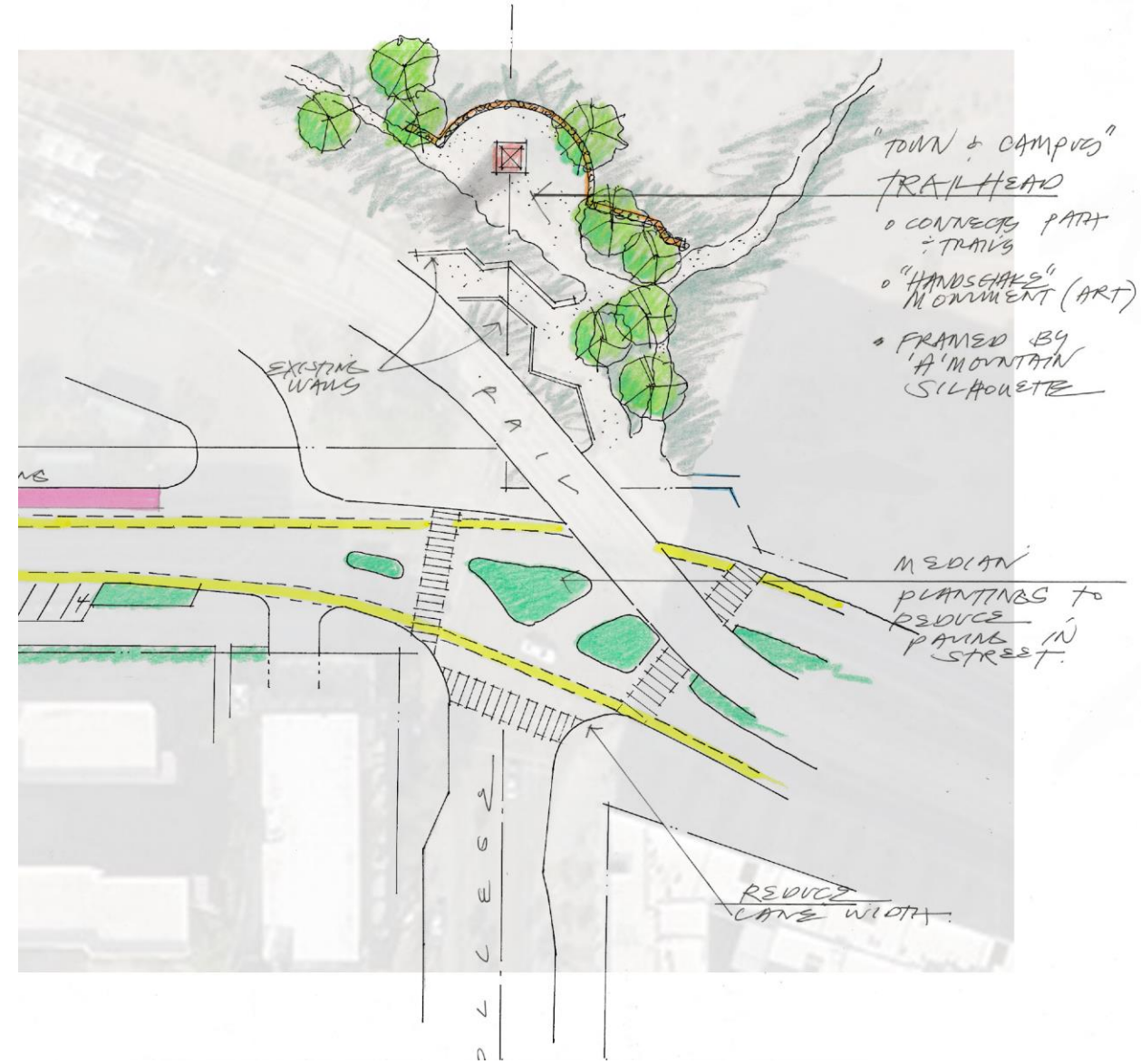

Walkthrough : College Ave (Detail)

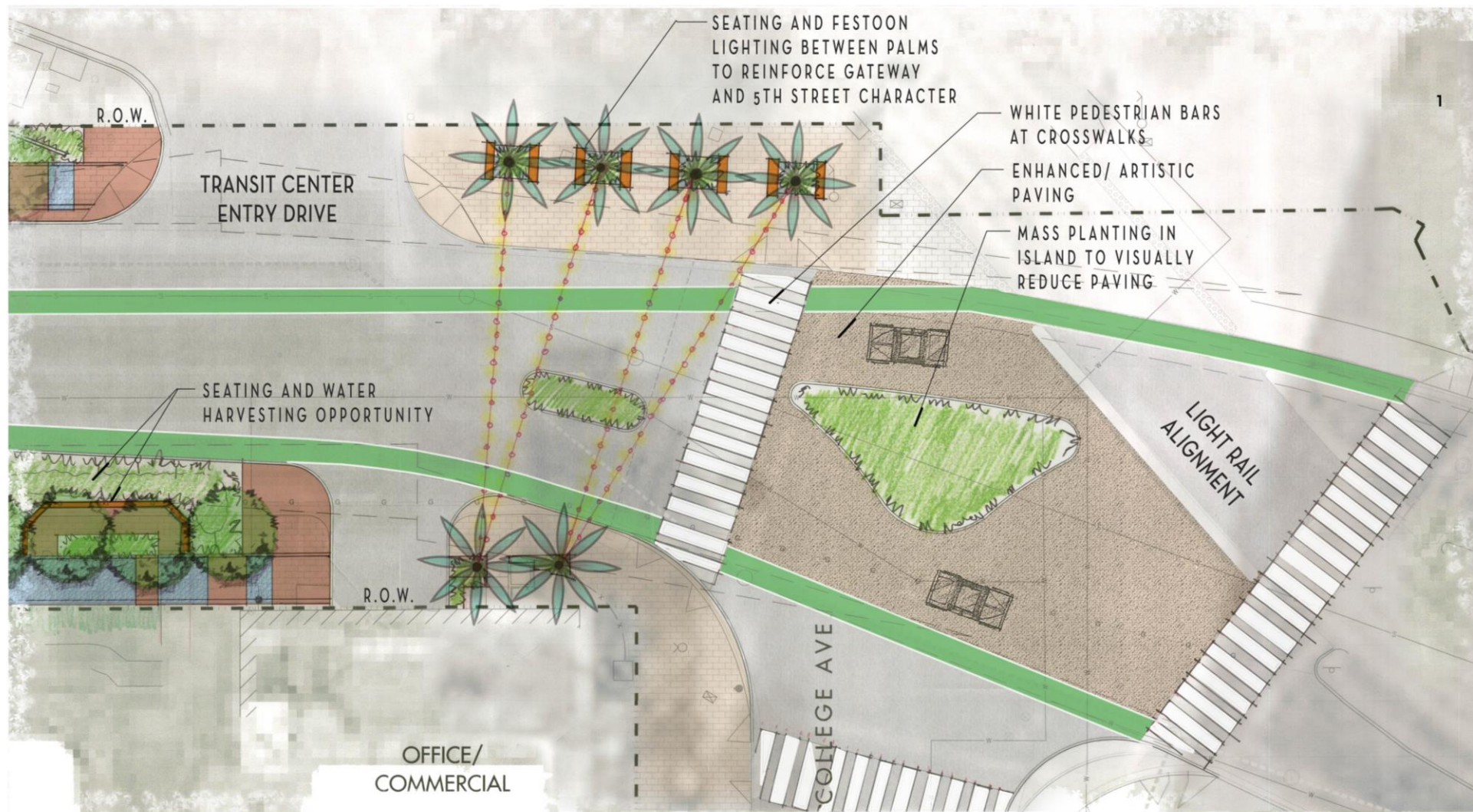

Design Treatment Examples



Next Steps

- **Spring 2017**
 - Public Meeting #2 - Review Preferred Concept
 - Boards & Commissions
 - City Council Direction
- **Summer 2017 / Fall 2017**
 - Council IRS update
 - Prepare final Construction Documents
 - Develop phases, temporary & permanent solutions



Questions / Contact

www.tempe.gov/5thStreet



Project Manager : Eric Iwersen | 480-350-8810 | eric_iwersen@tempe.gov
Transportation Planner: Tony Belleau | 480-858-2071 | tony_belleau@tempe.gov