

# 5<sup>th</sup> Street

## *Streetscape & Traffic Calming Project*

Project Update | Spring 2017



# Project Limits & Context



- Approximately ½ mile (2,900 ft)
- Connects City Hall, Mill Ave, ASU, Sun Devil Stadium, police admin and courts, Transportation Center, lightrail, transit services, mixed-use development, multi-family housing, hotels, Hayden Butte/A Mountain, historic and redeveloping neighborhoods

# Design Goals

- Increase **on-street parking** opportunities and associated revenues
- Enhance **multi-modalism** (improve bike, ped, transit & ADA)
- Utilize **innovative transportation design** (NACTO)
- Maintain vehicular & **special event** access & integrate **traffic calming**
- Expand & improve **landscape & shade** options, particularly tree coverage
- Address **heat island & user comfort**, utilize **Low Impact Development** techniques where appropriate (water harvesting, solar)
- Preserve **utility operations** and allow for future growth
- Balance **design with cost control & long term maintenance**
- Connect to **neighborhoods**, protect & create **gateways/transitions**
- Create innovative, sustainable, iconic street with **mobility for all**

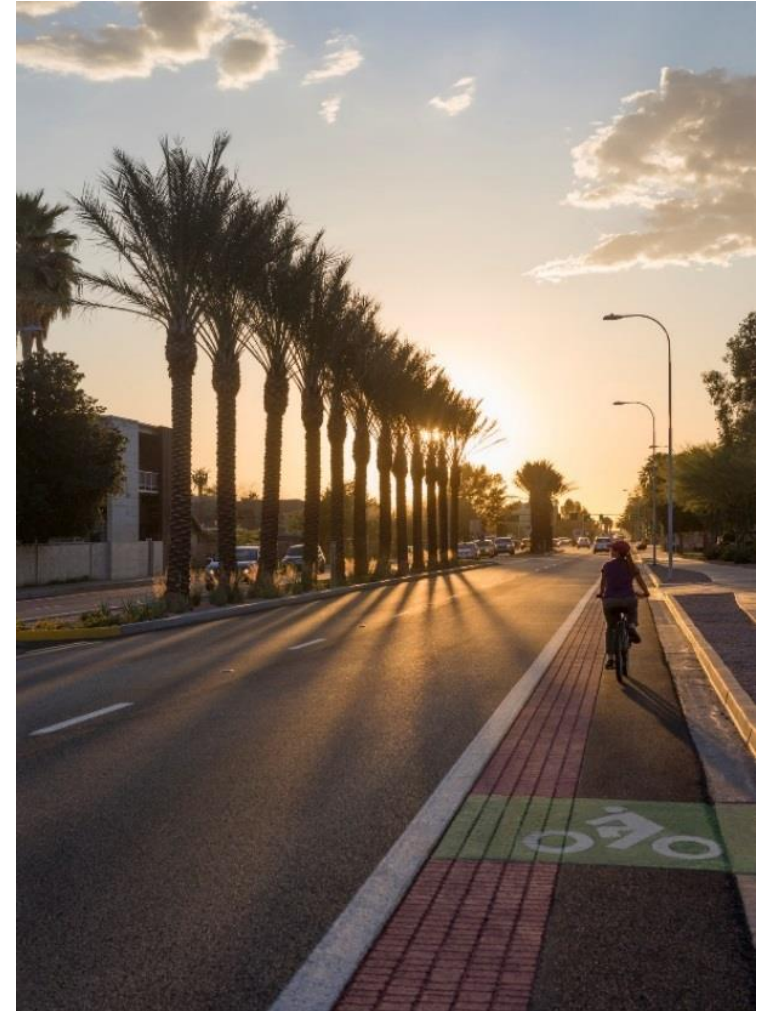

# Preliminary Concepts

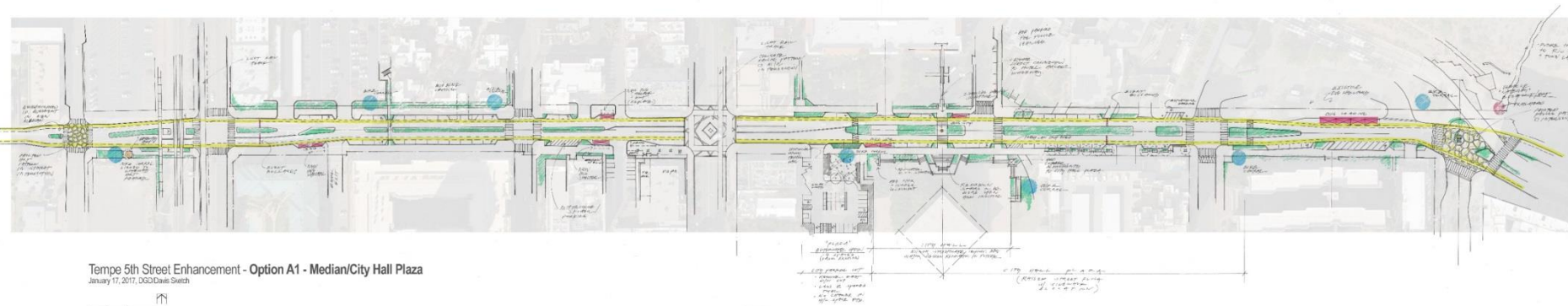

## *Median/City Hall Plaza*

Wide street, landscaped,  
parallel parking

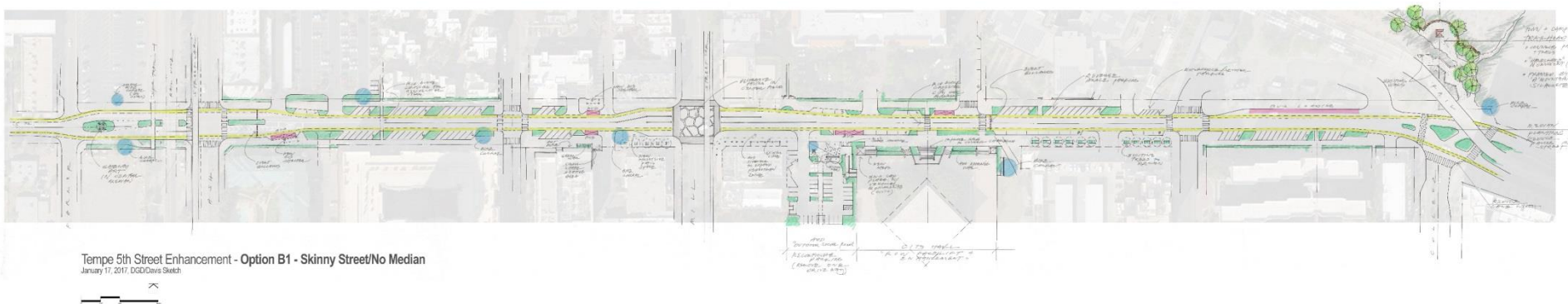

## *Skinny Street/No Median*

Skinny street, bikes have a  
more straight and visible path



## *Skinny Street/ Seperated Bike Lane*

Skinny street, bikes meander  
behind parking stalls and  
through intersections

# Stakeholder Input

- Public Meeting (Oct. 2016)
- Commissions
  - Transportation, Sustainability, Historic Preservation, Mayor's Commission on Disability Concerns, Municipal Arts, Parks
- Departments/Divisions
  - Police, Fire, Solid Waste, Utilities, Community Development
- Community
  - ASU, SRP, Mission Palms, DTA, Farmer Arts District, Studio 5c, Businesses and Property Owners

## Highlights & Takeaways

- Recognize gateway / neighborhood / historical transitions
- Increase street parking, but not at the expense of good people space
- Maintain capacity but slow traffic
- Expand pedestrian space on sidewalk for patio overflow
- Capture water runoff, utilize in landscape features
- Increase Shade through trees and structures
- Date Palms are significant to the region
- Provide a flexible street for daily use as well as event/gathering opportunities
- Enhance bike and pedestrian visibility
- Utilize streetscape for art opportunities, both seasonal and permanent
- Extended sidewalks for public space and shorter intersection crossings

# Stakeholder Input

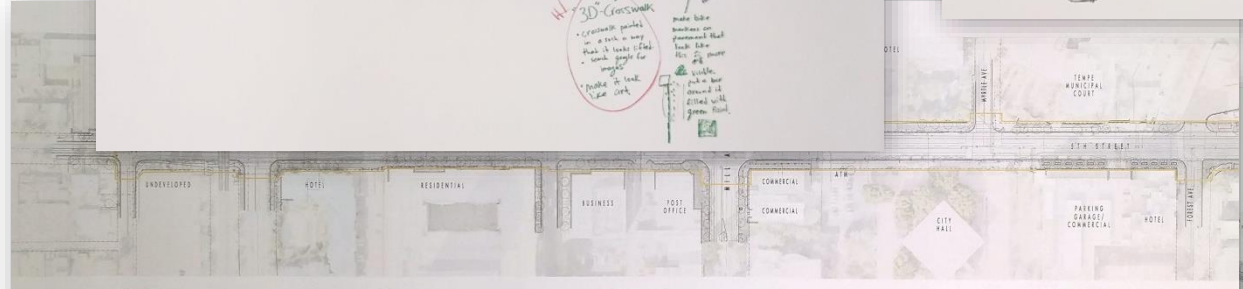
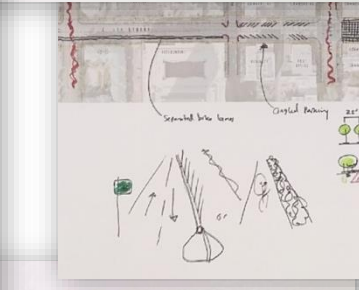
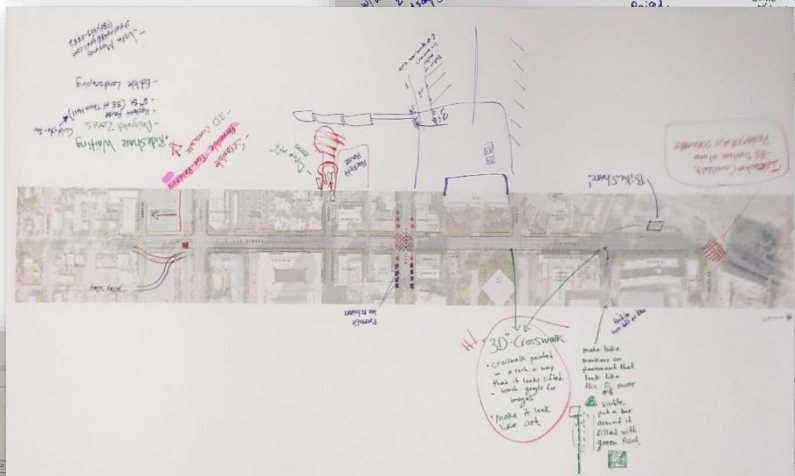
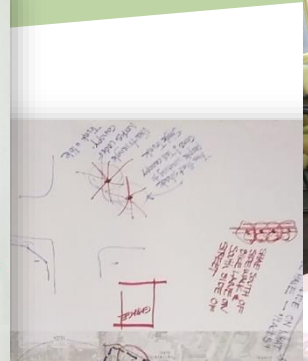
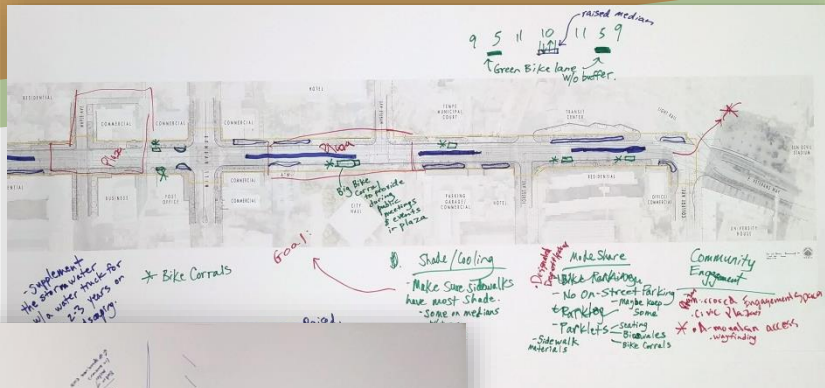

- WATER**
  - CAPTURE RUNOFF TO REDUCE PAVEMENT WATER USE AND PROMOTE A HEALTHY, NATIVE PLANT SPECIES.
  - USE RUNOFF TO WATER SHADE AND COOLING STRATEGIES
- SHADE COOLING**
  - PLANT A VARIETY OF NATIVE, DROUGHT-TOLERANT PLANTS TO PROVIDE CANOPY TO 25% USING NATIVE SPECIES, ETC.
  - CHOOSE PLANTS THAT CAN BE SPANNED FROM RUNOFF
  - REMOVE MULCH, ETC.
- MODE SHARE**
  - INCREASE MODE SHARE BY:
    - ↳ ↑ VISIBILITY
    - ↳ ↑ CONVENIENCE FOR ACT. TRAVELERS
    - ↳ ↑ SAFETY AND PERCEPTION
    - ↳ ↑ SHOW PEOPLE DOWN BY CREATING FEEL OF A MULTI-USE STREET
- COMMUNITY**
  - FOSTER AN ADAPTIVE AND FLEXIBLE STREET THAT SUPPORTS AND REFLECTS THE CHARACTER AND DESIRES OF THE COMMUNITY AND PURPOSE OF THE STREET.
  - AUTO BALANCE
  - PLATFORM FOR CHEAPEST ART
- ENERGY**
  - SELF-IRRIGATING
  - SOLAR COOLED BUS STOPS
  - STREET LIGHTS
  - ENERGY HARVESTING SYSTEMS



Community planning charrette at ASU School of Sustainability

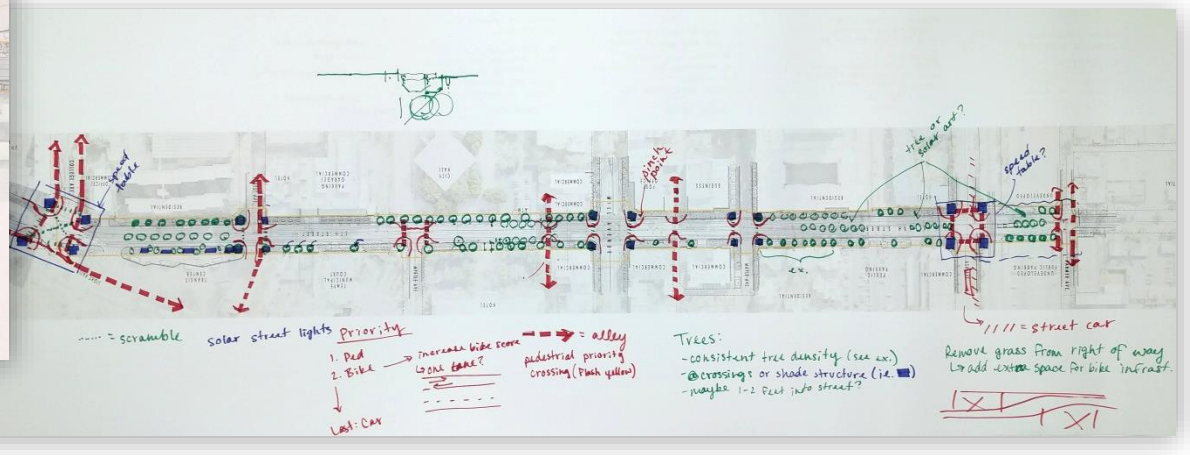

# Preferred Concept

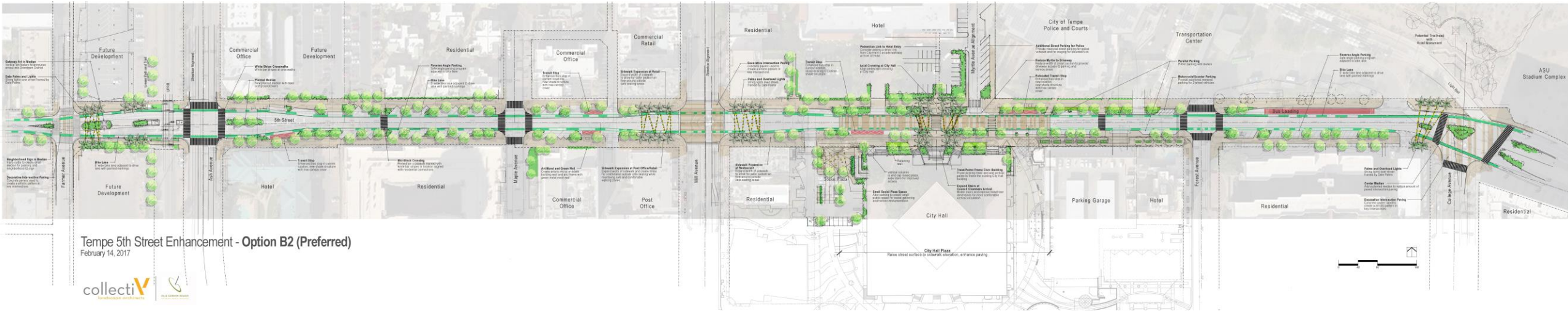

Tempe 5th Street Enhancement - Option B2 (Preferred)  
February 14, 2017



## Balanced Street Approach

Focus on supporting an active street that provides for all modes of travel, encouraging engagement, recognizing landmarks and gateways, designed to be sustainable.

Parking increase from 38 to  $\pm 77$  metered stalls / Thinner street with more pedestrian-friendly crossings / Continuous, punctuated bike lanes / Introduce “City Hall Plaza” / Consistent lighting strategy / Increased shade and landscaping throughout / Decorative, permeable paving / Gateway treatments to buffer transitions

# Walkthrough : Farmer & Ash

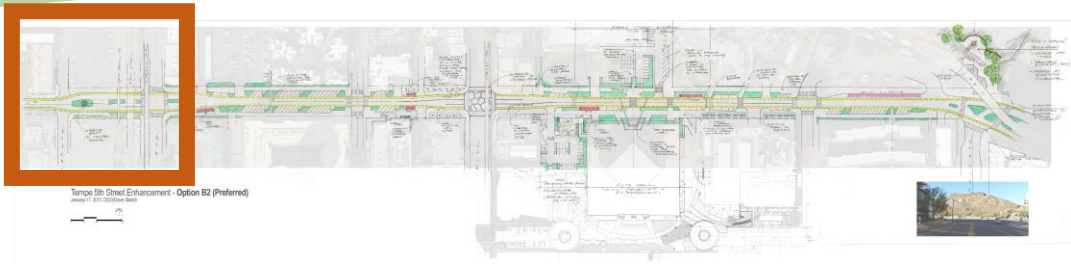

- Neighborhood Transition
- Median Gateway Feature
- Enhanced Street Legibility
- Preserves utility and railroad operations
- Introduces date palms and festooned lighting treatment

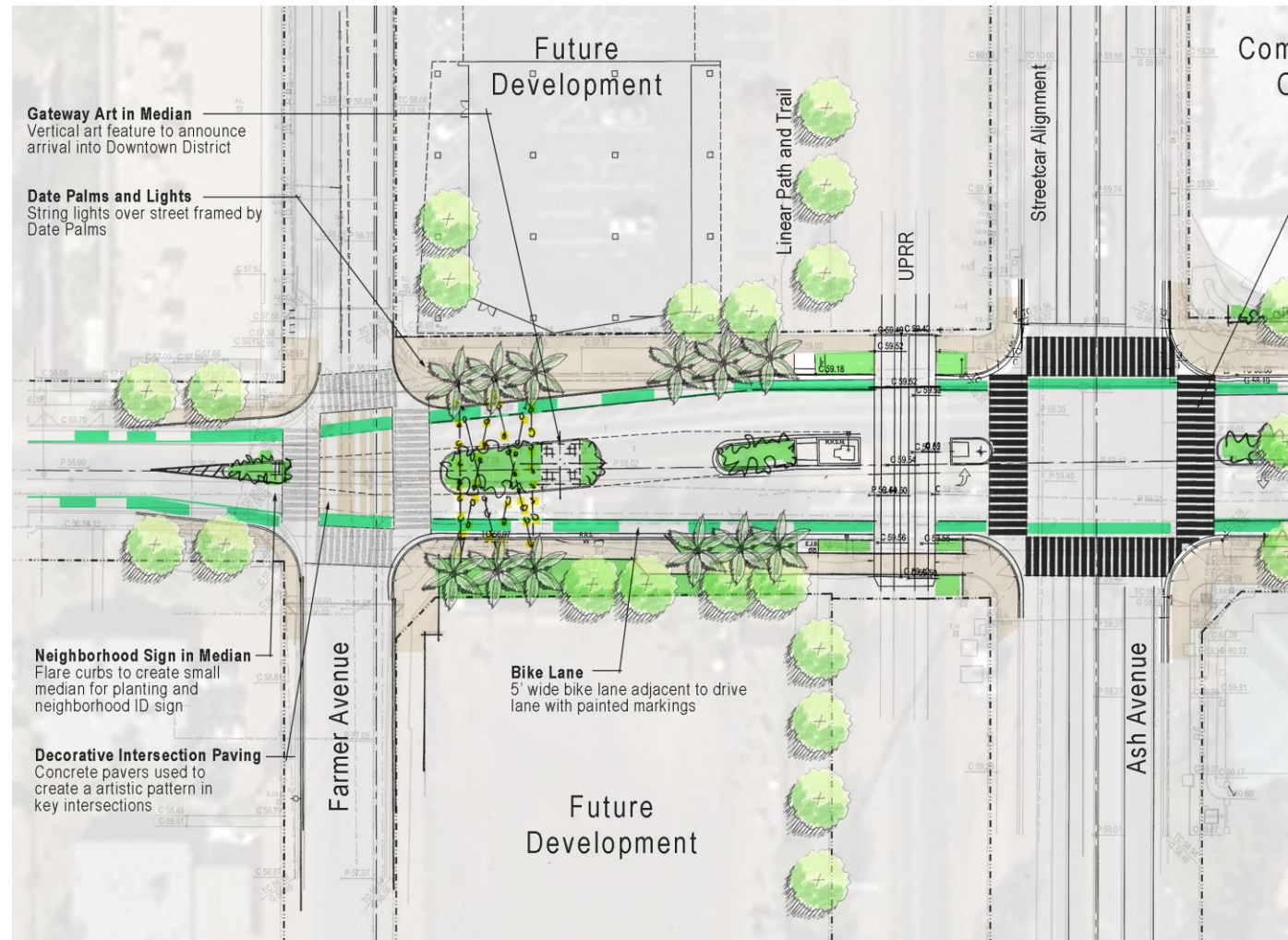



# Walkthrough : Ash to Maple

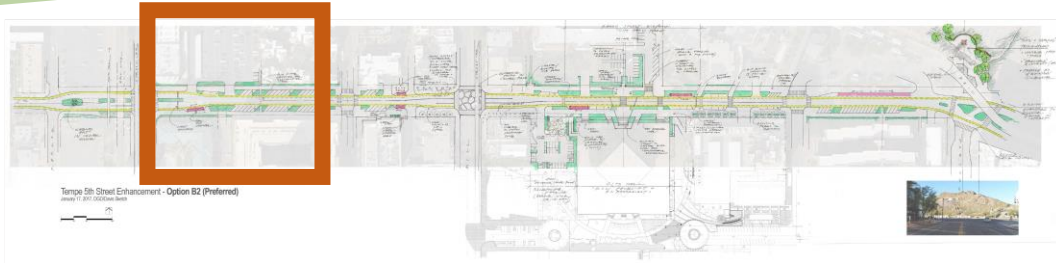

- Introduction of reverse-in angled parking
- Street narrows
- Landscape and shade enhancements

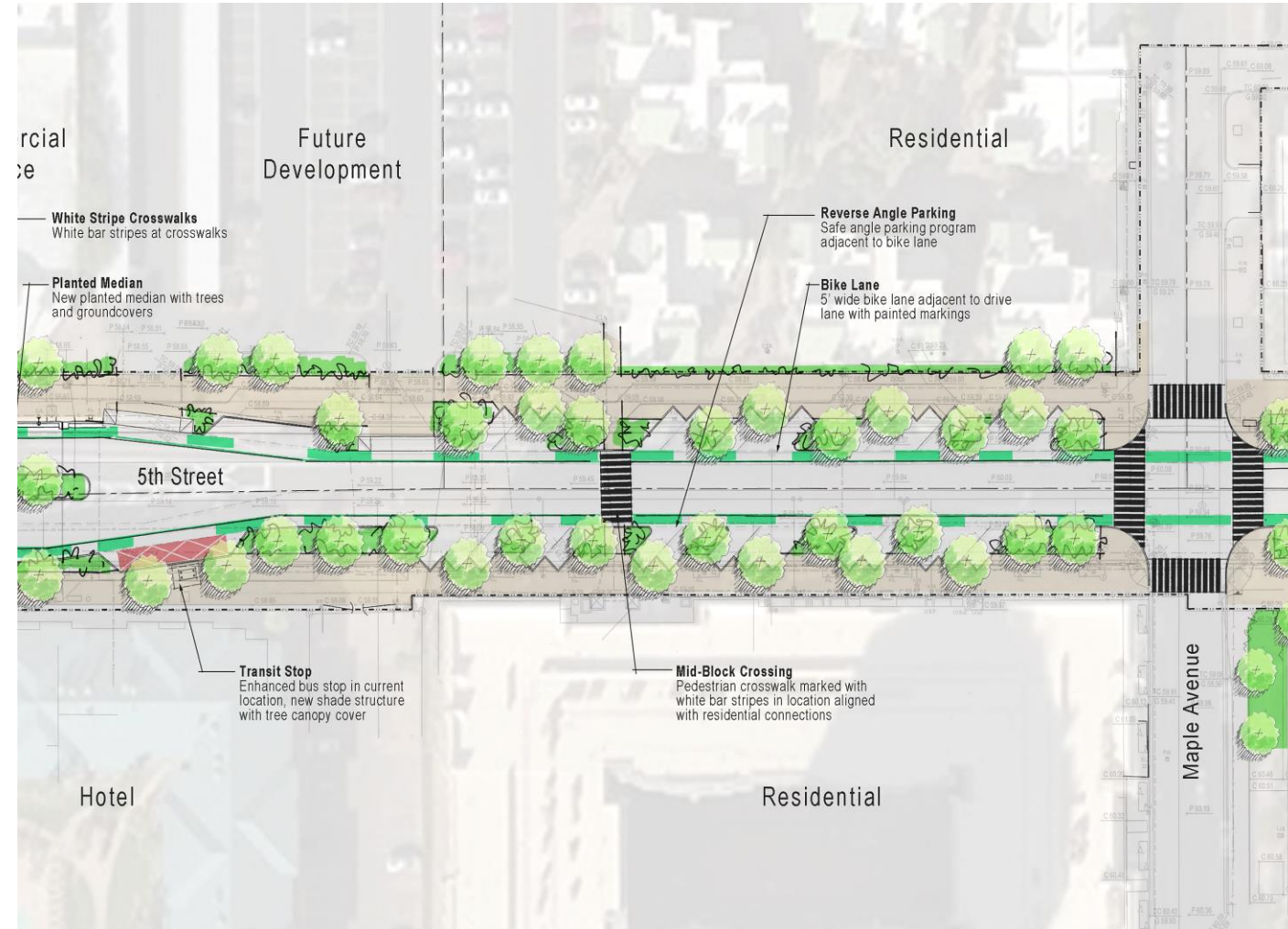

# Reverse-in Angled Parking

- Achieves narrowing of street to slow traffic
- Head-out movement enhances line-of-sight visibility for oncoming cyclists, vehicles
- Provides runoff capture and landscaping opportunities
- Geometry allows for additional parking spaces



# Walkthrough : Mill Ave

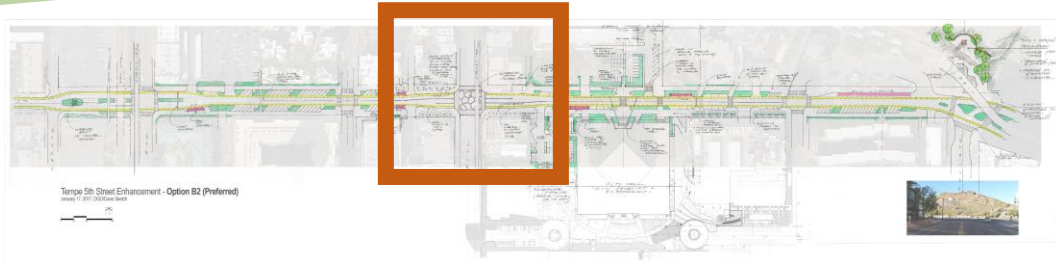

- Extended sidewalks for engaged public space
- Intersection accommodates left turns
- Decorative, functional paving

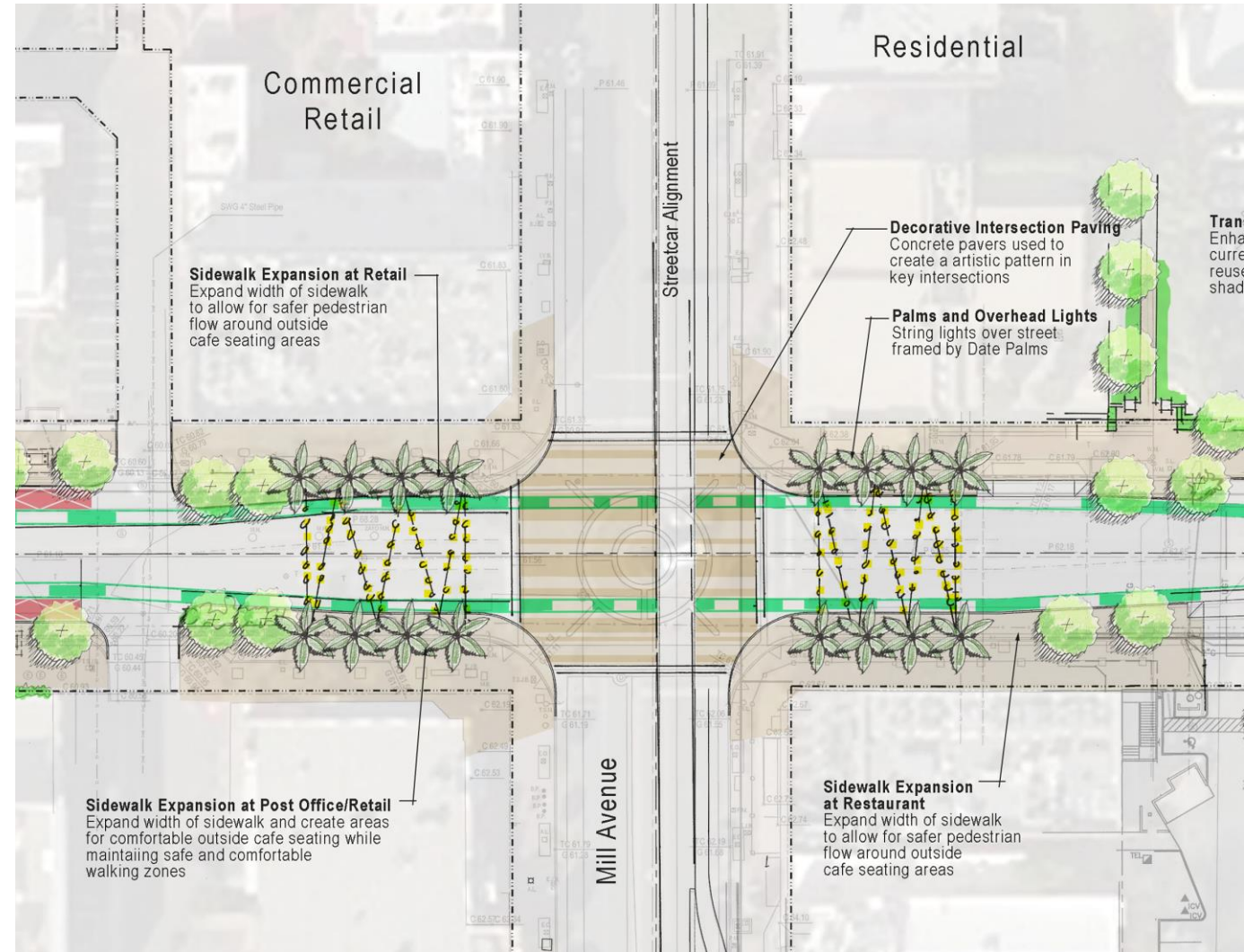
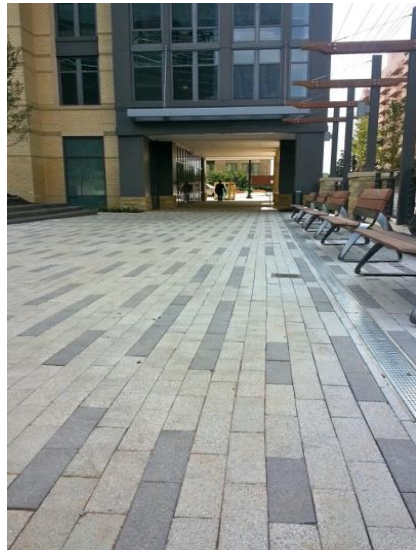

# Walkthrough : Mill Ave (Detail)

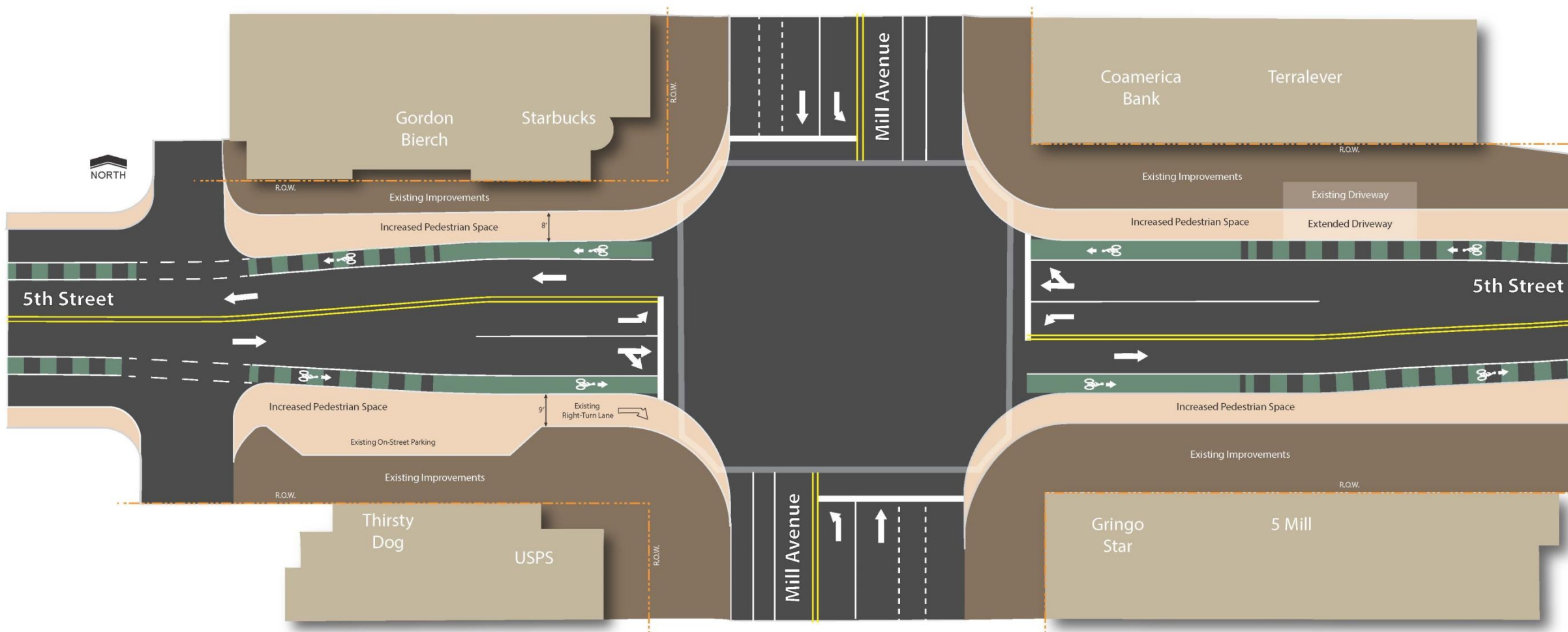

# Walkthrough : City Hall Plaza

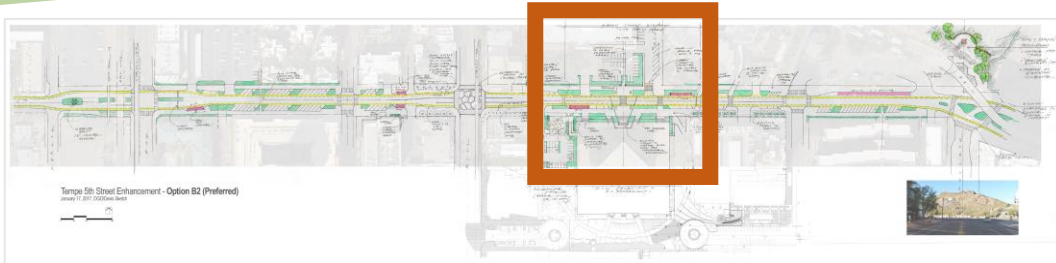

- Elevated street
- Celebrates the civic landmark
- Extends spirit of City Hall into the public realm
- Social plaza softens edges
- Cascading landscape treatment
- Re-aligned crossing from Mission Palms Hotel
- Myrtle Avenue reconfigured as a driveway, provides additional parking for Police
- Bollards in street for special events

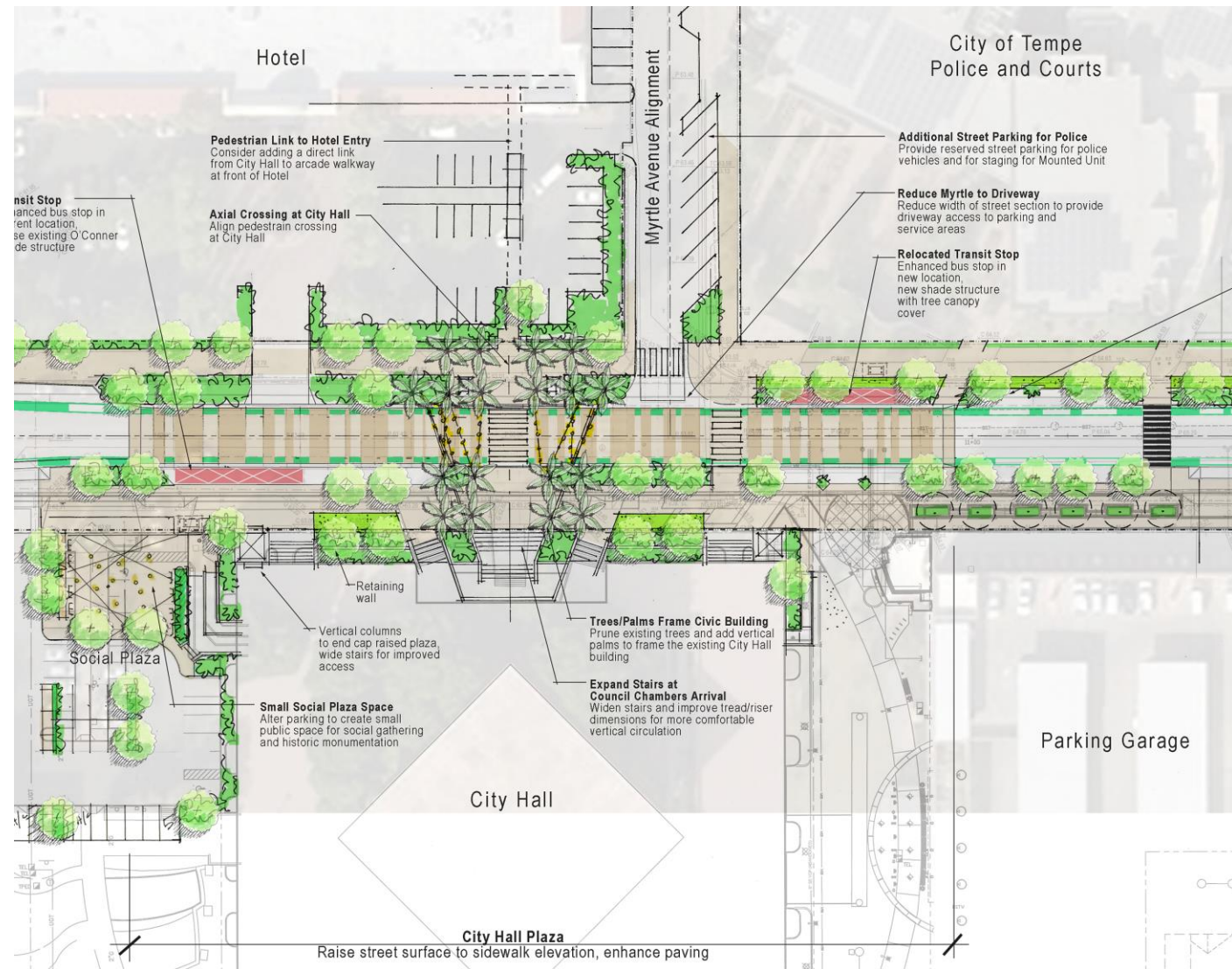

# Walkthrough : City Hall Plaza (Detail)

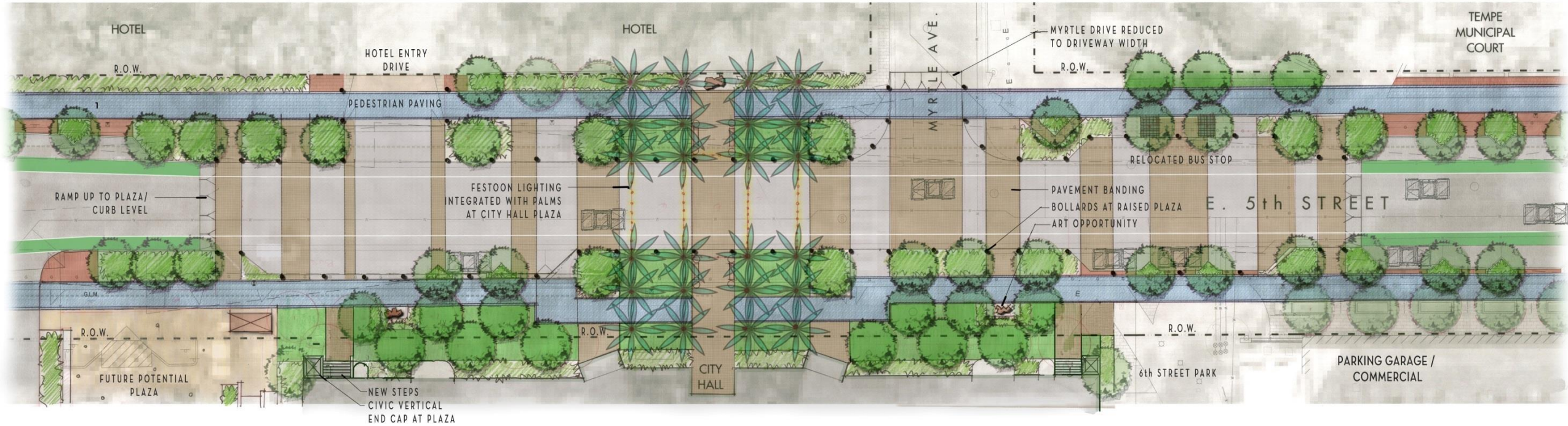

# Walkthrough : College Ave

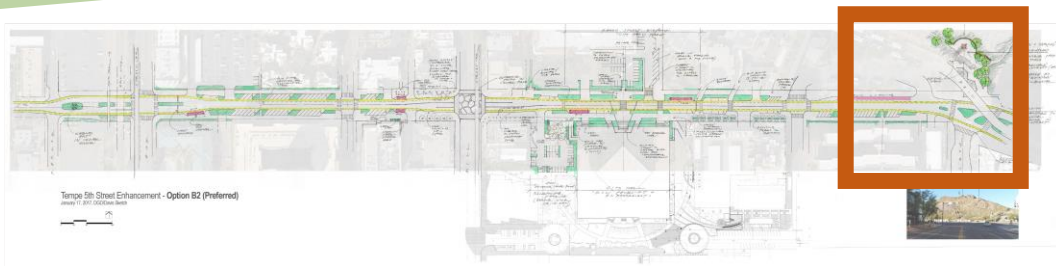

- Town & Campus gateway
- Median treatment to frame Hayden Butte
- Trailhead enhancement
- Curb extends to shorten crossing distances

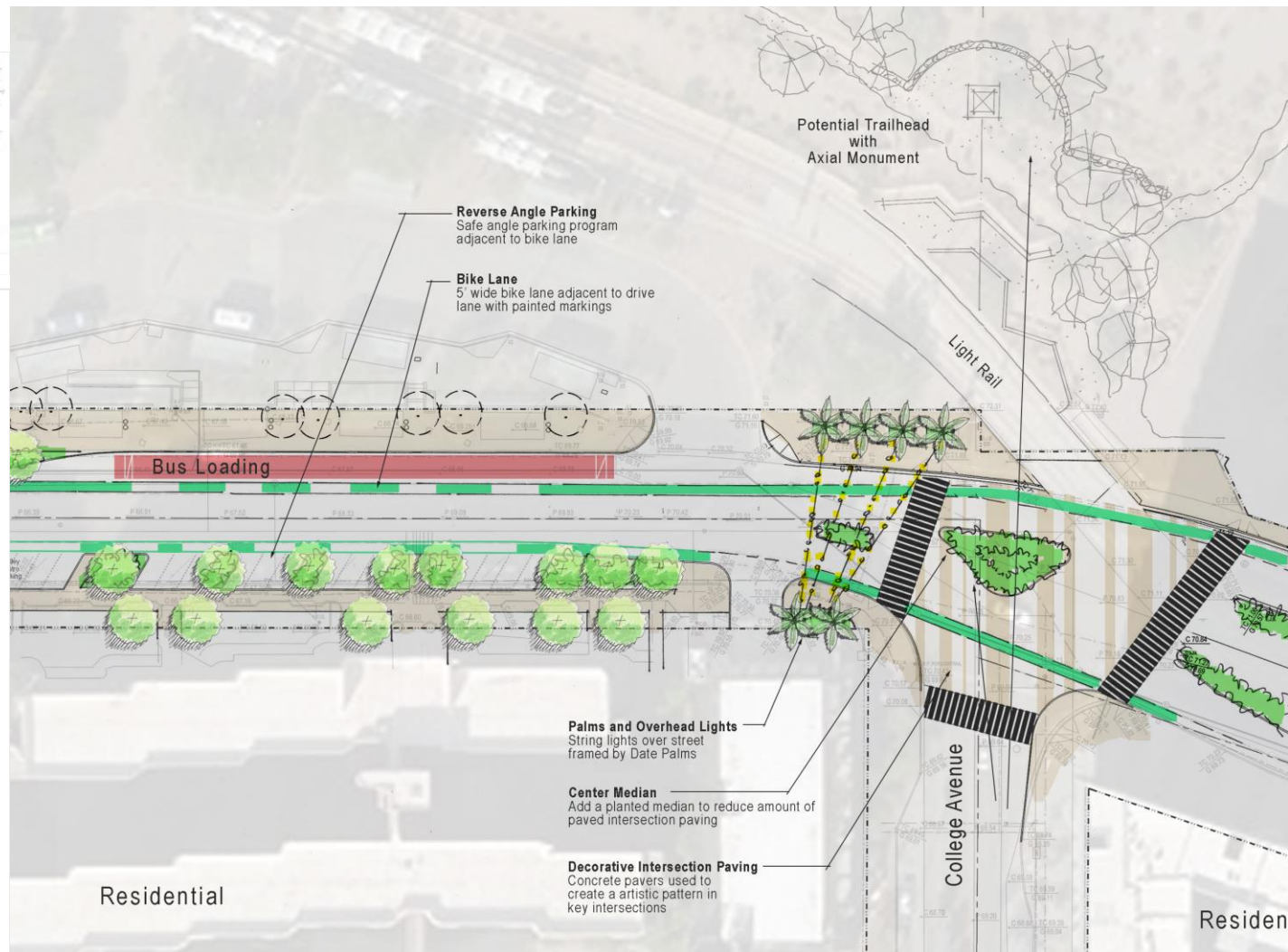

# Walkthrough : College Ave (Detail)

- Town & Campus concept
- Median treatment to frame Hayden Butte
- Trailhead enhancement
- Curb extends to shorten crossing distances

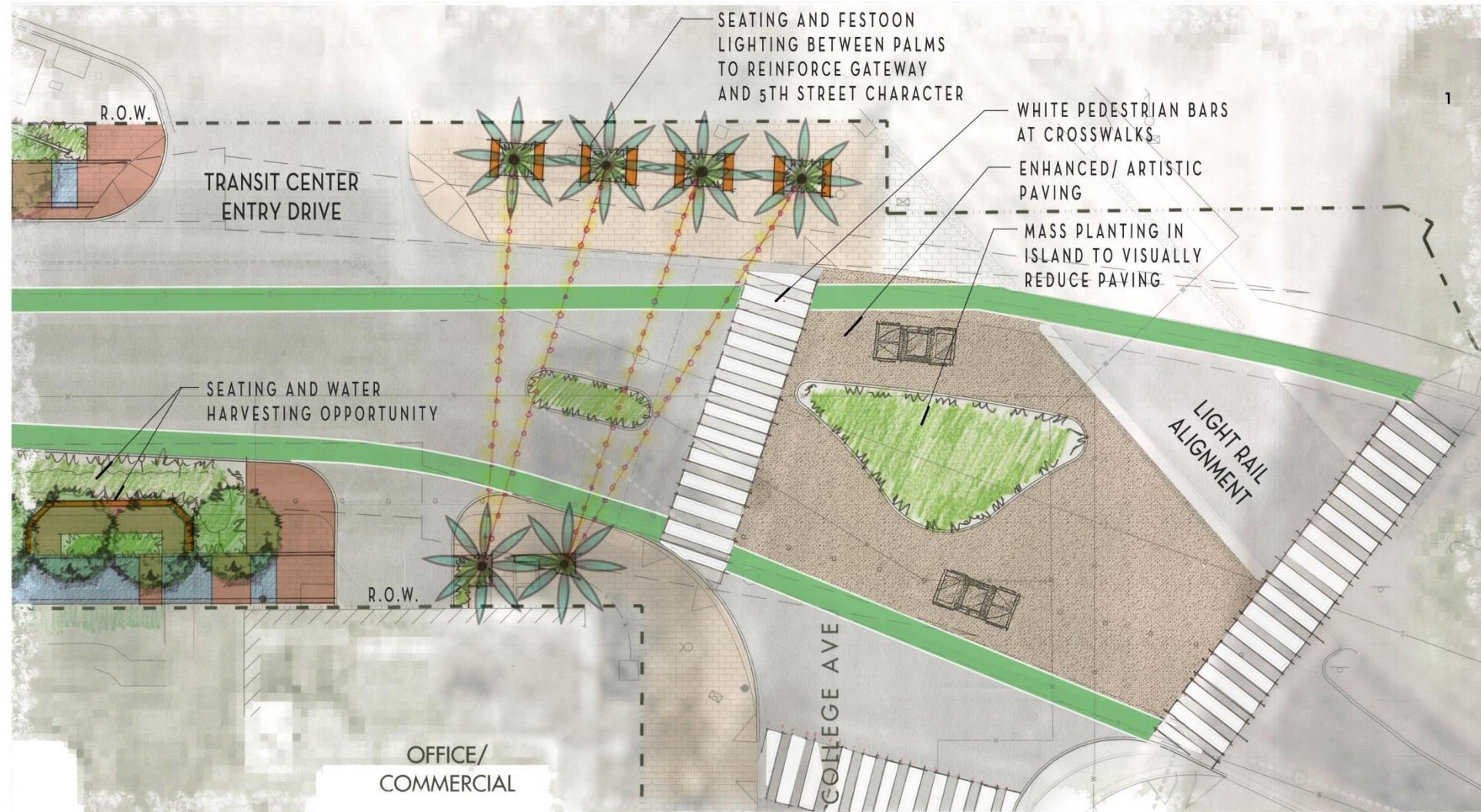



# Design Treatment Examples

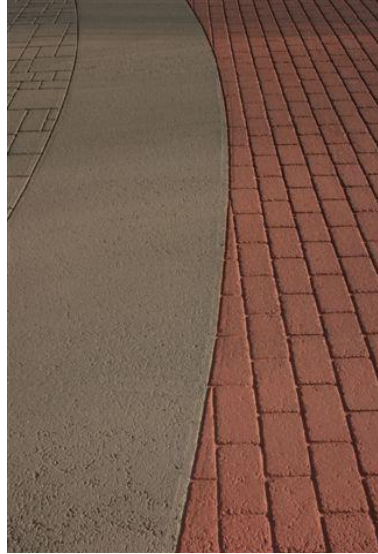

# Next Steps

- **Spring 2017**
  - Public Meeting #2 - Review Preferred Concept
    - Boards & Commissions
    - City Council Direction
- **Summer 2017 / Fall 2017**
  - Council IRS update
    - Prepare final Construction Documents
- Develop phases, temporary & permanent solutions



# Questions / Contact

[www.tempe.gov/5thStreet](http://www.tempe.gov/5thStreet)



Project Manager : Eric Iwersen | 480-350-8810 | [eric\\_iwersen@tempe.gov](mailto:eric_iwersen@tempe.gov)  
Transportation Planner: Tony Belleau | 480-858-2071 | [tony\\_belleau@tempe.gov](mailto:tony_belleau@tempe.gov)