



## PUBLIC INPUT SUMMARY

### Overview

Comments were collected online from October 31, 2017 - November 19, 2017. Residents in the area South of Guadalupe, West of Kyrene, North of Divot Dr and East of the Highland Canal (586 households) were invited to participate in the process via postcard. Notices were also posted on Nextdoor directing residents to the website. Twenty-four residents responded to the survey online.

The proposed designs included different placements of the ramada and residents were asked to provide comments on the location as well as the style and materials for the columns.

### Map of Survey Respondents

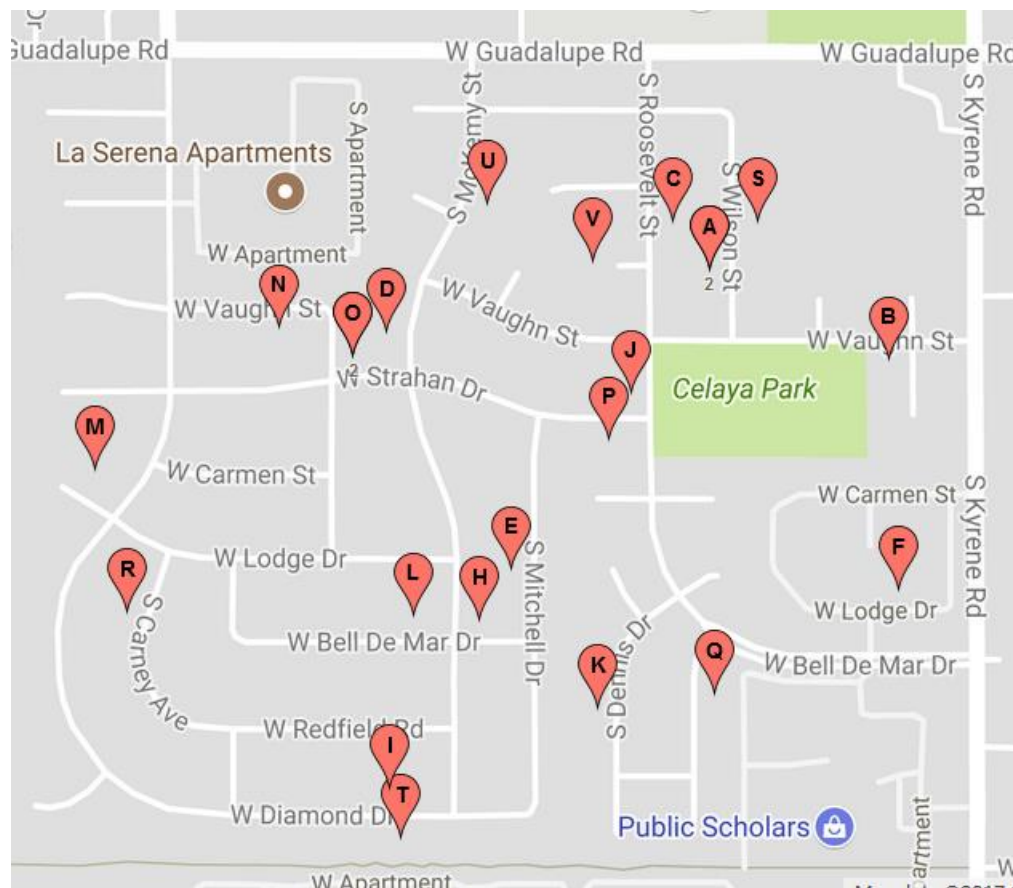

# Survey Responses

## 1. Which ramada location do you prefer?

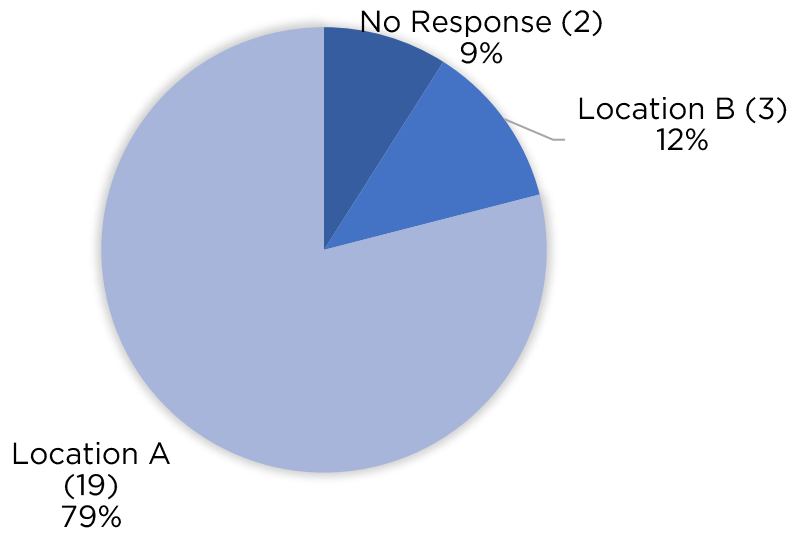
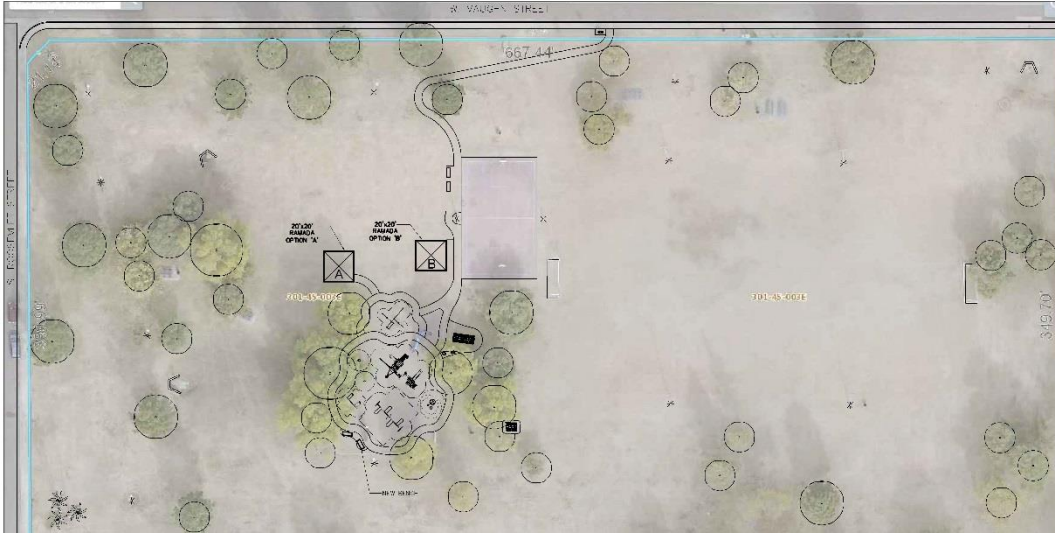

## 2. Which ramada column material do you prefer?

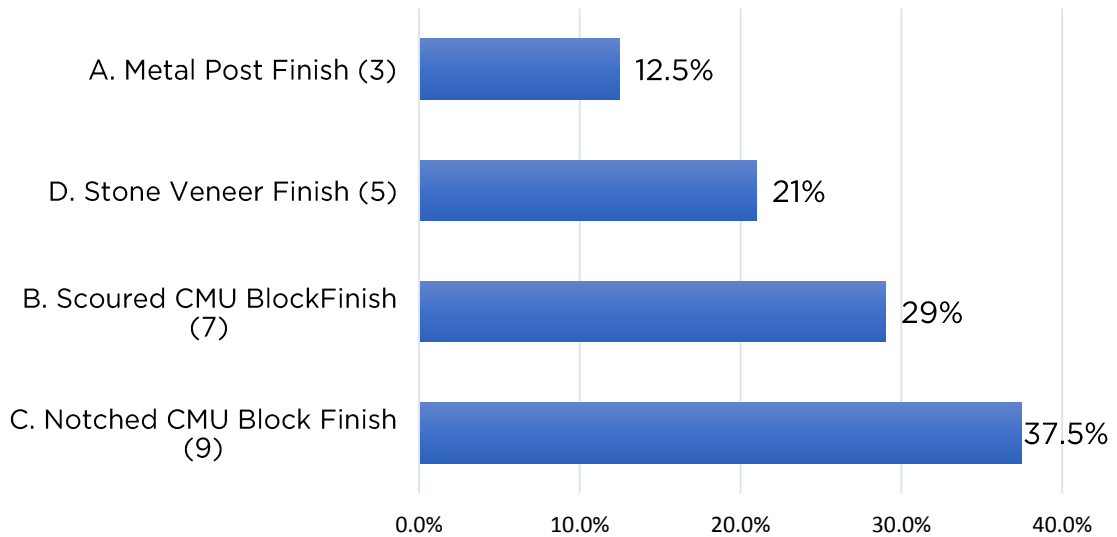

### 3. Additional comments:

1. Nice to see the plans are progressing.
2. Hi, we recently moved to this neighborhood by the park. Is there a way to see what is planned for next year with the park renovation? Thank you!
3. It's hard to decide on the ramada column material unless we know exactly how it would match the new play equipment.
4. I chose Option B because it would match the current building materials (of the houses) in the area, but if the new park equipment will be more modern, then I would want the ramada to match it instead of the houses in the area.
5. Larger would be better.
6. As you can see by my address, my house is right on the west side of the park, overlooking both the playground and the proposed ramada locations. I use the park frequently. My reason for choosing location A over location B stems from the fact that location A brings the ramada into a better alignment between the existing picnic space and the playground, rather than having the ramada essentially just be an extension of the basketball court. Not only do I use all of the park facilities, but over the last 14 years I have observed the use patterns of the various attractions of the park, and the frequency with which families with children picnic at the tables, and have their children play on the playground equipment at the same time, makes me believe that those families would be best served with a ramada location in closer proximity to the play area. I find both ramada styles C and D to be modern, friendly, and aesthetically pleasing. I selected C due to a slight preference for the slightly more Southwestern color scheme, but I would not mind seeing D every day either.
7. The playground at the Tempe Lions Park is fabulous - anything close to that would be wonderful. And keeping the Ramada close to Roosevelt St is the best choice. Thanks for asking!
8. Be aware that during the rainy seasons, Section A area tends to be underwater. Also, please incorporate solar panels, outdoor fan, or misting system as part of the ramada
9. Could we possibly get recycle barrels.
10. Metal post finish appears to offer more open space. We have lived in the neighborhood where Celaya Park is for almost 8 years. I love how the playground equipment is almost fully shaded by trees - even in the summer time. We are looking forward to the improvements. We use the park quite regularly. It will be nice to have better lighting there as drug addicts/dealers and other criminals like to use the park for their criminal activities because it's so dark there.
11. The metal option for column material was a very close second choice.
12. I chose location ""A"" as I feel that location ""B"" is just too close to the basketball court. There is too much of a possibility of being hit by a loose basketball. I chose ramada column ""B"" as it blends with the current materials used on the homes in the Tempe Royal Estates development. Additionally, the columns are thin and it would be harder for someone to hide behind them given the recent uptick in criminal activity. "
13. Please consider adding solar, misting, and an outdoor.