

# Transit Program Update

## Transit Shelter Update

Tempe City Council  
November 17, 2021



# Transit Shelter Update



- Four Sizes
- Stakeholder-inspired designs
  - Improves shade coverage
  - Increases seating
- Adaptable to multiple locations
  - 777 bus stops citywide
  - 310 existing shelters
  - 467 stops without shelters
  - Many with limited ROW
- Sustainable Design
  - Collaboration w ASU & 3M Corp
  - Solar power
  - Recyclability

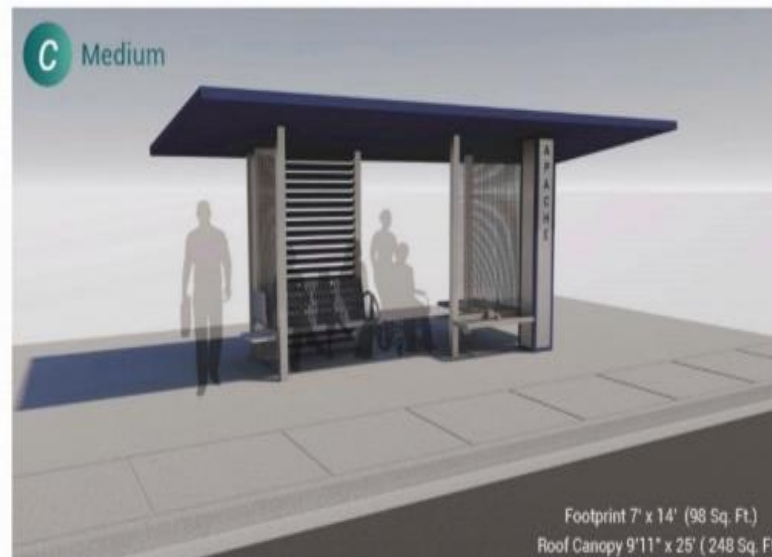



# Transit Shelter Update



## Next Steps:

### Prioritization of new shelter locations

- Transit Ridership
- Transit Propensity
- Heat Vulnerability

### Costs

- Existing shelters: \$23,300 - \$30,300
- New shelters (90% estimate): \$13,800 - \$45,200
- Full new install (467 stops): approximately \$11.3M

### Installations

- 24 – 39 shelters/year (estimate)
- Years to complete: 12 - 19
- Beginning Summer/Fall 2022



custom flip down seat



small shelter